

INSTALLATION INSTRUCTIONS

TEAMWORX

INSTALLING A WORKSURFACE OVER A CARGO HUB

PURPOSE: TO PREVENT WORKSURFACE FROM SLIPPING OFF CARGO HUB

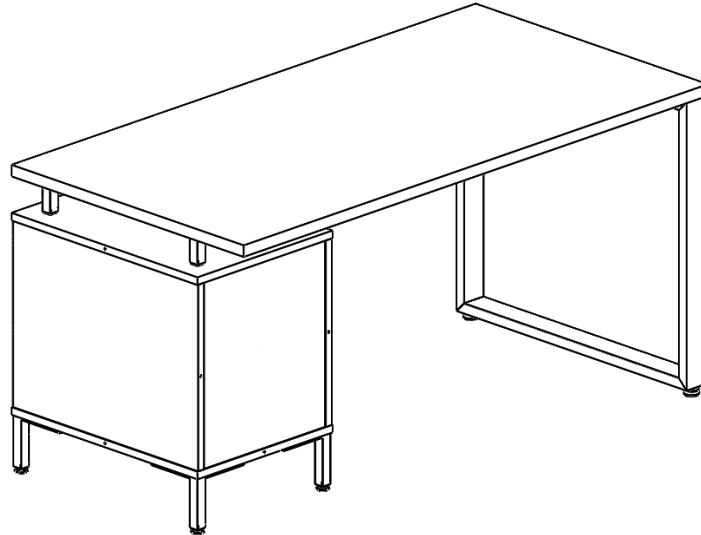

ASSEMBLY OVERVIEW

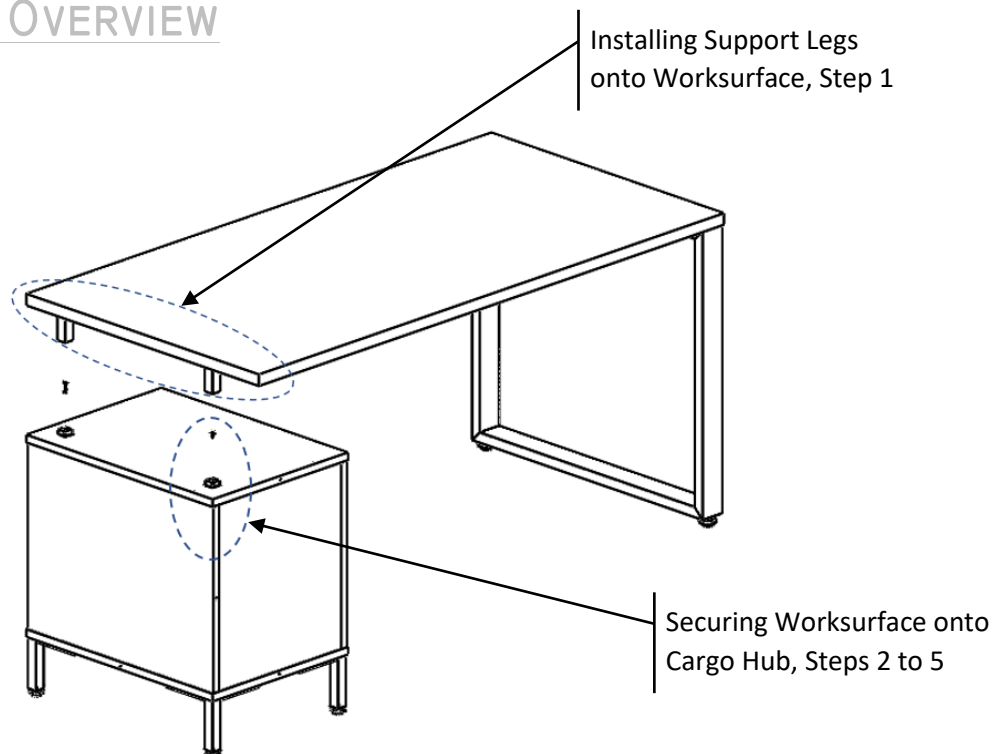

INSTALLATION INSTRUCTIONS

INSTALL THE 3-3/8" SUPPORT LEG ON WORKSURFACE AS SHOWN.

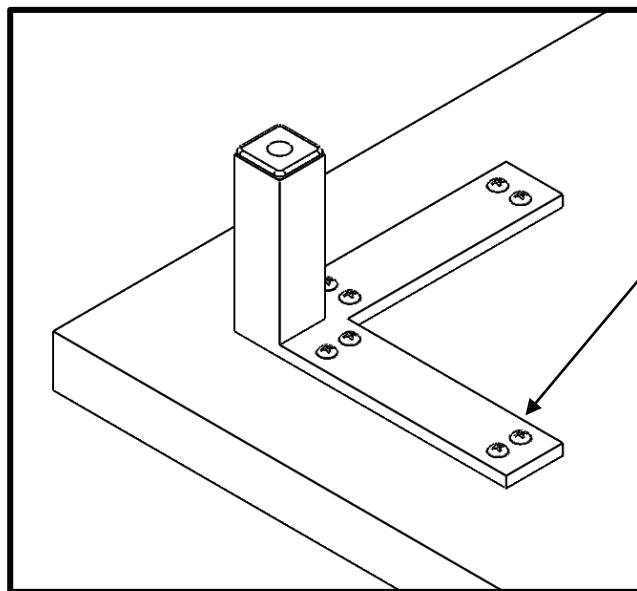
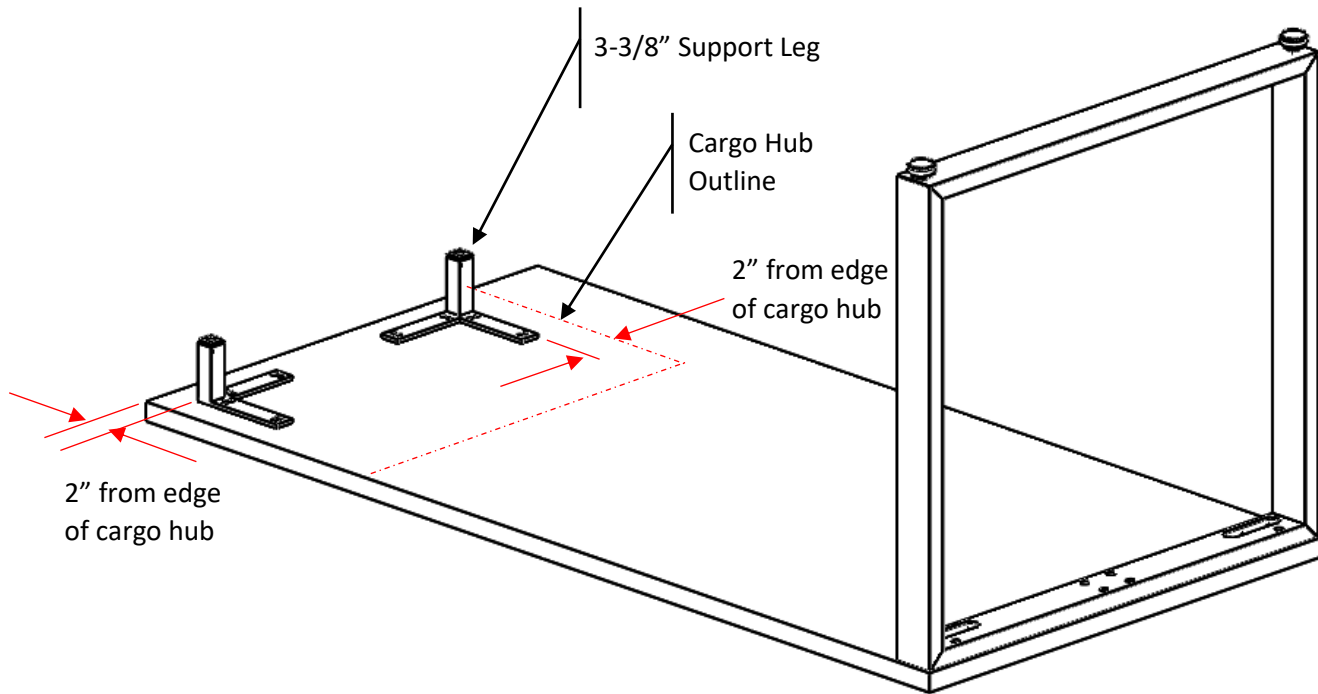

Secure with #8 x 3/4" Long Panhead Screws

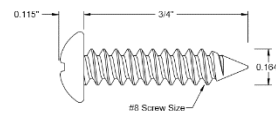

x8 per support leg

INSTALLATION INSTRUCTIONS

2 GENTLY POSITION THE WORKSURFACE OVER THE CARGO HUB AND MARK LOCATION OF SUPPORT LEGS AS SHOWN.

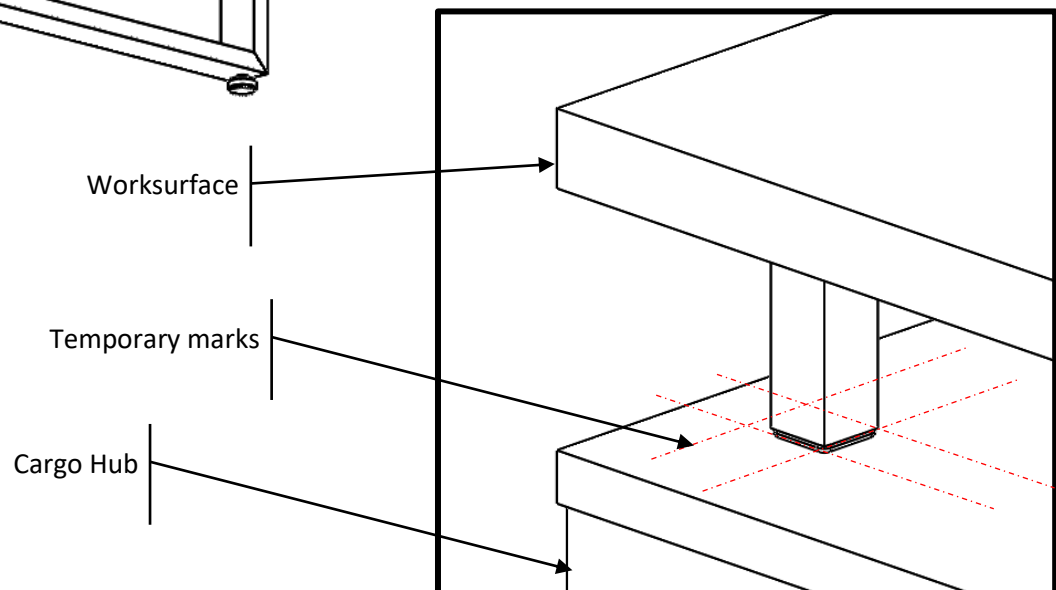
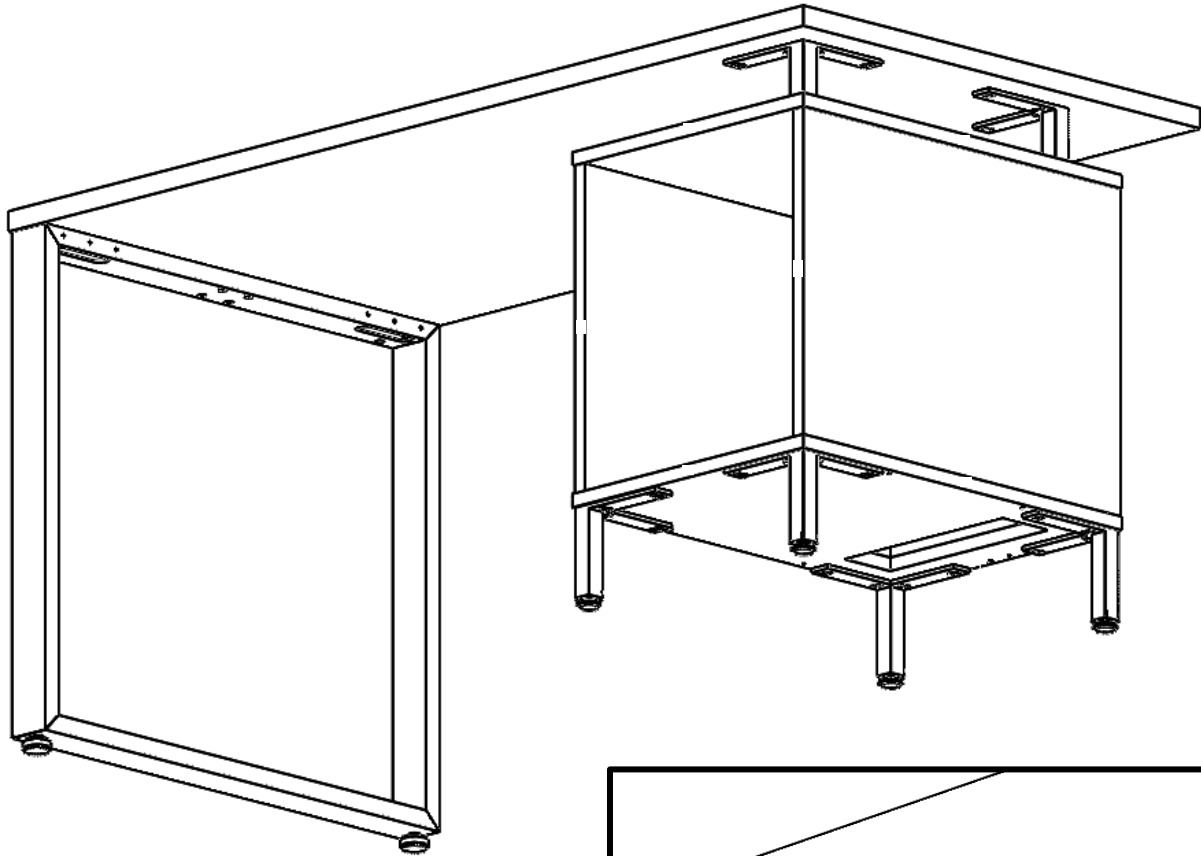

INSTALLATION INSTRUCTIONS

- 3 REMOVING SUPPORT LEG END CAP:**
CAP:
USING THE 5/16" x 8" LONG BOLT PROVIDED, SCREW BOLT INTO CAP AND PULL-OUT BY WIGGLING IT DOWN.

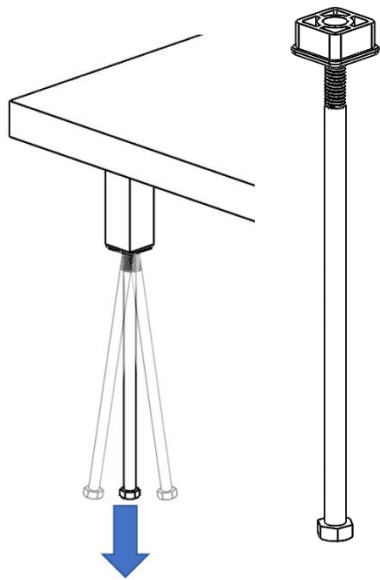

- 4 POSITION PLASTIC END CAPS ONTO THE TEMPORARY MARKED LINES ON THE CARGO HUB. WITH A #10 x 1" LONG PANHEAD SCREW, SECURE THE CAPS IN PLACE.**

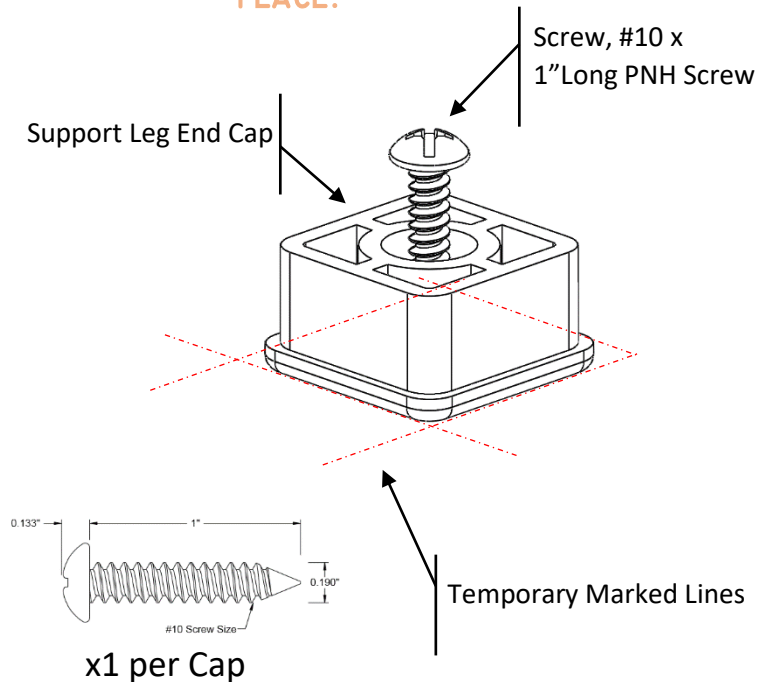

- 5 GENTLY PLACE THE WORKSURFACE OVER THE SECURED END CAPS.**

