



ReFit

PRICE & SPECIFICATION GUIDE

Version: 03.15.24
prices effective April 1, 2024

DeskMakers

revisions

08/18/20	Modified model numbers on laminate base side screens and reduced the price of the Laminate Lean divider panels. Lean divider panels were redesigned.
01/01/21	Updated finishes.
02/19/21	Updated 1/4" acrylic pricing.
09/01/21	Updated finishes
12/20/21	Updated pricing and finishes
03/31/22	Updated option codes
08/18/22	Added surcharge note
12/01/22	Updated pricing
10/18/23	Updated finishes
03/15/24	Updated pricing

table of contents

Laminates	4-5
Laminate Base Acrylic Screens	6-9
Mounting Hardware	10-12
Acrylic Panels	13-37
Glass Panels	38-51
Laminate Panels	52-72
Options	73
Lean Dividers	74-75
Terms and conditions	76
Warranty	77

laminate finishes

standard thermofuse laminate (TFL)

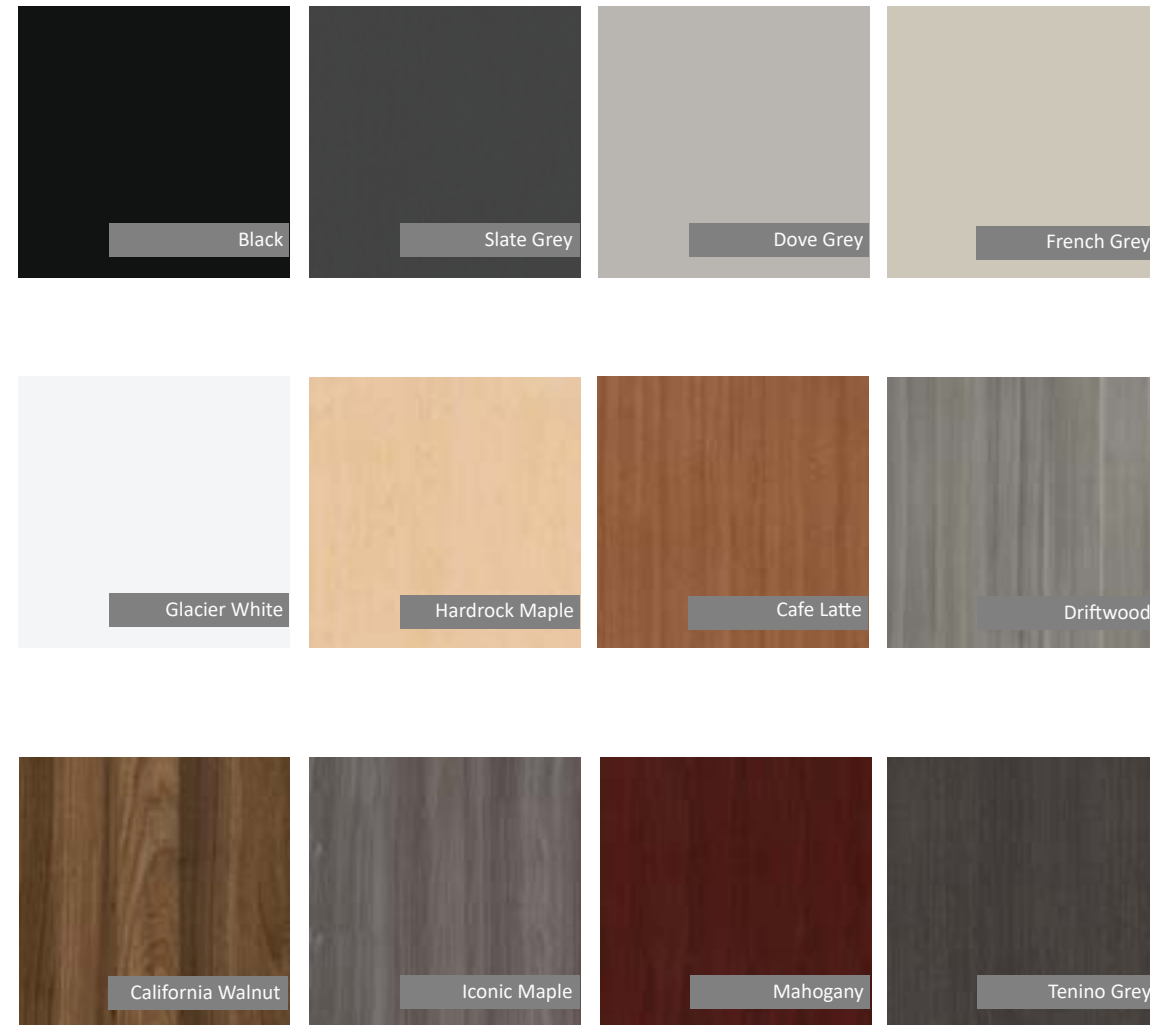

Matching 2MM PVC edgebanding is available for all Standard TFL finishes shown here. For HPL match information please visit deskmakers.com/resources/materials

premium thermofuse laminate (TFL)

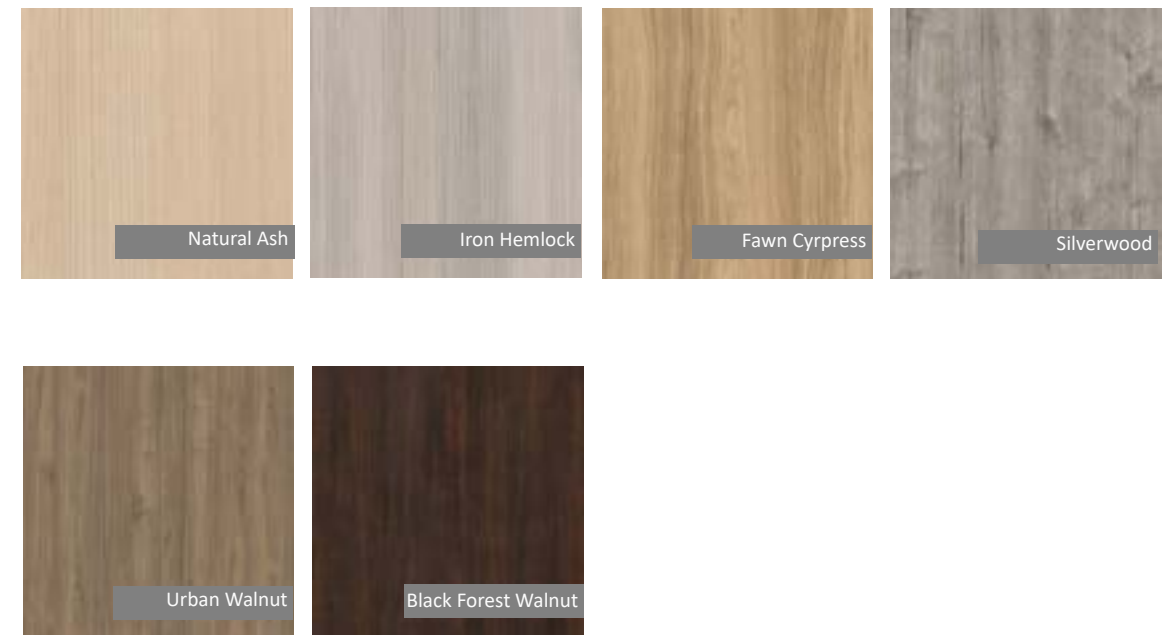

Premium TFLs require a 10% upcharge. Add item code OP-TTFL-1.

Matching 2MM PVC edgebanding is available for all Premium TFL finishes shown here.

For HPL match information please visit deskmakers.com/resources/materials

high pressure laminate (HPL)

Pricing shown in this price list applies only to non-premium HPLs as follows:

- Wilsonart: Solids, Woodgrains, and Abstracts in Matte (-60) finish,
- Formica: Color Portfolio, Woodgrains, and Patterns in Matte (-58) finish
- Pionite: Solids, Woodgrains, and Abstracts in Suede (N) finish
- Arborite: Solids, Woodgrains, Textures and Abstracts in Matte (CA) finish
- Nevamar: Solids, Woodgrains, Stones and Abstracts in ARP (-T) finish

A minimum charge of \$520 net per HPL color will be applied to each order.

Call customer service for pricing for all other HPLs.

Additional lead times required for HPL orders depending on material availability and order complexity. HPL is always available with DeskMakers standard 2MM edgebanding. Special order matching PVC 2MM edgebanding may be available for orders \$25,000 List or larger, call customer service for pricing.

Laminate Base Acrylic Screens - Side Screens

1/4" Thick - Rounded Corners
6" Overhang

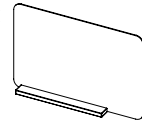

Model Number	Worksurface Depth	Height	Acrylic Length	Laminate Base Length	Clear (CL)	Frosted (FR)
18" High						
RE-ALS1-1824-??	18	18	24	16	\$487	\$502
RE-ALS1-1827-??	21	18	27	19	\$508	\$528
RE-ALS1-1830-??	24	18	30	22	\$521	\$543
RE-ALS1-1833-??	27	18	33	25	\$545	\$569
RE-ALS1-1836-??	30	18	36	28	\$557	\$581
RE-ALS1-1842-??	36	18	42	34	\$594	\$624
24" High						
RE-ALS1-2424-??	18	24	24	16	\$525	\$545
RE-ALS1-2427-??	21	24	27	19	\$553	\$577
RE-ALS1-2430-??	24	24	30	22	\$570	\$595
RE-ALS1-2433-??	27	24	33	25	\$599	\$629
RE-ALS1-2436-??	30	24	36	28	\$613	\$645
RE-ALS1-2442-??	36	24	42	34	\$662	\$698

Laminate Base Acrylic Screens - Side Screens

1/4" Thick - Rounded Corners
12" Overhang

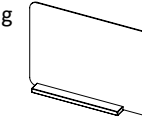

Model Number	Worksurface Depth	Height	Acrylic Length	Laminate Base Length	Clear (CL)	Frosted (FR)
18" High						
RE-ALS2-1830-??	18	18	30	16	\$515	\$537
RE-ALS2-1833-??	21	18	33	19	\$537	\$560
RE-ALS2-1836-??	24	18	36	22	\$551	\$575
RE-ALS2-1839-??	27	18	39	25	\$575	\$601
RE-ALS2-1842-??	30	18	42	28	\$584	\$613
RE-ALS2-1848-??	36	18	48	34	\$624	\$656
24" High						
RE-ALS2-2430-??	18	24	30	16	\$563	\$589
RE-ALS2-2433-??	21	24	33	19	\$590	\$620
RE-ALS2-2436-??	24	24	36	22	\$607	\$639
RE-ALS2-2439-??	27	24	39	25	\$638	\$672
RE-ALS2-2442-??	30	24	42	28	\$652	\$688
RE-ALS2-2448-??	36	24	48	34	\$698	\$741

- Laminate base is 1-1/8" thick TFL and 6" deep.
- Laminate base includes neoprene pads to protect surfaces.
- 24" high panels are actually 23-1/2" high, lengths are cut exact to size. Laminate base screens have a maximum height of 24" high.
- Rounded corners have a 2" radius.
- Ships KD, assembly required.
- Miracle Tape can be used to secure laminate base to worksurface, see page 73 for pricing and options.

Laminate Base Acrylic Screens - Front Screens with Single Base

1/4" Thick - Rounded Corners

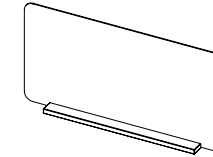

Model Number	Height	Acrylic Length	Laminate Base Length	Clear (CL)	Frosted (FR)
18" High					
RE-ALF1-1818-??	18	18	12	\$456	\$466
RE-ALF1-1824-??	18	24	16	\$487	\$502
RE-ALF1-1830-??	18	30	18	\$517	\$539
RE-ALF1-1836-??	18	36	24	\$551	\$575
RE-ALF1-1842-??	18	42	30	\$585	\$615
RE-ALF1-1848-??	18	48	36	\$625	\$657
RE-ALF1-1854-??	18	54	42	\$656	\$693
RE-ALF1-1860-??	18	60	48	\$688	\$727
RE-ALF1-1866-??	18	66	54	\$741	\$786
RE-ALF1-1872-??	18	72	60	\$772	\$821
RE-ALF1-1878-??	18	78	66	\$817	\$869
RE-ALF1-1884-??	18	84	72	\$859	\$917
RE-ALF1-1890-??	18	90	78	\$904	\$964
RE-ALF1-1896-??	18	96	84	\$948	\$1,012
24" High					
RE-ALF1-2418-??	24	18	14	\$483	\$498
RE-ALF1-2424-??	24	24	16	\$525	\$545
RE-ALF1-2430-??	24	30	18	\$566	\$592
RE-ALF1-2436-??	24	36	24	\$607	\$639
RE-ALF1-2442-??	24	42	30	\$653	\$689
RE-ALF1-2448-??	24	48	36	\$699	\$743
RE-ALF1-2454-??	24	54	42	\$740	\$789
RE-ALF1-2460-??	24	60	48	\$781	\$835
RE-ALF1-2466-??	24	66	54	\$845	\$904
RE-ALF1-2472-??	24	72	60	\$886	\$950
RE-ALF1-2478-??	24	78	66	\$940	\$1,009
RE-ALF1-2484-??	24	84	72	\$992	\$1,068
RE-ALF1-2490-??	24	90	78	\$1,046	\$1,126
RE-ALF1-2496-??	24	96	84	\$1,099	\$1,184

- Laminate base is 1-1/8" thick TFL and 6" deep.
- Laminate base includes neoprene pads to protect surfaces.
- 24" high panels are actually 23-1/2" high, lengths are cut exact to size. Laminate base screens have a maximum height of 24" high.
- Rounded corners have a 2" radius.
- Ships KD, assembly required.
- Miracle Tape can be used to secure laminate base to worksurface, see page 73 for pricing and options.

Laminate Base Acrylic Screens - Front Screens with Double Bases

1/4" Thick - Rounded Corners

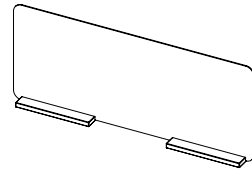

Model Number	Height	Acrylic Length	Laminate Base Length	Clear (CL)	Frosted (FR)
18" High					
RE-ALF2-1836-??	18	36	8	\$677	\$702
RE-ALF2-1842-??	18	42	10	\$709	\$739
RE-ALF2-1848-??	18	48	12	\$741	\$773
RE-ALF2-1854-??	18	54	14	\$775	\$812
RE-ALF2-1860-??	18	60	16	\$807	\$846
RE-ALF2-1866-??	18	66	18	\$839	\$884
RE-ALF2-1872-??	18	72	20	\$872	\$921
RE-ALF2-1878-??	18	78	22	\$904	\$956
RE-ALF2-1884-??	18	84	24	\$931	\$989
RE-ALF2-1890-??	18	90	26	\$971	\$1,031
RE-ALF2-1896-??	18	96	28	\$1,001	\$1,065
24" High					
RE-ALF2-2436-??	24	36	8	\$734	\$766
RE-ALF2-2442-??	24	42	10	\$777	\$813
RE-ALF2-2448-??	24	48	12	\$816	\$859
RE-ALF2-2454-??	24	54	14	\$859	\$908
RE-ALF2-2460-??	24	60	16	\$900	\$954
RE-ALF2-2466-??	24	66	18	\$942	\$1,001
RE-ALF2-2472-??	24	72	20	\$986	\$1,050
RE-ALF2-2478-??	24	78	22	\$1,027	\$1,096
RE-ALF2-2484-??	24	84	24	\$1,064	\$1,140
RE-ALF2-2490-??	24	90	26	\$1,113	\$1,192
RE-ALF2-2496-??	24	96	28	\$1,152	\$1,238

- Laminate base is 1-1/8" thick TFL and 6" deep.
- Laminate base includes neoprene pads to protect surfaces.
- 24" high panels are actually 23-1/2" high, lengths are cut exact to size. Laminate base screens have a maximum height of 24" high.
- Rounded corners have a 2" radius.
- Ships KD, assembly required.
- Miracle Tape can be used to secure laminate base to worksurface, see page 73 for pricing and options.

Laminate Base Acrylic Screens - Front Screens with Double Bases and Transaction Cutout

1/4" Thick - Rounded Corners

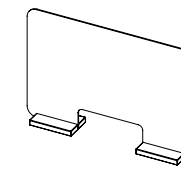

Model Number	Height	Acrylic Length	Laminate Base Length	Clear (CL)	Frosted (FR)
18" High					
RE-ALF3-1836-??	18	36	8	\$717	\$744
RE-ALF3-1842-??	18	42	10	\$752	\$784
RE-ALF3-1848-??	18	48	12	\$786	\$822
RE-ALF3-1854-??	18	54	14	\$823	\$863
RE-ALF3-1860-??	18	60	16	\$858	\$901
RE-ALF3-1866-??	18	66	18	\$892	\$941
RE-ALF3-1872-??	18	72	20	\$928	\$982
RE-ALF3-1878-??	18	78	22	\$963	\$1,022
RE-ALF3-1884-??	18	84	24	\$994	\$1,056
RE-ALF3-1890-??	18	90	26	\$1,036	\$1,102
RE-ALF3-1896-??	18	96	28	\$1,069	\$1,140
24" High					
RE-ALF3-2436-??	24	36	8	\$779	\$814
RE-ALF3-2442-??	24	42	10	\$826	\$866
RE-ALF3-2448-??	24	48	12	\$868	\$917
RE-ALF3-2454-??	24	54	14	\$916	\$969
RE-ALF3-2460-??	24	60	16	\$960	\$1,019
RE-ALF3-2466-??	24	66	18	\$1,006	\$1,072
RE-ALF3-2472-??	24	72	20	\$1,054	\$1,124
RE-ALF3-2478-??	24	78	22	\$1,099	\$1,174
RE-ALF3-2484-??	24	84	24	\$1,142	\$1,225
RE-ALF3-2490-??	24	90	26	\$1,190	\$1,277
RE-ALF3-2496-??	24	96	28	\$1,236	\$1,330

- Laminate base is 1-1/8" thick TFL and 6" deep.
- Laminate base includes neoprene pads to protect surfaces.
- 24" high panels are actually 23-1/2" high, lengths are cut exact to size. Laminate base screens have a maximum height of 24" high.
- Rounded corners have a 2" radius.
- Cutout is 6" high and the same length as laminate base.
- Ships KD, assembly required.
- Miracle Tape can be used to secure laminate base to worksurface, see page 73 for pricing and options.

Tri-Clip - Clip only

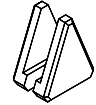

Model Number	Width	Depth	Height	Price
RE-TCLP-??	2-3/16"	VARIES	2-5/8"	\$28

- To order, replace "???" with "BK" for black, "WT" for white or "SV" for silver.
- Fits materials 1/4", 3/8" and 3/4" thick.
- Tri-Clip must be screwed to worksurface or spinewall.
- Price is for a quantity of one.

Tri-Clip with Freestanding Foot

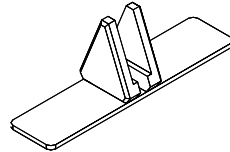

Model Number	Width	Depth	Height	Price
RE-TCFT-??	8"	1-13/16"	2-3/4"	\$54

- To order, replace "???" with "BK" for black, "WT" for white or "SV" for silver.
- Metal foot includes neoprene pads to protect surfaces.
- Price is for a quantity of one.
- Miracle Tape can be used to secure foot to worksurface, see page 73 for pricing and options.

Tri-Clip with C-Clamp for Front Edge Mount

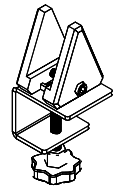

Model Number	Width	Depth	Height	Price
RE-TCCF-??	2"	2-3/8"	4-5/8"	\$76

- To order, replace "???" with "BK" for black, "WT" for white or "SV" for silver.
- Maximum worksurface thickness is 1-1/2".
- Clamp includes neoprene pad to protect surfaces.
- Price is for a quantity of one.

Tri-Clip with C-Clamp for Side Edge Mount

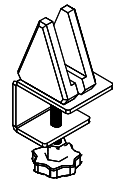

Model Number	Width	Depth	Height	Price
RE-TCCE-??	2"	2-3/8"	4-5/8"	\$76

- To order, replace "???" with "BK" for black, "WT" for white or "SV" for silver.
- Maximum worksurface thickness is 1-1/2".
- Clamp includes neoprene pad to protect surfaces.
- Price is for a quantity of one.

Tri-Clip with Small Foot

Used with Side Edge Mount C-Clamp

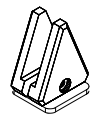

Model Number	Width	Depth	Height	Price
RE-TCFS-??	1-11/16"	1-13/16"	2-3/4"	\$44

- To order, replace "???" with "BK" for black, "WT" for white or "SV" for silver.
- Metal foot includes neoprene pad to protect surfaces.
- Price is for a quantity of one.

Tri-Clip with Panel Bracket

For use with 1/4" thick acrylic only

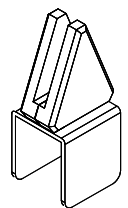

Model Number	Width	Depth	Height	Inside Dimension	Price
RE-TCP1-??	1-7/8"	1-5/8"	4-7/8"	1-1/4"	\$45
RE-TCP5-??	1-7/8"	2"	4-7/8"	1-5/8"	\$50
RE-TCP2-??	1-7/8"	2-1/2"	4-7/8"	2-1/8"	\$52
RE-TCP3-??	1-7/8"	3-1/2"	4-7/8"	3-1/8"	\$59

- To order, replace "???" with "BK" for black, "WT" for white or "SV" for silver.
- Bracket includes neoprene pad to protect surfaces and additional pads to create a pressure fit.
- Price is for a quantity of one.
- Miracle Tape can be used to secure bracket to panel, see page 73 for pricing and options.

Acrylic Panel Connector - Base Clip

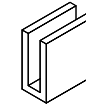

Model Number	Width	Depth	Height	Chrome	Gold
RE-ACST-??	1"	5/8"	1-1/16"	\$64	\$61

- To order, replace "???" with "PCH" for polished chrome or "GLD" for gold.
- Fits 1/4" thick material only.
- Base clip can be secured to worksurface with screw or miracle tape.
- Price is for a quantity of one.

Acrylic Panel Connector - 4 Way Connector

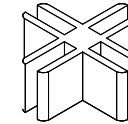

Model Number	Width	Depth	Height	Chrome	Gold
RE-AC4W-??	2-1/8"	2-1/8"	7/8"	\$88	\$85

- To order, replace "???" with "PCH" for polished chrome or "GLD" for gold.
- Fits 1/4" thick material only.
- Price is for a quantity of one.

Acrylic Panel Connector - 90 Degree Connector

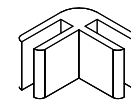

Model Number	Width	Depth	Height	Chrome	Gold
RE-AC90-??	1-5/16"	1-5/16"	7/8"	\$74	\$77

- To order, replace "???" with "PCH" for polished chrome or "GLD" for gold.
- Fits 1/4" thick material only.
- Price is for a quantity of one.

Acrylic Panel Connector - 180 Degree Inline Connector

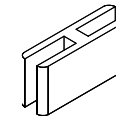

Model Number	Width	Depth	Height	Chrome	Gold
RE-AC18-??	1-7/8"	1/2"	7/8"	\$56	\$51

- To order, replace "???" with "PCH" for polished chrome or "GLD" for gold.
- Fits 1/4" thick material only.
- Price is for a quantity of one.

Acrylic Panel Connector - 3 Way 90 Degree Connector

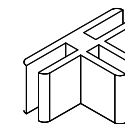

Model Number	Width	Depth	Height	Chrome	Gold
RE-AC3W-??	2"	1-5/16"	7/8"	\$91	\$95

- To order, replace "???" with "PCH" for polished chrome or "GLD" for gold.
- Fits 1/4" thick material only.
- Price is for a quantity of one.

Miracle Tape - Double Side Tape



Model Number	Length	Width	Thickness	Price
RE-TAPE-1	39"	1-3/16"	2mm	\$54
RE-TAPE-2	197"	13/16"	2mm	\$106

- Miracle Tape is a double sided tape made from nanotechnology gel to create a secure bond.
- Will not leave a residue or damage laminate surfaces. Reusable by rinsing with water
- Price is for a quantity of one roll, cut to size in field.

Acrylic Cutouts

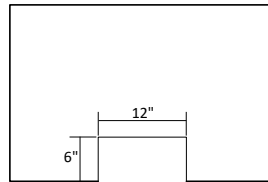

Model Number	Width	Depth	Height	Price
OP-TCUT-1	12"	6"	centered	\$128
OP-TCUT-CUST	Custom size and location			\$509

- Standard cutout size is 12" long x 6" high and is centered on the bottom of the acrylic panel.
- One cutout charge is needed for multiple screens that are the same size, with the same cutout.
- For custom cutouts, contact customer service for assistance.
- Cutouts are not available on glass or laminate panels.

Cut Charge

Model Number	Price
OP-CUT1	One Cut - length or height \$140

Acrylic Panels - Panel Only

1/4" Thick - Square Corners

6" High

Model Number	Height	Length	Required Number of Clips	Clear (CL)	Frosted (FR)
RE-ASQ4-0618-??	6	18	2	\$172	\$174
RE-ASQ4-0620-??	6	20	2	\$186	\$188
RE-ASQ4-0622-??	6	22	2	\$200	\$202
RE-ASQ4-0624-??	6	24	2	\$214	\$218
RE-ASQ4-0626-??	6	26	2	\$216	\$220
RE-ASQ4-0628-??	6	28	2	\$219	\$223
RE-ASQ4-0630-??	6	30	2	\$222	\$225
RE-ASQ4-0632-??	6	32	2	\$224	\$228
RE-ASQ4-0634-??	6	34	2	\$227	\$230
RE-ASQ4-0636-??	6	36	2	\$229	\$233
RE-ASQ4-0638-??	6	38	2	\$232	\$236
RE-ASQ4-0640-??	6	40	2	\$234	\$238
RE-ASQ4-0642-??	6	42	2	\$237	\$241
RE-ASQ4-0644-??	6	44	2	\$239	\$243
RE-ASQ4-0646-??	6	46	2	\$242	\$246
RE-ASQ4-0648-??	6	48	2	\$256	\$261
RE-ASQ4-0650-??	6	50	3	\$259	\$264
RE-ASQ4-0652-??	6	52	3	\$261	\$266
RE-ASQ4-0654-??	6	54	3	\$264	\$269
RE-ASQ4-0656-??	6	56	3	\$266	\$271
RE-ASQ4-0658-??	6	58	3	\$269	\$274
RE-ASQ4-0660-??	6	60	3	\$271	\$277
RE-ASQ4-0662-??	6	62	3	\$274	\$279
RE-ASQ4-0664-??	6	64	3	\$277	\$282
RE-ASQ4-0666-??	6	66	3	\$279	\$284
RE-ASQ4-0668-??	6	68	3	\$282	\$287
RE-ASQ4-0670-??	6	70	3	\$284	\$289
RE-ASQ4-0672-??	6	72	3	\$298	\$305
RE-ASQ4-0674-??	6	74	3	\$309	\$315
RE-ASQ4-0676-??	6	76	3	\$319	\$325
RE-ASQ4-0678-??	6	78	3	\$329	\$335
RE-ASQ4-0680-??	6	80	3	\$339	\$346
RE-ASQ4-0682-??	6	82	3	\$350	\$356
RE-ASQ4-0684-??	6	84	3	\$360	\$366
RE-ASQ4-0686-??	6	86	3	\$370	\$376

- Panels are cut exact to size.
- Square corners have a slight radius.
- Clips and mounting hardware sold separately.

Acrylic Panels - Panel Only

1/4" Thick - Rounded Corners

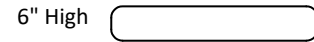

Radius All Four Corners

Model Number	Height	Length	Required Number of Clips	Clear (CL)	Frosted (FR)
RE-ARD4-0618-??	6	18	2	\$172	\$174
RE-ARD4-0620-??	6	20	2	\$186	\$188
RE-ARD4-0622-??	6	22	2	\$200	\$202
RE-ARD4-0624-??	6	24	2	\$214	\$218
RE-ARD4-0626-??	6	26	2	\$216	\$220
RE-ARD4-0628-??	6	28	2	\$219	\$223
RE-ARD4-0630-??	6	30	2	\$222	\$225
RE-ARD4-0632-??	6	32	2	\$224	\$228
RE-ARD4-0634-??	6	34	2	\$227	\$230
RE-ARD4-0636-??	6	36	2	\$229	\$233
RE-ARD4-0638-??	6	38	2	\$232	\$236
RE-ARD4-0640-??	6	40	2	\$234	\$238
RE-ARD4-0642-??	6	42	2	\$237	\$241
RE-ARD4-0644-??	6	44	2	\$239	\$243
RE-ARD4-0646-??	6	46	2	\$242	\$246
RE-ARD4-0648-??	6	48	2	\$256	\$261
RE-ARD4-0650-??	6	50	3	\$259	\$264
RE-ARD4-0652-??	6	52	3	\$261	\$266
RE-ARD4-0654-??	6	54	3	\$264	\$269
RE-ARD4-0656-??	6	56	3	\$266	\$271
RE-ARD4-0658-??	6	58	3	\$269	\$274
RE-ARD4-0660-??	6	60	3	\$271	\$277
RE-ARD4-0662-??	6	62	3	\$274	\$279
RE-ARD4-0664-??	6	64	3	\$277	\$282
RE-ARD4-0666-??	6	66	3	\$279	\$284
RE-ARD4-0668-??	6	68	3	\$282	\$287
RE-ARD4-0670-??	6	70	3	\$284	\$289
RE-ARD4-0672-??	6	72	3	\$298	\$305
RE-ARD4-0674-??	6	74	3	\$309	\$315
RE-ARD4-0676-??	6	76	3	\$319	\$325
RE-ARD4-0678-??	6	78	3	\$329	\$335
RE-ARD4-0680-??	6	80	3	\$339	\$346
RE-ARD4-0682-??	6	82	3	\$353	\$356
RE-ARD4-0684-??	6	84	3	\$360	\$366
RE-ARD4-0686-??	6	86	3	\$370	\$376

- Panels are cut exact to size.
- Rounded corners have a 2" radius.
- Clips and mounting hardware sold separately.

Acrylic Panels - Panel Only

1/4" Thick - Rounded Corners

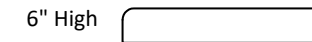

Radius Top Two Corners

Model Number	Height	Length	Required Number of Clips	Clear (CL)	Frosted (FR)
RE-ARD2-0618-??	6	18	2	\$172	\$174
RE-ARD2-0620-??	6	20	2	\$186	\$188
RE-ARD2-0622-??	6	22	2	\$200	\$202
RE-ARD2-0624-??	6	24	2	\$214	\$218
RE-ARD2-0626-??	6	26	2	\$216	\$220
RE-ARD2-0628-??	6	28	2	\$219	\$223
RE-ARD2-0630-??	6	30	2	\$222	\$225
RE-ARD2-0632-??	6	32	2	\$224	\$228
RE-ARD2-0634-??	6	34	2	\$227	\$230
RE-ARD2-0636-??	6	36	2	\$229	\$233
RE-ARD2-0638-??	6	38	2	\$232	\$236
RE-ARD2-0640-??	6	40	2	\$234	\$238
RE-ARD2-0642-??	6	42	2	\$237	\$241
RE-ARD2-0644-??	6	44	2	\$239	\$243
RE-ARD2-0646-??	6	46	2	\$242	\$246
RE-ARD2-0648-??	6	48	2	\$256	\$261
RE-ARD2-0650-??	6	50	3	\$259	\$264
RE-ARD2-0652-??	6	52	3	\$261	\$266
RE-ARD2-0654-??	6	54	3	\$264	\$269
RE-ARD2-0656-??	6	56	3	\$266	\$271
RE-ARD2-0658-??	6	58	3	\$269	\$274
RE-ARD2-0660-??	6	60	3	\$271	\$277
RE-ARD2-0662-??	6	62	3	\$274	\$279
RE-ARD2-0664-??	6	64	3	\$277	\$282
RE-ARD2-0666-??	6	66	3	\$279	\$284
RE-ARD2-0668-??	6	68	3	\$282	\$287
RE-ARD2-0670-??	6	70	3	\$284	\$289
RE-ARD2-0672-??	6	72	3	\$298	\$305
RE-ARD2-0674-??	6	74	3	\$309	\$315
RE-ARD2-0676-??	6	76	3	\$319	\$325
RE-ARD2-0678-??	6	78	3	\$325	\$335
RE-ARD2-0680-??	6	80	3	\$339	\$346
RE-ARD2-0682-??	6	82	3	\$350	\$356
RE-ARD2-0684-??	6	84	3	\$360	\$366
RE-ARD2-0686-??	6	86	3	\$370	\$376

- Panels are cut exact to size.
- Rounded corners have a 2" radius.
- Clips and mounting hardware sold separately.

Acrylic Panels - Panel Only

1/4" Thick - Square Corners



Model Number	Height	Length	Required Number of Clips	Clear (CL)	Frosted (FR)
RE-ASQ4-0818-??	8	18	2	\$172	\$174
RE-ASQ4-0820-??	8	20	2	\$186	\$188
RE-ASQ4-0822-??	8	22	2	\$200	\$202
RE-ASQ4-0824-??	8	24	2	\$214	\$218
RE-ASQ4-0826-??	8	26	2	\$216	\$220
RE-ASQ4-0828-??	8	28	2	\$219	\$223
RE-ASQ4-0830-??	8	30	2	\$222	\$225
RE-ASQ4-0832-??	8	32	2	\$224	\$228
RE-ASQ4-0834-??	8	34	2	\$227	\$230
RE-ASQ4-0836-??	8	36	2	\$229	\$233
RE-ASQ4-0838-??	8	38	2	\$232	\$236
RE-ASQ4-0840-??	8	40	2	\$234	\$238
RE-ASQ4-0842-??	8	42	2	\$237	\$241
RE-ASQ4-0844-??	8	44	2	\$239	\$243
RE-ASQ4-0846-??	8	46	2	\$242	\$246
RE-ASQ4-0848-??	8	48	2	\$256	\$261
RE-ASQ4-0850-??	8	50	3	\$259	\$264
RE-ASQ4-0852-??	8	52	3	\$261	\$266
RE-ASQ4-0854-??	8	54	3	\$264	\$269
RE-ASQ4-0856-??	8	56	3	\$266	\$271
RE-ASQ4-0858-??	8	58	3	\$269	\$274
RE-ASQ4-0860-??	8	60	3	\$271	\$277
RE-ASQ4-0862-??	8	62	3	\$274	\$279
RE-ASQ4-0864-??	8	64	3	\$277	\$282
RE-ASQ4-0866-??	8	66	3	\$279	\$284
RE-ASQ4-0868-??	8	68	3	\$282	\$287
RE-ASQ4-0870-??	8	70	3	\$284	\$289
RE-ASQ4-0872-??	8	72	3	\$298	\$305
RE-ASQ4-0874-??	8	74	3	\$309	\$315
RE-ASQ4-0876-??	8	76	3	\$319	\$325
RE-ASQ4-0878-??	8	78	3	\$329	\$335
RE-ASQ4-0880-??	8	80	3	\$339	\$346
RE-ASQ4-0882-??	8	82	3	\$350	\$356
RE-ASQ4-0884-??	8	84	3	\$360	\$366
RE-ASQ4-0886-??	8	86	3	\$370	\$376

- Panels are cut exact to size.
- Square corners have a slight radius.
- Clips and mounting hardware sold separately.

Acrylic Panels - Panel Only

1/4" Thick - Rounded Corners

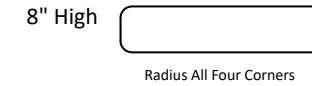

Model Number	Height	Length	Required Number of Clips	Clear (CL)	Frosted (FR)
RE-ARD4-0818-??	8	18	2	\$172	\$174
RE-ARD4-0820-??	8	20	2	\$186	\$188
RE-ARD4-0822-??	8	22	2	\$200	\$202
RE-ARD4-0824-??	8	24	2	\$214	\$218
RE-ARD4-0826-??	8	26	2	\$216	\$220
RE-ARD4-0828-??	8	28	2	\$219	\$223
RE-ARD4-0830-??	8	30	2	\$222	\$225
RE-ARD4-0832-??	8	32	2	\$224	\$228
RE-ARD4-0834-??	8	34	2	\$227	\$230
RE-ARD4-0836-??	8	36	2	\$229	\$233
RE-ARD4-0838-??	8	38	2	\$232	\$236
RE-ARD4-0840-??	8	40	2	\$234	\$238
RE-ARD4-0842-??	8	42	2	\$237	\$241
RE-ARD4-0844-??	8	44	2	\$239	\$243
RE-ARD4-0846-??	8	46	2	\$242	\$246
RE-ARD4-0848-??	8	48	2	\$256	\$261
RE-ARD4-0850-??	8	50	3	\$259	\$264
RE-ARD4-0852-??	8	52	3	\$261	\$266
RE-ARD4-0854-??	8	54	3	\$264	\$269
RE-ARD4-0856-??	8	56	3	\$266	\$271
RE-ARD4-0858-??	8	58	3	\$269	\$274
RE-ARD4-0860-??	8	60	3	\$271	\$277
RE-ARD4-0862-??	8	62	3	\$274	\$279
RE-ARD4-0864-??	8	64	3	\$277	\$282
RE-ARD4-0866-??	8	66	3	\$279	\$284
RE-ARD4-0868-??	8	68	3	\$282	\$287
RE-ARD4-0870-??	8	70	3	\$284	\$289
RE-ARD4-0872-??	8	72	3	\$298	\$305
RE-ARD4-0874-??	8	74	3	\$309	\$315
RE-ARD4-0876-??	8	76	3	\$319	\$325
RE-ARD4-0878-??	8	78	3	\$329	\$335
RE-ARD4-0880-??	8	80	3	\$339	\$346
RE-ARD4-0882-??	8	82	3	\$350	\$356
RE-ARD4-0884-??	8	84	3	\$360	\$366
RE-ARD4-0886-??	8	86	3	\$370	\$376

- Panels are cut exact to size.
- Rounded corners have a 2" radius.
- Clips and mounting hardware sold separately.

Acrylic Panels - Panel Only

1/4" Thick - Rounded Corners

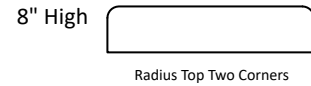

Model Number	Height	Length	Required Number of Clips	Clear (CL)	Frosted (FR)
RE-ARD2-0818-??	8	18	2	\$172	\$174
RE-ARD2-0820-??	8	20	2	\$186	\$188
RE-ARD2-0822-??	8	22	2	\$200	\$202
RE-ARD2-0824-??	8	24	2	\$214	\$218
RE-ARD2-0826-??	8	26	2	\$216	\$230
RE-ARD2-0828-??	8	28	2	\$219	\$223
RE-ARD2-0830-??	8	30	2	\$222	\$225
RE-ARD2-0832-??	8	32	2	\$224	\$228
RE-ARD2-0834-??	8	34	2	\$227	\$230
RE-ARD2-0836-??	8	36	2	\$229	\$233
RE-ARD2-0838-??	8	38	2	\$232	\$236
RE-ARD2-0840-??	8	40	2	\$234	\$238
RE-ARD2-0842-??	8	42	2	\$237	\$241
RE-ARD2-0844-??	8	44	2	\$239	\$243
RE-ARD2-0846-??	8	46	2	\$242	\$246
RE-ARD2-0848-??	8	48	2	\$256	\$261
RE-ARD2-0850-??	8	50	3	\$259	\$264
RE-ARD2-0852-??	8	52	3	\$261	\$266
RE-ARD2-0854-??	8	54	3	\$264	\$269
RE-ARD2-0856-??	8	56	3	\$266	\$271
RE-ARD2-0858-??	8	58	3	\$269	\$274
RE-ARD2-0860-??	8	60	3	\$271	\$277
RE-ARD2-0862-??	8	62	3	\$274	\$279
RE-ARD2-0864-??	8	64	3	\$277	\$282
RE-ARD2-0866-??	8	66	3	\$279	\$284
RE-ARD2-0868-??	8	68	3	\$282	\$287
RE-ARD2-0870-??	8	70	3	\$284	\$289
RE-ARD2-0872-??	8	72	3	\$298	\$305
RE-ARD2-0874-??	8	74	3	\$309	\$315
RE-ARD2-0876-??	8	76	3	\$319	\$325
RE-ARD2-0878-??	8	78	3	\$329	\$335
RE-ARD2-0880-??	8	80	3	\$339	\$346
RE-ARD2-0882-??	8	82	3	\$350	\$356
RE-ARD2-0884-??	8	84	3	\$360	\$366
RE-ARD2-0886-??	8	86	3	\$370	\$376

- Panels are cut exact to size.
- Rounded corners have a 2" radius.
- Clips and mounting hardware sold separately.

Acrylic Panels - Panel Only

1/4" Thick - Square Corners



Model Number	Height	Length	Required Number of Clips	Clear (CL)	Frosted (FR)
RE-ASQ4-1018-??	10	18	2	\$172	\$174
RE-ASQ4-1020-??	10	20	2	\$186	\$188
RE-ASQ4-1022-??	10	22	2	\$200	\$202
RE-ASQ4-1024-??	10	24	2	\$214	\$218
RE-ASQ4-1026-??	10	26	2	\$216	\$220
RE-ASQ4-1028-??	10	28	2	\$219	\$223
RE-ASQ4-1030-??	10	30	2	\$222	\$225
RE-ASQ4-1032-??	10	32	2	\$224	\$228
RE-ASQ4-1034-??	10	34	2	\$227	\$230
RE-ASQ4-1036-??	10	36	2	\$229	\$233
RE-ASQ4-1038-??	10	38	2	\$232	\$236
RE-ASQ4-1040-??	10	40	2	\$234	\$238
RE-ASQ4-1042-??	10	42	2	\$237	\$241
RE-ASQ4-1044-??	10	44	2	\$239	\$243
RE-ASQ4-1046-??	10	46	2	\$242	\$246
RE-ASQ4-1048-??	10	48	2	\$256	\$261
RE-ASQ4-1050-??	10	50	3	\$259	\$264
RE-ASQ4-1052-??	10	52	3	\$261	\$266
RE-ASQ4-1054-??	10	54	3	\$264	\$269
RE-ASQ4-1056-??	10	56	3	\$266	\$271
RE-ASQ4-1058-??	10	58	3	\$269	\$274
RE-ASQ4-1060-??	10	60	3	\$271	\$277
RE-ASQ4-1062-??	10	62	3	\$274	\$279
RE-ASQ4-1064-??	10	64	3	\$277	\$282
RE-ASQ4-1066-??	10	66	3	\$279	\$284
RE-ASQ4-1068-??	10	68	3	\$282	\$287
RE-ASQ4-1070-??	10	70	3	\$284	\$289
RE-ASQ4-1072-??	10	72	3	\$298	\$305
RE-ASQ4-1074-??	10	74	3	\$309	\$315
RE-ASQ4-1076-??	10	76	3	\$319	\$325
RE-ASQ4-1078-??	10	78	3	\$329	\$335
RE-ASQ4-1080-??	10	80	3	\$339	\$346
RE-ASQ4-1082-??	10	82	3	\$350	\$356
RE-ASQ4-1084-??	10	84	3	\$360	\$366
RE-ASQ4-1086-??	10	86	3	\$370	\$376

- Panels are cut exact to size.
- Square corners have a slight radius.
- Clips and mounting hardware sold separately.

Acrylic Panels - Panel Only

1/4" Thick - Rounded Corners

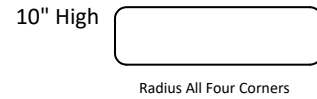

Model Number	Height	Length	Required Number of Clips	Clear (CL)	Frosted (FR)
RE-ARD4-1018-??	10	18	2	\$172	\$174
RE-ARD4-1020-??	10	20	2	\$186	\$188
RE-ARD4-1022-??	10	22	2	\$200	\$202
RE-ARD4-1024-??	10	24	2	\$214	\$218
RE-ARD4-1026-??	10	26	2	\$216	\$220
RE-ARD4-1028-??	10	28	2	\$219	\$223
RE-ARD4-1030-??	10	30	2	\$222	\$225
RE-ARD4-1032-??	10	32	2	\$224	\$228
RE-ARD4-1034-??	10	34	2	\$227	\$230
RE-ARD4-1036-??	10	36	2	\$229	\$233
RE-ARD4-1038-??	10	38	2	\$232	\$236
RE-ARD4-1040-??	10	40	2	\$234	\$238
RE-ARD4-1042-??	10	42	2	\$237	\$241
RE-ARD4-1044-??	10	44	2	\$239	\$243
RE-ARD4-1046-??	10	46	2	\$242	\$246
RE-ARD4-1048-??	10	48	2	\$256	\$261
RE-ARD4-1050-??	10	50	3	\$259	\$264
RE-ARD4-1052-??	10	52	3	\$261	\$266
RE-ARD4-1054-??	10	54	3	\$264	\$269
RE-ARD4-1056-??	10	56	3	\$266	\$271
RE-ARD4-1058-??	10	58	3	\$269	\$274
RE-ARD4-1060-??	10	60	3	\$271	\$277
RE-ARD4-1062-??	10	62	3	\$274	\$279
RE-ARD4-1064-??	10	64	3	\$277	\$282
RE-ARD4-1066-??	10	66	3	\$279	\$284
RE-ARD4-1068-??	10	68	3	\$282	\$287
RE-ARD4-1070-??	10	70	3	\$284	\$289
RE-ARD4-1072-??	10	72	3	\$298	\$305
RE-ARD4-1074-??	10	74	3	\$309	\$315
RE-ARD4-1076-??	10	76	3	\$319	\$325
RE-ARD4-1078-??	10	78	3	\$329	\$335
RE-ARD4-1080-??	10	80	3	\$339	\$346
RE-ARD4-1082-??	10	82	3	\$350	\$356
RE-ARD4-1084-??	10	84	3	\$360	\$366
RE-ARD4-1086-??	10	86	3	\$370	\$376

- Panels are cut exact to size.
- Rounded corners have a 2" radius.
- Clips and mounting hardware sold separately.

Acrylic Panels - Panel Only

1/4" Thick - Rounded Corners

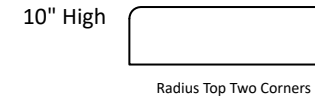

Model Number	Height	Length	Required Number of Clips	Clear (CL)	Frosted (FR)
RE-ARD2-1018-??	10	18	2	\$172	\$174
RE-ARD2-1020-??	10	20	2	\$186	\$188
RE-ARD2-1022-??	10	22	2	\$200	\$202
RE-ARD2-1024-??	10	24	2	\$214	\$218
RE-ARD2-1026-??	10	26	2	\$216	\$220
RE-ARD2-1028-??	10	28	2	\$219	\$223
RE-ARD2-1030-??	10	30	2	\$222	\$225
RE-ARD2-1032-??	10	32	2	\$224	\$228
RE-ARD2-1034-??	10	34	2	\$227	\$230
RE-ARD2-1036-??	10	36	2	\$229	\$233
RE-ARD2-1038-??	10	38	2	\$232	\$236
RE-ARD2-1040-??	10	40	2	\$234	\$238
RE-ARD2-1042-??	10	42	2	\$237	\$241
RE-ARD2-1044-??	10	44	2	\$239	\$243
RE-ARD2-1046-??	10	46	2	\$242	\$246
RE-ARD2-1048-??	10	48	2	\$256	\$261
RE-ARD2-1050-??	10	50	3	\$259	\$264
RE-ARD2-1052-??	10	52	3	\$261	\$266
RE-ARD2-1054-??	10	54	3	\$264	\$269
RE-ARD2-1056-??	10	56	3	\$266	\$271
RE-ARD2-1058-??	10	58	3	\$269	\$274
RE-ARD2-1060-??	10	60	3	\$271	\$277
RE-ARD2-1062-??	10	62	3	\$274	\$279
RE-ARD2-1064-??	10	64	3	\$277	\$282
RE-ARD2-1066-??	10	66	3	\$279	\$284
RE-ARD2-1068-??	10	68	3	\$282	\$287
RE-ARD2-1070-??	10	70	3	\$284	\$289
RE-ARD2-1072-??	10	72	3	\$298	\$305
RE-ARD2-1074-??	10	74	3	\$309	\$315
RE-ARD2-1076-??	10	76	3	\$319	\$325
RE-ARD2-1078-??	10	78	3	\$329	\$335
RE-ARD2-1080-??	10	80	3	\$339	\$346
RE-ARD2-1082-??	10	82	3	\$350	\$356
RE-ARD2-1084-??	10	84	3	\$360	\$366
RE-ARD2-1086-??	10	86	3	\$366	\$370

- Panels are cut exact to size.
- Rounded corners have a 2" radius.
- Clips and mounting hardware sold separately.

Acrylic Panels - Panel Only

1/4" Thick - Square Corners

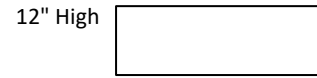

Model Number	Height	Length	Required Number of Clips	Clear (CL)	Frosted (FR)
RE-ASQ4-1218-??	12	18	2	\$214	\$218
RE-ASQ4-1220-??	12	20	2	\$228	\$232
RE-ASQ4-1222-??	12	22	2	\$242	\$246
RE-ASQ4-1224-??	12	24	2	\$256	\$261
RE-ASQ4-1226-??	12	26	2	\$262	\$268
RE-ASQ4-1228-??	12	28	2	\$269	\$274
RE-ASQ4-1230-??	12	30	2	\$275	\$280
RE-ASQ4-1232-??	12	32	2	\$282	\$287
RE-ASQ4-1234-??	12	34	2	\$288	\$293
RE-ASQ4-1236-??	12	36	2	\$298	\$305
RE-ASQ4-1238-??	12	38	2	\$311	\$319
RE-ASQ4-1240-??	12	40	2	\$324	\$333
RE-ASQ4-1242-??	12	42	2	\$337	\$347
RE-ASQ4-1244-??	12	44	2	\$350	\$361
RE-ASQ4-1246-??	12	46	2	\$362	\$375
RE-ASQ4-1248-??	12	48	2	\$382	\$392
RE-ASQ4-1250-??	12	50	3	\$388	\$398
RE-ASQ4-1252-??	12	52	3	\$394	\$405
RE-ASQ4-1254-??	12	54	3	\$401	\$411
RE-ASQ4-1256-??	12	56	3	\$407	\$417
RE-ASQ4-1258-??	12	58	3	\$414	\$424
RE-ASQ4-1260-??	12	60	3	\$420	\$430
RE-ASQ4-1262-??	12	62	3	\$426	\$437
RE-ASQ4-1264-??	12	64	3	\$433	\$443
RE-ASQ4-1266-??	12	66	3	\$439	\$449
RE-ASQ4-1268-??	12	68	3	\$446	\$456
RE-ASQ4-1270-??	12	70	3	\$452	\$462
RE-ASQ4-1272-??	12	72	3	\$466	\$479
RE-ASQ4-1274-??	12	74	3	\$476	\$489
RE-ASQ4-1276-??	12	76	3	\$487	\$499
RE-ASQ4-1278-??	12	78	3	\$497	\$510
RE-ASQ4-1280-??	12	80	3	\$507	\$520
RE-ASQ4-1282-??	12	82	3	\$517	\$530
RE-ASQ4-1284-??	12	84	3	\$528	\$540
RE-ASQ4-1286-??	12	86	3	\$538	\$551

- Panels are cut exact to size.
- Square corners have a slight radius.
- Clips and mounting hardware sold separately.

Acrylic Panels - Panel Only

1/4" Thick - Rounded Corners

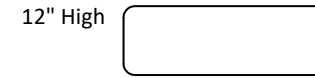

Radius All Four Corners

Model Number	Height	Length	Required Number of Clips	Clear (CL)	Frosted (FR)
RE-ARD4-1218-??	12	18	2	\$214	\$218
RE-ARD4-1220-??	12	20	2	\$228	\$232
RE-ARD4-1222-??	12	22	2	\$242	\$246
RE-ARD4-1224-??	12	24	2	\$256	\$261
RE-ARD4-1226-??	12	26	2	\$262	\$268
RE-ARD4-1228-??	12	28	2	\$269	\$274
RE-ARD4-1230-??	12	30	2	\$275	\$280
RE-ARD4-1232-??	12	32	2	\$282	\$287
RE-ARD4-1234-??	12	34	2	\$288	\$293
RE-ARD4-1236-??	12	36	2	\$298	\$305
RE-ARD4-1238-??	12	38	2	\$311	\$319
RE-ARD4-1240-??	12	40	2	\$324	\$333
RE-ARD4-1242-??	12	42	2	\$337	\$347
RE-ARD4-1244-??	12	44	2	\$350	\$361
RE-ARD4-1246-??	12	46	2	\$362	\$375
RE-ARD4-1248-??	12	48	2	\$382	\$392
RE-ARD4-1250-??	12	50	3	\$388	\$398
RE-ARD4-1252-??	12	52	3	\$394	\$405
RE-ARD4-1254-??	12	54	3	\$401	\$411
RE-ARD4-1256-??	12	56	3	\$407	\$417
RE-ARD4-1258-??	12	58	3	\$414	\$424
RE-ARD4-1260-??	12	60	3	\$420	\$430
RE-ARD4-1262-??	12	62	3	\$426	\$437
RE-ARD4-1264-??	12	64	3	\$433	\$443
RE-ARD4-1266-??	12	66	3	\$439	\$449
RE-ARD4-1268-??	12	68	3	\$446	\$456
RE-ARD4-1270-??	12	70	3	\$452	\$462
RE-ARD4-1272-??	12	72	3	\$466	\$479
RE-ARD4-1274-??	12	74	3	\$476	\$489
RE-ARD4-1276-??	12	76	3	\$487	\$499
RE-ARD4-1278-??	12	78	3	\$497	\$510
RE-ARD4-1280-??	12	80	3	\$507	\$520
RE-ARD4-1282-??	12	82	3	\$517	\$530
RE-ARD4-1284-??	12	84	3	\$528	\$540
RE-ARD4-1286-??	12	86	3	\$538	\$551

- Panels are cut exact to size.
- Rounded corners have a 2" radius.
- Clips and mounting hardware sold separately.

Acrylic Panels - Panel Only

1/4" Thick - Rounded Corners

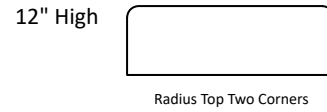

Model Number	Height	Length	Required Number of Clips	Clear (CL)	Frosted (FR)
RE-ARD2-1218-??	12	18	2	\$214	\$218
RE-ARD2-1220-??	12	20	2	\$228	\$232
RE-ARD2-1222-??	12	22	2	\$242	\$246
RE-ARD2-1224-??	12	24	2	\$256	\$261
RE-ARD2-1226-??	12	26	2	\$262	\$268
RE-ARD2-1228-??	12	28	2	\$269	\$274
RE-ARD2-1230-??	12	30	2	\$275	\$280
RE-ARD2-1232-??	12	32	2	\$282	\$287
RE-ARD2-1234-??	12	34	2	\$288	\$293
RE-ARD2-1236-??	12	36	2	\$298	\$305
RE-ARD2-1238-??	12	38	2	\$311	\$319
RE-ARD2-1240-??	12	40	2	\$324	\$333
RE-ARD2-1242-??	12	42	2	\$337	\$347
RE-ARD2-1244-??	12	44	2	\$350	\$361
RE-ARD2-1246-??	12	46	2	\$362	\$375
RE-ARD2-1248-??	12	48	2	\$382	\$392
RE-ARD2-1250-??	12	50	3	\$388	\$398
RE-ARD2-1252-??	12	52	3	\$394	\$405
RE-ARD2-1254-??	12	54	3	\$401	\$411
RE-ARD2-1256-??	12	56	3	\$407	\$417
RE-ARD2-1258-??	12	58	3	\$414	\$424
RE-ARD2-1260-??	12	60	3	\$420	\$430
RE-ARD2-1262-??	12	62	3	\$426	\$437
RE-ARD2-1264-??	12	64	3	\$433	\$443
RE-ARD2-1266-??	12	66	3	\$439	\$449
RE-ARD2-1268-??	12	68	3	\$446	\$456
RE-ARD2-1270-??	12	70	3	\$452	\$462
RE-ARD2-1272-??	12	72	3	\$466	\$479
RE-ARD2-1274-??	12	74	3	\$476	\$489
RE-ARD2-1276-??	12	76	3	\$487	\$499
RE-ARD2-1278-??	12	78	3	\$497	\$510
RE-ARD2-1280-??	12	80	3	\$507	\$520
RE-ARD2-1282-??	12	82	3	\$517	\$530
RE-ARD2-1284-??	12	84	3	\$528	\$540
RE-ARD2-1286-??	12	86	3	\$538	\$551

- Panels are cut exact to size.
- Rounded corners have a 2" radius.
- Clips and mounting hardware sold separately.

Acrylic Panels - Panel Only

1/4" Thick - Square Corners



Model Number	Height	Length	Required Number of Clips	Clear (CL)	Frosted (FR)
RE-ASQ4-1518-??	15	18	2	\$214	\$218
RE-ASQ4-1520-??	15	20	2	\$228	\$232
RE-ASQ4-1522-??	15	22	2	\$242	\$246
RE-ASQ4-1524-??	15	24	2	\$256	\$261
RE-ASQ4-1526-??	15	26	2	\$262	\$268
RE-ASQ4-1528-??	15	28	2	\$269	\$274
RE-ASQ4-1530-??	15	30	2	\$275	\$280
RE-ASQ4-1532-??	15	32	2	\$282	\$287
RE-ASQ4-1534-??	15	34	2	\$288	\$293
RE-ASQ4-1536-??	15	36	2	\$298	\$305
RE-ASQ4-1538-??	15	38	2	\$305	\$319
RE-ASQ4-1540-??	15	40	2	\$324	\$333
RE-ASQ4-1542-??	15	42	2	\$337	\$347
RE-ASQ4-1544-??	15	44	2	\$350	\$361
RE-ASQ4-1546-??	15	46	2	\$362	\$375
RE-ASQ4-1548-??	15	48	2	\$382	\$392
RE-ASQ4-1550-??	15	50	3	\$259	\$398
RE-ASQ4-1552-??	15	52	3	\$394	\$405
RE-ASQ4-1554-??	15	54	3	\$401	\$411
RE-ASQ4-1556-??	15	56	3	\$407	\$417
RE-ASQ4-1558-??	15	58	3	\$414	\$424
RE-ASQ4-1560-??	15	60	3	\$420	\$430
RE-ASQ4-1562-??	15	62	3	\$426	\$437
RE-ASQ4-1564-??	15	64	3	\$433	\$443
RE-ASQ4-1566-??	15	66	3	\$439	\$449
RE-ASQ4-1568-??	15	68	3	\$446	\$456
RE-ASQ4-1570-??	15	70	3	\$452	\$462
RE-ASQ4-1572-??	15	72	3	\$466	\$479
RE-ASQ4-1574-??	15	74	3	\$476	\$489
RE-ASQ4-1576-??	15	76	3	\$487	\$499
RE-ASQ4-1578-??	15	78	3	\$497	\$510
RE-ASQ4-1580-??	15	80	3	\$507	\$520
RE-ASQ4-1582-??	15	82	3	\$517	\$530
RE-ASQ4-1584-??	15	84	3	\$528	\$540
RE-ASQ4-1586-??	15	86	3	\$538	\$551

- Panels are cut exact to size.
- Square corners have a slight radius.
- Clips and mounting hardware sold separately.

Acrylic Panels - Panel Only

1/4" Thick - Rounded Corners

15" High



Radius All Four Corners

Model Number	Height	Length	Required Number of Clips	Clear (CL)	Frosted (FR)
RE-ARD4-1518-??	15	18	2	\$214	\$218
RE-ARD4-1520-??	15	20	2	\$228	\$232
RE-ARD4-1522-??	15	22	2	\$242	\$246
RE-ARD4-1524-??	15	24	2	\$256	\$261
RE-ARD4-1526-??	15	26	2	\$262	\$268
RE-ARD4-1528-??	15	28	2	\$269	\$274
RE-ARD4-1530-??	15	30	2	\$275	\$280
RE-ARD4-1532-??	15	32	2	\$282	\$287
RE-ARD4-1534-??	15	34	2	\$288	\$293
RE-ARD4-1536-??	15	36	2	\$298	\$305
RE-ARD4-1538-??	15	38	2	\$311	\$319
RE-ARD4-1540-??	15	40	2	\$324	\$333
RE-ARD4-1542-??	15	42	2	\$337	\$347
RE-ARD4-1544-??	15	44	2	\$350	\$361
RE-ARD4-1546-??	15	46	2	\$362	\$375
RE-ARD4-1548-??	15	48	2	\$382	\$392
RE-ARD4-1550-??	15	50	3	\$388	\$398
RE-ARD4-1552-??	15	52	3	\$394	\$405
RE-ARD4-1554-??	15	54	3	\$401	\$411
RE-ARD4-1556-??	15	56	3	\$407	\$417
RE-ARD4-1558-??	15	58	3	\$414	\$424
RE-ARD4-1560-??	15	60	3	\$420	\$430
RE-ARD4-1562-??	15	62	3	\$426	\$437
RE-ARD4-1564-??	15	64	3	\$433	\$443
RE-ARD4-1566-??	15	66	3	\$439	\$449
RE-ARD4-1568-??	15	68	3	\$446	\$456
RE-ARD4-1570-??	15	70	3	\$452	\$462
RE-ARD4-1572-??	15	72	3	\$466	\$479
RE-ARD4-1574-??	15	74	3	\$476	\$489
RE-ARD4-1576-??	15	76	3	\$487	\$499
RE-ARD4-1578-??	15	78	3	\$497	\$510
RE-ARD4-1580-??	15	80	3	\$507	\$520
RE-ARD4-1582-??	15	82	3	\$517	\$530
RE-ARD4-1584-??	15	84	3	\$528	\$540
RE-ARD4-1586-??	15	86	3	\$538	\$551

- Panels are cut exact to size.
- Rounded corners have a 2" radius.
- Clips and mounting hardware sold separately.

Acrylic Panels - Panel Only

1/4" Thick - Rounded Corners

15" High



Radius Top Two Corners

Model Number	Height	Length	Required Number of Clips	Clear (CL)	Frosted (FR)
RE-ARD2-1518-??	15	18	2	\$214	\$218
RE-ARD2-1520-??	15	20	2	\$228	\$232
RE-ARD2-1522-??	15	22	2	\$242	\$246
RE-ARD2-1524-??	15	24	2	\$256	\$261
RE-ARD2-1526-??	15	26	2	\$262	\$268
RE-ARD2-1528-??	15	28	2	\$269	\$274
RE-ARD2-1530-??	15	30	2	\$275	\$280
RE-ARD2-1532-??	15	32	2	\$282	\$287
RE-ARD2-1534-??	15	34	2	\$288	\$293
RE-ARD2-1536-??	15	36	2	\$298	\$305
RE-ARD2-1538-??	15	38	2	\$311	\$319
RE-ARD2-1540-??	15	40	2	\$324	\$333
RE-ARD2-1542-??	15	42	2	\$337	\$347
RE-ARD2-1544-??	15	44	2	\$350	\$361
RE-ARD2-1546-??	15	46	2	\$362	\$375
RE-ARD2-1548-??	15	48	2	\$382	\$392
RE-ARD2-1550-??	15	50	3	\$388	\$398
RE-ARD2-1552-??	15	52	3	\$394	\$405
RE-ARD2-1554-??	15	54	3	\$401	\$411
RE-ARD2-1556-??	15	56	3	\$407	\$417
RE-ARD2-1558-??	15	58	3	\$414	\$424
RE-ARD2-1560-??	15	60	3	\$420	\$430
RE-ARD2-1562-??	15	62	3	\$426	\$437
RE-ARD2-1564-??	15	64	3	\$433	\$443
RE-ARD2-1566-??	15	66	3	\$439	\$449
RE-ARD2-1568-??	15	68	3	\$446	\$456
RE-ARD2-1570-??	15	70	3	\$452	\$462
RE-ARD2-1572-??	15	72	3	\$466	\$479
RE-ARD2-1574-??	15	74	3	\$476	\$489
RE-ARD2-1576-??	15	76	3	\$487	\$499
RE-ARD2-1578-??	15	78	3	\$497	\$510
RE-ARD2-1580-??	15	80	3	\$507	\$520
RE-ARD2-1582-??	15	82	3	\$517	\$530
RE-ARD2-1584-??	15	84	3	\$528	\$540
RE-ARD2-1586-??	15	86	3	\$538	\$551

- Panels are cut exact to size.
- Rounded corners have a 2" radius.
- Clips and mounting hardware sold separately.

Acrylic Panels - Panel Only

1/4" Thick - Square Corners

18" High

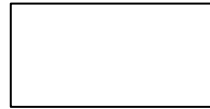

Model Number	Height	Length	Required Number of Clips	Clear (CL)	Frosted (FR)
RE-ASQ4-1818-??	18	18	2	\$214	\$230
RE-ASQ4-1820-??	18	20	2	\$228	\$232
RE-ASQ4-1822-??	18	22	2	\$242	\$246
RE-ASQ4-1824-??	18	24	2	\$256	\$261
RE-ASQ4-1826-??	18	26	2	\$262	\$268
RE-ASQ4-1828-??	18	28	2	\$269	\$274
RE-ASQ4-1830-??	18	30	2	\$275	\$280
RE-ASQ4-1832-??	18	32	2	\$282	\$287
RE-ASQ4-1834-??	18	34	2	\$288	\$293
RE-ASQ4-1836-??	18	36	2	\$298	\$305
RE-ASQ4-1838-??	18	38	2	\$311	\$319
RE-ASQ4-1840-??	18	40	2	\$324	\$333
RE-ASQ4-1842-??	18	42	2	\$337	\$347
RE-ASQ4-1844-??	18	44	2	\$350	\$361
RE-ASQ4-1846-??	18	46	2	\$362	\$375
RE-ASQ4-1848-??	18	48	3	\$382	\$392
RE-ASQ4-1850-??	18	50	3	\$388	\$398
RE-ASQ4-1852-??	18	52	3	\$394	\$405
RE-ASQ4-1854-??	18	54	3	\$401	\$411
RE-ASQ4-1856-??	18	56	3	\$407	\$417
RE-ASQ4-1858-??	18	58	3	\$414	\$424
RE-ASQ4-1860-??	18	60	3	\$420	\$430
RE-ASQ4-1862-??	18	62	3	\$426	\$437
RE-ASQ4-1864-??	18	64	3	\$433	\$443
RE-ASQ4-1866-??	18	66	3	\$439	\$449
RE-ASQ4-1868-??	18	68	3	\$446	\$456
RE-ASQ4-1870-??	18	70	3	\$452	\$462
RE-ASQ4-1872-??	18	72	3	\$466	\$479
RE-ASQ4-1874-??	18	74	3	\$476	\$489
RE-ASQ4-1876-??	18	76	3	\$487	\$499
RE-ASQ4-1878-??	18	78	3	\$497	\$510
RE-ASQ4-1880-??	18	80	3	\$507	\$520
RE-ASQ4-1882-??	18	82	3	\$517	\$530
RE-ASQ4-1884-??	18	84	3	\$528	\$540
RE-ASQ4-1886-??	18	86	3	\$538	\$551

- Panels are cut exact to size.
- Square corners have a slight radius.
- Clips and mounting hardware sold separately.

Acrylic Panels - Panel Only

1/4" Thick - Rounded Corners

18" High



Radius All Four Corners

Model Number	Height	Length	Required Number of Clips	Clear (CL)	Frosted (FR)
RE-ARD4-1818-??	18	18	2	\$214	\$218
RE-ARD4-1820-??	18	20	2	\$228	\$232
RE-ARD4-1822-??	18	22	2	\$242	\$246
RE-ARD4-1824-??	18	24	2	\$256	\$261
RE-ARD4-1826-??	18	26	2	\$262	\$268
RE-ARD4-1828-??	18	28	2	\$269	\$274
RE-ARD4-1830-??	18	30	2	\$275	\$280
RE-ARD4-1832-??	18	32	2	\$282	\$287
RE-ARD4-1834-??	18	34	2	\$288	\$293
RE-ARD4-1836-??	18	36	2	\$298	\$305
RE-ARD4-1838-??	18	38	2	\$311	\$319
RE-ARD4-1840-??	18	40	2	\$324	\$333
RE-ARD4-1842-??	18	42	2	\$337	\$347
RE-ARD4-1844-??	18	44	2	\$350	\$361
RE-ARD4-1846-??	18	46	2	\$362	\$375
RE-ARD4-1848-??	18	48	3	\$382	\$392
RE-ARD4-1850-??	18	50	3	\$388	\$398
RE-ARD4-1852-??	18	52	3	\$394	\$405
RE-ARD4-1854-??	18	54	3	\$401	\$411
RE-ARD4-1856-??	18	56	3	\$407	\$417
RE-ARD4-1858-??	18	58	3	\$414	\$424
RE-ARD4-1860-??	18	60	3	\$420	\$430
RE-ARD4-1862-??	18	62	3	\$426	\$437
RE-ARD4-1864-??	18	64	3	\$433	\$443
RE-ARD4-1866-??	18	66	3	\$439	\$449
RE-ARD4-1868-??	18	68	3	\$446	\$456
RE-ARD4-1870-??	18	70	3	\$452	\$462
RE-ARD4-1872-??	18	72	3	\$466	\$479
RE-ARD4-1874-??	18	74	3	\$476	\$489
RE-ARD4-1876-??	18	76	3	\$487	\$499
RE-ARD4-1878-??	18	78	3	\$497	\$510
RE-ARD4-1880-??	18	80	3	\$507	\$520
RE-ARD4-1882-??	18	82	3	\$517	\$530
RE-ARD4-1884-??	18	84	3	\$528	\$540
RE-ARD4-1886-??	18	86	3	\$538	\$551

- Panels are cut exact to size.
- Rounded corners have a 2" radius.
- Clips and mounting hardware sold separately.

Acrylic Panels - Panel Only

1/4" Thick - Rounded Corners
18" High



Radius Top Two Corners

Model Number	Height	Length	Required Number of Clips	Clear (CL)	Frosted (FR)
RE-ARD2-1818-??	18	18	2	\$214	\$218
RE-ARD2-1820-??	18	20	2	\$228	\$232
RE-ARD2-1822-??	18	22	2	\$242	\$246
RE-ARD2-1824-??	18	24	2	\$256	\$261
RE-ARD2-1826-??	18	26	2	\$262	\$268
RE-ARD2-1828-??	18	28	2	\$269	\$274
RE-ARD2-1830-??	18	30	2	\$275	\$280
RE-ARD2-1832-??	18	32	2	\$282	\$287
RE-ARD2-1834-??	18	34	2	\$288	\$293
RE-ARD2-1836-??	18	36	2	\$298	\$305
RE-ARD2-1838-??	18	38	2	\$311	\$319
RE-ARD2-1840-??	18	40	2	\$324	\$333
RE-ARD2-1842-??	18	42	2	\$337	\$347
RE-ARD2-1844-??	18	44	2	\$350	\$361
RE-ARD2-1846-??	18	46	2	\$362	\$375
RE-ARD2-1848-??	18	48	3	\$382	\$392
RE-ARD2-1850-??	18	50	3	\$388	\$398
RE-ARD2-1852-??	18	52	3	\$394	\$405
RE-ARD2-1854-??	18	54	3	\$401	\$411
RE-ARD2-1856-??	18	56	3	\$407	\$417
RE-ARD2-1858-??	18	58	3	\$414	\$424
RE-ARD2-1860-??	18	60	3	\$420	\$430
RE-ARD2-1862-??	18	62	3	\$426	\$437
RE-ARD2-1864-??	18	64	3	\$433	\$443
RE-ARD2-1866-??	18	66	3	\$439	\$449
RE-ARD2-1868-??	18	68	3	\$446	\$456
RE-ARD2-1870-??	18	70	3	\$452	\$462
RE-ARD2-1872-??	18	72	3	\$466	\$479
RE-ARD2-1874-??	18	74	3	\$476	\$489
RE-ARD2-1876-??	18	76	3	\$487	\$499
RE-ARD2-1878-??	18	78	3	\$497	\$510
RE-ARD2-1880-??	18	80	3	\$507	\$520
RE-ARD2-1882-??	18	82	3	\$517	\$530
RE-ARD2-1884-??	18	84	3	\$528	\$540
RE-ARD2-1886-??	18	86	3	\$538	\$551

- Panels are cut exact to size.
- Rounded corners have a 2" radius.
- Clips and mounting hardware sold separately.

Acrylic Panels - Panel Only

1/4" Thick - Square Corners
24" High



Model Number	Height	Length	Required Number of Clips	Clear (CL)	Frosted (FR)
RE-ASQ4-2418-??	24	18	2	\$214	\$218
RE-ASQ4-2420-??	24	20	2	\$228	\$232
RE-ASQ4-2422-??	24	22	2	\$242	\$246
RE-ASQ4-2424-??	24	24	2	\$256	\$261
RE-ASQ4-2426-??	24	26	2	\$262	\$268
RE-ASQ4-2428-??	24	28	2	\$269	\$274
RE-ASQ4-2430-??	24	30	2	\$275	\$280
RE-ASQ4-2432-??	24	32	2	\$282	\$287
RE-ASQ4-2434-??	24	34	2	\$288	\$293
RE-ASQ4-2436-??	24	36	2	\$298	\$305
RE-ASQ4-2438-??	24	38	2	\$311	\$319
RE-ASQ4-2440-??	24	40	2	\$324	\$333
RE-ASQ4-2442-??	24	42	2	\$337	\$347
RE-ASQ4-2444-??	24	44	2	\$350	\$361
RE-ASQ4-2446-??	24	46	2	\$362	\$375
RE-ASQ4-2448-??	24	48	3	\$382	\$392
RE-ASQ4-2450-??	24	50	3	\$388	\$398
RE-ASQ4-2452-??	24	52	3	\$394	\$405
RE-ASQ4-2454-??	24	54	3	\$401	\$411
RE-ASQ4-2456-??	24	56	3	\$407	\$417
RE-ASQ4-2458-??	24	58	3	\$414	\$424
RE-ASQ4-2460-??	24	60	3	\$420	\$430
RE-ASQ4-2462-??	24	62	3	\$426	\$437
RE-ASQ4-2464-??	24	64	3	\$433	\$443
RE-ASQ4-2466-??	24	66	3	\$439	\$449
RE-ASQ4-2468-??	24	68	3	\$446	\$456
RE-ASQ4-2470-??	24	70	3	\$452	\$462
RE-ASQ4-2472-??	24	72	4	\$466	\$479
RE-ASQ4-2474-??	24	74	4	\$476	\$489
RE-ASQ4-2476-??	24	76	4	\$487	\$499
RE-ASQ4-2478-??	24	78	4	\$497	\$510
RE-ASQ4-2480-??	24	80	4	\$507	\$520
RE-ASQ4-2482-??	24	82	4	\$517	\$530
RE-ASQ4-2484-??	24	84	4	\$528	\$540
RE-ASQ4-2486-??	24	86	4	\$538	\$551

- 24" high panels are actually 23-1/2" high, lengths are cut exact to size.
- Square corners have a slight radius.
- Clips and mounting hardware sold separately.

Acrylic Panels - Panel Only

1/4" Thick - Rounded Corners
24" High

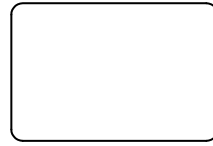

Radius All Four Corners

Model Number	Height	Length	Required Number of Clips	Clear (CL)	Frosted (FR)
RE-ARD4-2418-??	24	18	2	\$214	\$218
RE-ARD4-2420-??	24	20	2	\$228	\$232
RE-ARD4-2422-??	24	22	2	\$242	\$246
RE-ARD4-2424-??	24	24	2	\$256	\$261
RE-ARD4-2426-??	24	26	2	\$262	\$268
RE-ARD4-2428-??	24	28	2	\$269	\$274
RE-ARD4-2430-??	24	30	2	\$275	\$280
RE-ARD4-2432-??	24	32	2	\$282	\$287
RE-ARD4-2434-??	24	34	2	\$288	\$293
RE-ARD4-2436-??	24	36	2	\$298	\$305
RE-ARD4-2438-??	24	38	2	\$311	\$319
RE-ARD4-2440-??	24	40	2	\$324	\$333
RE-ARD4-2442-??	24	42	2	\$337	\$347
RE-ARD4-2444-??	24	44	2	\$350	\$361
RE-ARD4-2446-??	24	46	2	\$362	\$375
RE-ARD4-2448-??	24	48	3	\$382	\$392
RE-ARD4-2450-??	24	50	3	\$388	\$398
RE-ARD4-2452-??	24	52	3	\$394	\$405
RE-ARD4-2454-??	24	54	3	\$401	\$411
RE-ARD4-2456-??	24	56	3	\$407	\$417
RE-ARD4-2458-??	24	58	3	\$414	\$424
RE-ARD4-2460-??	24	60	3	\$420	\$430
RE-ARD4-2462-??	24	62	3	\$426	\$437
RE-ARD4-2464-??	24	64	3	\$433	\$443
RE-ARD4-2466-??	24	66	3	\$439	\$449
RE-ARD4-2468-??	24	68	3	\$446	\$456
RE-ARD4-2470-??	24	70	3	\$452	\$462
RE-ARD4-2472-??	24	72	4	\$466	\$479
RE-ARD4-2474-??	24	74	4	\$476	\$489
RE-ARD4-2476-??	24	76	4	\$487	\$499
RE-ARD4-2478-??	24	78	4	\$497	\$510
RE-ARD4-2480-??	24	80	4	\$507	\$520
RE-ARD4-2482-??	24	82	4	\$517	\$530
RE-ARD4-2484-??	24	84	4	\$528	\$540
RE-ARD4-2486-??	24	86	4	\$538	\$551

- 24" high panels are actually 23-1/2" high, lengths are cut exact to size.
- Rounded corners have a 2" radius.
- Clips and mounting hardware sold separately.

Acrylic Panels - Panel Only

1/4" Thick - Rounded Corners
24" High

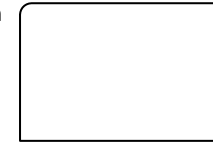

Radius Top Two Corners

Model Number	Height	Length	Required Number of Clips	Clear (CL)	Frosted (FR)
RE-ARD2-2418-??	24	18	2	\$214	\$218
RE-ARD2-2420-??	24	20	2	\$228	\$232
RE-ARD2-2422-??	24	22	2	\$242	\$246
RE-ARD2-2424-??	24	24	2	\$256	\$261
RE-ARD2-2426-??	24	26	2	\$262	\$268
RE-ARD2-2428-??	24	28	2	\$269	\$274
RE-ARD2-2430-??	24	30	2	\$275	\$280
RE-ARD2-2432-??	24	32	2	\$282	\$287
RE-ARD2-2434-??	24	34	2	\$288	\$293
RE-ARD2-2436-??	24	36	2	\$298	\$305
RE-ARD2-2438-??	24	38	2	\$311	\$319
RE-ARD2-2440-??	24	40	2	\$324	\$333
RE-ARD2-2442-??	24	42	2	\$337	\$347
RE-ARD2-2444-??	24	44	2	\$350	\$361
RE-ARD2-2446-??	24	46	2	\$362	\$375
RE-ARD2-2448-??	24	48	3	\$382	\$392
RE-ARD2-2450-??	24	50	3	\$388	\$398
RE-ARD2-2452-??	24	52	3	\$394	\$405
RE-ARD2-2454-??	24	54	3	\$401	\$411
RE-ARD2-2456-??	24	56	3	\$407	\$417
RE-ARD2-2458-??	24	58	3	\$414	\$424
RE-ARD2-2460-??	24	60	3	\$420	\$430
RE-ARD2-2462-??	24	62	3	\$426	\$437
RE-ARD2-2464-??	24	64	3	\$433	\$443
RE-ARD2-2466-??	24	66	3	\$439	\$449
RE-ARD2-2468-??	24	68	3	\$446	\$456
RE-ARD2-2470-??	24	70	3	\$452	\$462
RE-ARD2-2472-??	24	72	4	\$466	\$479
RE-ARD2-2474-??	24	74	4	\$476	\$489
RE-ARD2-2476-??	24	76	4	\$487	\$499
RE-ARD2-2478-??	24	78	4	\$497	\$510
RE-ARD2-2480-??	24	80	4	\$507	\$520
RE-ARD2-2482-??	24	82	4	\$517	\$530
RE-ARD2-2484-??	24	84	4	\$528	\$540
RE-ARD2-2486-??	24	86	4	\$538	\$551

- 24" high panels are actually 23-1/2" high, lengths are cut exact to size.
- Rounded corners have a 2" radius.
- Clips and mounting hardware sold separately.

Acrylic Panels - Panel Only

1/4" Thick - Square Corners
30" High



Model Number	Height	Length	Required Number of Clips	Clear (CL)	Frosted (FR)
RE-ASQ4-3018-??	30	18	2	\$256	\$261
RE-ASQ4-3020-??	30	20	2	\$297	\$305
RE-ASQ4-3022-??	30	22	2	\$338	\$348
RE-ASQ4-3024-??	30	24	2	\$382	\$392
RE-ASQ4-3026-??	30	26	2	\$392	\$402
RE-ASQ4-3028-??	30	28	2	\$402	\$412
RE-ASQ4-3030-??	30	30	2	\$412	\$423
RE-ASQ4-3032-??	30	32	2	\$423	\$433
RE-ASQ4-3034-??	30	34	2	\$433	\$443
RE-ASQ4-3036-??	30	36	2	\$443	\$453
RE-ASQ4-3038-??	30	38	2	\$453	\$464
RE-ASQ4-3040-??	30	40	2	\$464	\$474
RE-ASQ4-3042-??	30	42	3	\$474	\$484
RE-ASQ4-3044-??	30	44	3	\$484	\$494
RE-ASQ4-3046-??	30	46	3	\$494	\$504
RE-ASQ4-3048-??	30	48	3	\$507	\$524
RE-ASQ4-3050-??	30	50	3	\$517	\$534
RE-ASQ4-3052-??	30	52	3	\$528	\$544
RE-ASQ4-3054-??	30	54	3	\$538	\$554
RE-ASQ4-3056-??	30	56	3	\$548	\$565
RE-ASQ4-3058-??	30	58	3	\$558	\$575
RE-ASQ4-3060-??	30	60	4	\$569	\$585
RE-ASQ4-3062-??	30	62	4	\$579	\$595
RE-ASQ4-3064-??	30	64	4	\$589	\$606
RE-ASQ4-3066-??	30	66	4	\$599	\$616
RE-ASQ4-3068-??	30	68	4	\$609	\$626
RE-ASQ4-3070-??	30	70	4	\$620	\$636
RE-ASQ4-3072-??	30	72	4	\$634	\$654
RE-ASQ4-3074-??	30	74	5	\$644	\$665
RE-ASQ4-3076-??	30	76	5	\$654	\$675
RE-ASQ4-3078-??	30	78	5	\$665	\$685
RE-ASQ4-3080-??	30	80	5	\$675	\$695
RE-ASQ4-3082-??	30	82	5	\$685	\$706
RE-ASQ4-3084-??	30	84	5	\$695	\$716
RE-ASQ4-3086-??	30	86	5	\$706	\$726

- Panels are cut exact to size.
- Square corners have a slight radius.
- Clips and mounting hardware sold separately.

Acrylic Panels - Panel Only

1/4" Thick - Rounded Corners
30" High

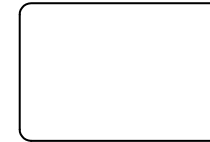

Radius All Four Corners

Model Number	Height	Length	Required Number of Clips	Clear (CL)	Frosted (FR)
RE-ARD4-3018-??	30	18	2	\$256	\$261
RE-ARD4-3020-??	30	20	2	\$297	\$305
RE-ARD4-3022-??	30	22	2	\$338	\$348
RE-ARD4-3024-??	30	24	2	\$382	\$392
RE-ARD4-3026-??	30	26	2	\$392	\$402
RE-ARD4-3028-??	30	28	2	\$402	\$412
RE-ARD4-3030-??	30	30	2	\$412	\$423
RE-ARD4-3032-??	30	32	2	\$423	\$433
RE-ARD4-3034-??	30	34	2	\$433	\$443
RE-ARD4-3036-??	30	36	2	\$443	\$453
RE-ARD4-3038-??	30	38	2	\$453	\$464
RE-ARD4-3040-??	30	40	2	\$464	\$474
RE-ARD4-3042-??	30	42	3	\$474	\$484
RE-ARD4-3044-??	30	44	3	\$484	\$494
RE-ARD4-3046-??	30	46	3	\$494	\$504
RE-ARD4-3048-??	30	48	3	\$507	\$524
RE-ARD4-3050-??	30	50	3	\$517	\$534
RE-ARD4-3052-??	30	52	3	\$528	\$544
RE-ARD4-3054-??	30	54	3	\$538	\$554
RE-ARD4-3056-??	30	56	3	\$548	\$565
RE-ARD4-3058-??	30	58	3	\$558	\$575
RE-ARD4-3060-??	30	60	4	\$56	\$585
RE-ARD4-3062-??	30	62	4	\$579	\$595
RE-ARD4-3064-??	30	64	4	\$589	\$606
RE-ARD4-3066-??	30	66	4	\$599	\$616
RE-ARD4-3068-??	30	68	4	\$609	\$616
RE-ARD4-3070-??	30	70	4	\$620	\$636
RE-ARD4-3072-??	30	72	4	\$634	\$654
RE-ARD4-3074-??	30	74	5	\$644	\$665
RE-ARD4-3076-??	30	76	5	\$654	\$675
RE-ARD4-3078-??	30	78	5	\$665	\$685
RE-ARD4-3080-??	30	80	5	\$675	\$695
RE-ARD4-3082-??	30	82	5	\$685	\$706
RE-ARD4-3084-??	30	84	5	\$695	\$716
RE-ARD4-3086-??	30	86	5	\$706	\$726

- Panels are cut exact to size.
- Rounded corners have a 2" radius.
- Clips and mounting hardware sold separately.

Acrylic Panels - Panel Only

1/4" Thick - Rounded Corners
30" High



Radius Top Two Corners

Model Number	Height	Length	Required Number of Clips	Clear (CL)	Frosted (FR)
RE-ARD2-3018-??	30	18	2	\$256	\$261
RE-ARD2-3020-??	30	20	2	\$297	\$305
RE-ARD2-3022-??	30	22	2	\$338	\$348
RE-ARD2-3024-??	30	24	2	\$382	\$392
RE-ARD2-3026-??	30	26	2	\$392	\$402
RE-ARD2-3028-??	30	28	2	\$402	\$412
RE-ARD2-3030-??	30	30	2	\$412	\$423
RE-ARD2-3032-??	30	32	2	\$423	\$433
RE-ARD2-3034-??	30	34	2	\$433	\$443
RE-ARD2-3036-??	30	36	2	\$443	\$453
RE-ARD2-3038-??	30	38	2	\$453	\$464
RE-ARD2-3040-??	30	40	2	\$464	\$474
RE-ARD2-3042-??	30	42	3	\$474	\$484
RE-ARD2-3044-??	30	44	3	\$484	\$494
RE-ARD2-3046-??	30	46	3	\$494	\$504
RE-ARD2-3048-??	30	48	3	\$507	\$524
RE-ARD2-3050-??	30	50	3	\$517	\$534
RE-ARD2-3052-??	30	52	3	\$528	\$544
RE-ARD2-3054-??	30	54	3	\$538	\$554
RE-ARD2-3056-??	30	56	3	\$548	\$565
RE-ARD2-3058-??	30	58	3	\$558	\$575
RE-ARD2-3060-??	30	60	4	\$569	\$585
RE-ARD2-3062-??	30	62	4	\$579	\$595
RE-ARD2-3064-??	30	64	4	\$589	\$606
RE-ARD2-3066-??	30	66	4	\$599	\$616
RE-ARD2-3068-??	30	68	4	\$609	\$626
RE-ARD2-3070-??	30	70	4	\$620	\$636
RE-ARD2-3072-??	30	72	4	\$634	\$654
RE-ARD2-3074-??	30	74	5	\$644	\$665
RE-ARD2-3076-??	30	76	5	\$654	\$675
RE-ARD2-3078-??	30	78	5	\$665	\$685
RE-ARD2-3080-??	30	80	5	\$675	\$695
RE-ARD2-3082-??	30	82	5	\$685	\$706
RE-ARD2-3084-??	30	84	5	\$695	\$716
RE-ARD2-3086-??	30	86	5	\$706	\$726

- Panels are cut exact to size.
- Rounded corners have a 2" radius.
- Clips and mounting hardware sold separately.

Acrylic Panels - Panel Only

3/8" Thick - Square Corners
36" High



Model Number	Height	Length	Required Number of Clips	Clear (CL)
RE-A2Q4-3618-CL	36	18	2	\$549
RE-A2Q4-3620-CL	36	20	2	\$593
RE-A2Q4-3622-CL	36	22	2	\$636
RE-A2Q4-3624-CL	36	24	2	\$681
RE-A2Q4-3626-CL	36	26	2	\$725
RE-A2Q4-3628-CL	36	28	2	\$768
RE-A2Q4-3630-CL	36	30	2	\$812
RE-A2Q4-3632-CL	36	32	3	\$855
RE-A2Q4-3634-CL	36	34	3	\$899
RE-A2Q4-3636-CL	36	36	3	\$944
RE-A2Q4-3638-CL	36	38	3	\$987
RE-A2Q4-3640-CL	36	40	3	\$1,031
RE-A2Q4-3642-CL	36	42	3	\$1,074
RE-A2Q4-3644-CL	36	44	3	\$1,118
RE-A2Q4-3646-CL	36	46	3	\$1,161
RE-A2Q4-3648-CL	36	48	4	\$1,206
RE-A2Q4-3650-CL	36	50	4	\$1,250
RE-A2Q4-3652-CL	36	52	4	\$1,293
RE-A2Q4-3654-CL	36	54	4	\$1,337
RE-A2Q4-3656-CL	36	56	4	\$1,380
RE-A2Q4-3658-CL	36	58	4	\$1,424
RE-A2Q4-3660-CL	36	60	4	\$1,469
RE-A2Q4-3662-CL	36	62	4	\$1,512
RE-A2Q4-3664-CL	36	64	4	\$1,556
RE-A2Q4-3666-CL	36	66	5	\$1,599
RE-A2Q4-3668-CL	36	68	5	\$1,643
RE-A2Q4-3670-CL	36	70	5	\$1,688
RE-A2Q4-3672-CL	36	72	5	\$1,731
RE-A2Q4-3674-CL	36	74	5	\$1,775
RE-A2Q4-3676-CL	36	76	5	\$1,818
RE-A2Q4-3678-CL	36	78	5	\$1,862
RE-A2Q4-3680-CL	36	80	5	\$1,905
RE-A2Q4-3682-CL	36	82	6	\$1,950
RE-A2Q4-3684-CL	36	84	6	\$1,994
RE-A2Q4-3686-CL	36	86	6	\$2,037

- Panels are cut exact to size.
- Square corners have a slight radius.
- Clips and mounting hardware sold separately.

Glass Panels - Panel Only

1/4" Thick - Square Corners

6" High

Model Number	Height	Length	Required Number of Clips	Clear Low Iron (LW)	Acid Etched (ET)
RE-G2Q4-0618-??	6	18	2	\$195	\$227
RE-G2Q4-0620-??	6	20	2	\$201	\$234
RE-G2Q4-0622-??	6	22	2	\$210	\$238
RE-G2Q4-0624-??	6	24	2	\$219	\$241
RE-G2Q4-0626-??	6	26	2	\$225	\$245
RE-G2Q4-0628-??	6	28	2	\$229	\$248
RE-G2Q4-0630-??	6	30	2	\$233	\$256
RE-G2Q4-0632-??	6	32	2	\$237	\$260
RE-G2Q4-0634-??	6	34	2	\$245	\$262
RE-G2Q4-0636-??	6	36	2	\$250	\$271
RE-G2Q4-0638-??	6	38	2	\$254	\$274
RE-G2Q4-0640-??	6	40	2	\$259	\$278
RE-G2Q4-0642-??	6	42	2	\$264	\$282
RE-G2Q4-0644-??	6	44	2	\$268	\$286
RE-G2Q4-0646-??	6	46	2	\$270	\$288
RE-G2Q4-0648-??	6	48	2	\$277	\$292
RE-G2Q4-0650-??	6	50	3	\$286	\$300
RE-G2Q4-0652-??	6	52	3	\$293	\$303
RE-G2Q4-0654-??	6	54	3	\$297	\$307
RE-G2Q4-0656-??	6	56	3	\$306	\$315
RE-G2Q4-0658-??	6	58	3	\$315	\$323
RE-G2Q4-0660-??	6	60	3	\$324	\$330
RE-G2Q4-0662-??	6	62	3	\$330	\$343
RE-G2Q4-0664-??	6	64	3	\$339	\$351
RE-G2Q4-0666-??	6	66	3	\$346	\$362
RE-G2Q4-0668-??	6	68	3	\$353	\$370
RE-G2Q4-0670-??	6	70	3	\$360	\$387
RE-G2Q4-0672-??	6	72	3	\$369	\$394
RE-G2Q4-0674-??	6	74	3	\$375	\$402
RE-G2Q4-0676-??	6	76	3	\$380	\$419
RE-G2Q4-0678-??	6	78	3	\$387	\$426
RE-G2Q4-0680-??	6	80	3	\$392	\$435
RE-G2Q4-0682-??	6	82	3	\$399	\$451
RE-G2Q4-0684-??	6	84	3	\$408	\$460

- Glass panels are 1/4" thick.
- Panels are cut exact to size.
- Edges are flat and polished.
- Not available with rounded corners.
- Clips and mounting hardware sold separately.

Glass Panels - Panel Only

1/4" Thick - Square Corners

8" High

Model Number	Height	Length	Required Number of Clips	Clear Low Iron (LW)	Acid Etched (ET)
RE-G2Q4-0686-??	6	86	3	\$416	\$467
RE-G2Q4-0818-??	8	18	2	\$202	\$224
RE-G2Q4-0820-??	8	20	2	\$209	\$225
RE-G2Q4-0822-??	8	22	2	\$222	\$236
RE-G2Q4-0824-??	8	24	2	\$229	\$238
RE-G2Q4-0826-??	8	26	2	\$234	\$239
RE-G2Q4-0828-??	8	28	2	\$238	\$246
RE-G2Q4-0830-??	8	30	2	\$243	\$252
RE-G2Q4-0832-??	8	32	2	\$255	\$259
RE-G2Q4-0834-??	8	34	2	\$260	\$264
RE-G2Q4-0836-??	8	36	2	\$266	\$270
RE-G2Q4-0838-??	8	38	2	\$278	\$286
RE-G2Q4-0840-??	8	40	2	\$289	\$296
RE-G2Q4-0842-??	8	42	2	\$301	\$306
RE-G2Q4-0844-??	8	44	2	\$307	\$316
RE-G2Q4-0846-??	8	46	2	\$319	\$327
RE-G2Q4-0848-??	8	48	2	\$329	\$338
RE-G2Q4-0850-??	8	50	3	\$341	\$348
RE-G2Q4-0852-??	8	52	3	\$347	\$359
RE-G2Q4-0854-??	8	54	3	\$359	\$369
RE-G2Q4-0856-??	8	56	3	\$365	\$379
RE-G2Q4-0858-??	8	58	3	\$376	\$389
RE-G2Q4-0860-??	8	60	3	\$388	\$408
RE-G2Q4-0862-??	8	62	3	\$398	\$419
RE-G2Q4-0864-??	8	64	3	\$410	\$430
RE-G2Q4-0866-??	8	66	3	\$421	\$440
RE-G2Q4-0868-??	8	68	3	\$433	\$451
RE-G2Q4-0870-??	8	70	3	\$444	\$461
RE-G2Q4-0872-??	8	72	3	\$455	\$480
RE-G2Q4-0874-??	8	74	3	\$460	\$490
RE-G2Q4-0876-??	8	76	3	\$471	\$510
RE-G2Q4-0878-??	8	78	3	\$483	\$520
RE-G2Q4-0880-??	8	80	3	\$493	\$539
RE-G2Q4-0882-??	8	82	3	\$504	\$549
RE-G2Q4-0884-??	8	84	3	\$516	\$561

- Glass panels are 1/4" thick.
- Panels are cut exact to size.
- Edges are flat and polished.
- Not available with rounded corners.
- Clips and mounting hardware sold separately.

Glass Panels - Panel Only

1/4" Thick - Square Corners

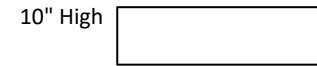

Model Number	Height	Length	Required Number of Clips	Clear Low Iron (LW)	Acid Etched (ET)
RE-G2Q4-0886-??	8	86	3	\$526	\$571
RE-G2Q4-1018-??	10	18	2	\$216	\$238
RE-G2Q4-1020-??	10	20	2	\$227	\$243
RE-G2Q4-1022-??	10	22	2	\$237	\$256
RE-G2Q4-1024-??	10	24	2	\$246	\$261
RE-G2Q4-1026-??	10	26	2	\$256	\$265
RE-G2Q4-1028-??	10	28	2	\$260	\$269
RE-G2Q4-1030-??	10	30	2	\$270	\$283
RE-G2Q4-1032-??	10	32	2	\$286	\$296
RE-G2Q4-1034-??	10	34	2	\$295	\$309
RE-G2Q4-1036-??	10	36	2	\$310	\$321
RE-G2Q4-1038-??	10	38	2	\$319	\$334
RE-G2Q4-1040-??	10	40	2	\$334	\$348
RE-G2Q4-1042-??	10	42	2	\$344	\$361
RE-G2Q4-1044-??	10	44	2	\$359	\$374
RE-G2Q4-1046-??	10	46	2	\$369	\$387
RE-G2Q4-1048-??	10	48	2	\$378	\$401
RE-G2Q4-1050-??	10	50	3	\$393	\$414
RE-G2Q4-1052-??	10	52	3	\$403	\$426
RE-G2Q4-1054-??	10	54	3	\$412	\$439
RE-G2Q4-1056-??	10	56	3	\$419	\$452
RE-G2Q4-1058-??	10	58	3	\$423	\$466
RE-G2Q4-1060-??	10	60	3	\$432	\$479
RE-G2Q4-1062-??	10	62	3	\$437	\$492
RE-G2Q4-1064-??	10	64	3	\$444	\$504
RE-G2Q4-1066-??	10	66	3	\$458	\$526
RE-G2Q4-1068-??	10	68	3	\$472	\$539
RE-G2Q4-1070-??	10	70	3	\$487	\$553
RE-G2Q4-1072-??	10	72	3	\$501	\$566
RE-G2Q4-1074-??	10	74	3	\$515	\$579
RE-G2Q4-1076-??	10	76	3	\$529	\$601
RE-G2Q4-1078-??	10	78	3	\$542	\$613
RE-G2Q4-1080-??	10	80	3	\$556	\$626
RE-G2Q4-1082-??	10	82	3	\$570	\$640
RE-G2Q4-1084-??	10	84	3	\$584	\$653

- Glass panels are 1/4" thick.
- Panels are cut exact to size.
- Edges are flat and polished.
- Not available with rounded corners.
- Clips and mounting hardware sold separately.

Glass Panels - Panel Only

1/4" Thick - Square Corners



Model Number	Height	Length	Required Number of Clips	Clear Low Iron (LW)	Acid Etched (ET)
RE-G2Q4-1086-??	10	86	3	\$598	\$666
RE-G2Q4-1218-??	12	18	2	\$222	\$228
RE-G2Q4-1220-??	12	20	2	\$229	\$243
RE-G2Q4-1222-??	12	22	2	\$236	\$259
RE-G2Q4-1224-??	12	24	2	\$250	\$275
RE-G2Q4-1226-??	12	26	2	\$257	\$291
RE-G2Q4-1228-??	12	28	2	\$261	\$306
RE-G2Q4-1230-??	12	30	2	\$278	\$321
RE-G2Q4-1232-??	12	32	2	\$296	\$338
RE-G2Q4-1234-??	12	34	2	\$309	\$353
RE-G2Q4-1236-??	12	36	2	\$327	\$369
RE-G2Q4-1238-??	12	38	2	\$339	\$384
RE-G2Q4-1240-??	12	40	2	\$357	\$401
RE-G2Q4-1242-??	12	42	2	\$375	\$416
RE-G2Q4-1244-??	12	44	2	\$393	\$432
RE-G2Q4-1246-??	12	46	2	\$411	\$447
RE-G2Q4-1248-??	12	48	2	\$415	\$464
RE-G2Q4-1250-??	12	50	3	\$423	\$479
RE-G2Q4-1252-??	12	52	3	\$434	\$494
RE-G2Q4-1254-??	12	54	3	\$451	\$510
RE-G2Q4-1256-??	12	56	3	\$467	\$526
RE-G2Q4-1258-??	12	58	3	\$484	\$542
RE-G2Q4-1260-??	12	60	3	\$501	\$557
RE-G2Q4-1262-??	12	62	3	\$517	\$572
RE-G2Q4-1264-??	12	64	3	\$534	\$589
RE-G2Q4-1266-??	12	66	3	\$551	\$604
RE-G2Q4-1268-??	12	68	3	\$567	\$620
RE-G2Q4-1270-??	12	70	3	\$584	\$635
RE-G2Q4-1272-??	12	72	3	\$601	\$659
RE-G2Q4-1274-??	12	74	3	\$617	\$676
RE-G2Q4-1276-??	12	76	3	\$634	\$691
RE-G2Q4-1278-??	12	78	3	\$650	\$707
RE-G2Q4-1280-??	12	80	3	\$667	\$722
RE-G2Q4-1282-??	12	82	3	\$684	\$739
RE-G2Q4-1284-??	12	84	3	\$700	\$763

- Glass panels are 1/4" thick.
- Panels are cut exact to size.
- Edges are flat and polished.
- Not available with rounded corners.
- Clips and mounting hardware sold separately.

Glass Panels - Panel Only

1/4" Thick - Square Corners

15" High



Model Number	Height	Length	Required Number of Clips	Clear Low Iron (LW)	Acid Etched (ET)
RE-G2Q4-1286-??	12	86	3	\$717	\$779
RE-G2Q4-1518-??	15	18	2	\$232	\$262
RE-G2Q4-1520-??	15	20	2	\$239	\$283
RE-G2Q4-1522-??	15	22	2	\$261	\$302
RE-G2Q4-1524-??	15	24	2	\$278	\$321
RE-G2Q4-1526-??	15	26	2	\$296	\$342
RE-G2Q4-1528-??	15	28	2	\$312	\$361
RE-G2Q4-1530-??	15	30	2	\$335	\$380
RE-G2Q4-1532-??	15	32	2	\$357	\$401
RE-G2Q4-1534-??	15	34	2	\$380	\$420
RE-G2Q4-1536-??	15	36	2	\$402	\$439
RE-G2Q4-1538-??	15	38	2	\$425	\$458
RE-G2Q4-1540-??	15	40	2	\$447	\$479
RE-G2Q4-1542-??	15	42	2	\$453	\$507
RE-G2Q4-1544-??	15	44	2	\$475	\$526
RE-G2Q4-1546-??	15	46	2	\$480	\$545
RE-G2Q4-1548-??	15	48	2	\$501	\$575
RE-G2Q4-1550-??	15	50	3	\$521	\$594
RE-G2Q4-1552-??	15	52	3	\$542	\$613
RE-G2Q4-1554-??	15	54	3	\$563	\$633
RE-G2Q4-1556-??	15	56	3	\$584	\$662
RE-G2Q4-1558-??	15	58	3	\$604	\$681
RE-G2Q4-1560-??	15	60	3	\$626	\$700
RE-G2Q4-1562-??	15	62	3	\$647	\$720
RE-G2Q4-1564-??	15	64	3	\$667	\$740
RE-G2Q4-1566-??	15	66	3	\$688	\$768
RE-G2Q4-1568-??	15	68	3	\$709	\$787
RE-G2Q4-1570-??	15	70	3	\$730	\$816
RE-G2Q4-1572-??	15	72	3	\$750	\$836
RE-G2Q4-1574-??	15	74	3	\$772	\$855
RE-G2Q4-1576-??	15	76	3	\$793	\$884
RE-G2Q4-1578-??	15	78	3	\$813	\$903
RE-G2Q4-1580-??	15	80	3	\$834	\$923
RE-G2Q4-1582-??	15	82	3	\$855	\$951
RE-G2Q4-1584-??	15	84	3	\$876	\$971

- Glass panels are 1/4" thick.
- Panels are cut exact to size.
- Edges are flat and polished.
- Not available with rounded corners.
- Clips and mounting hardware sold separately.

Glass Panels - Panel Only

1/4" Thick - Square Corners

18" High



Model Number	Height	Length	Required Number of Clips	Clear Low Iron (LW)	Acid Etched (ET)
RE-G2Q4-1586-??	15	86	3	\$896	\$990
RE-G2Q4-1818-??	18	18	2	\$262	\$298
RE-G2Q4-1820-??	18	20	2	\$268	\$321
RE-G2Q4-1822-??	18	22	2	\$295	\$346
RE-G2Q4-1824-??	18	24	2	\$321	\$369
RE-G2Q4-1826-??	18	26	2	\$348	\$392
RE-G2Q4-1828-??	18	28	2	\$375	\$416
RE-G2Q4-1830-??	18	30	2	\$402	\$439
RE-G2Q4-1832-??	18	32	2	\$429	\$464
RE-G2Q4-1834-??	18	34	2	\$440	\$487
RE-G2Q4-1836-??	18	36	2	\$466	\$510
RE-G2Q4-1838-??	18	38	2	\$475	\$534
RE-G2Q4-1840-??	18	40	2	\$501	\$557
RE-G2Q4-1842-??	18	42	2	\$525	\$580
RE-G2Q4-1844-??	18	44	2	\$551	\$604
RE-G2Q4-1846-??	18	46	2	\$575	\$627
RE-G2Q4-1848-??	18	48	3	\$601	\$652
RE-G2Q4-1850-??	18	50	3	\$626	\$675
RE-G2Q4-1852-??	18	52	3	\$650	\$698
RE-G2Q4-1854-??	18	54	3	\$676	\$722
RE-G2Q4-1856-??	18	56	3	\$700	\$745
RE-G2Q4-1858-??	18	58	3	\$726	\$768
RE-G2Q4-1860-??	18	60	3	\$750	\$793
RE-G2Q4-1862-??	18	62	3	\$776	\$816
RE-G2Q4-1864-??	18	64	3	\$800	\$840
RE-G2Q4-1866-??	18	66	3	\$826	\$863
RE-G2Q4-1868-??	18	68	3	\$850	\$886
RE-G2Q4-1870-??	18	70	3	\$876	\$910
RE-G2Q4-1872-??	18	72	3	\$901	\$933
RE-G2Q4-1874-??	18	74	3	\$926	\$956
RE-G2Q4-1876-??	18	76	3	\$951	\$981
RE-G2Q4-1878-??	18	78	3	\$976	\$1,004
RE-G2Q4-1880-??	18	80	3	\$1,001	\$1,028
RE-G2Q4-1882-??	18	82	3	\$1,026	\$1,051
RE-G2Q4-1884-??	18	84	3	\$1,051	\$1,074

- Glass panels are 1/4" thick.
- Panels are cut exact to size.
- Edges are flat and polished.
- Not available with rounded corners.
- Clips and mounting hardware sold separately.

Glass Panels - Panel Only

1/4" Thick - Square Corners

24" High

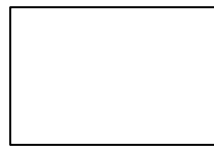

Model Number	Height	Length	Required Number of Clips	Clear Low Iron (LW)	Acid Etched (ET)
RE-G2Q4-1886-??	18	86	3	\$1,076	\$1,099
RE-G2Q4-2418-??	24	18	2	\$301	\$369
RE-G2Q4-2420-??	24	20	2	\$357	\$401
RE-G2Q4-2422-??	24	22	2	\$393	\$432
RE-G2Q4-2424-??	24	24	2	\$429	\$464
RE-G2Q4-2426-??	24	26	2	\$465	\$494
RE-G2Q4-2428-??	24	28	2	\$501	\$526
RE-G2Q4-2430-??	24	30	2	\$519	\$557
RE-G2Q4-2432-??	24	32	2	\$553	\$589
RE-G2Q4-2434-??	24	34	2	\$567	\$620
RE-G2Q4-2436-??	24	36	2	\$601	\$652
RE-G2Q4-2438-??	24	38	2	\$634	\$682
RE-G2Q4-2440-??	24	40	2	\$667	\$714
RE-G2Q4-2442-??	24	42	2	\$700	\$745
RE-G2Q4-2444-??	24	44	2	\$734	\$777
RE-G2Q4-2446-??	24	46	2	\$767	\$808
RE-G2Q4-2448-??	24	48	3	\$800	\$840
RE-G2Q4-2450-??	24	50	3	\$834	\$871
RE-G2Q4-2452-??	24	52	3	\$867	\$903
RE-G2Q4-2454-??	24	54	3	\$901	\$933
RE-G2Q4-2456-??	24	56	3	\$935	\$965
RE-G2Q4-2458-??	24	58	3	\$968	\$996
RE-G2Q4-2460-??	24	60	3	\$1,001	\$1,028
RE-G2Q4-2462-??	24	62	3	\$1,035	\$1,059
RE-G2Q4-2464-??	24	64	3	\$1,068	\$1,091
RE-G2Q4-2466-??	24	66	3	\$1,101	\$1,122
RE-G2Q4-2468-??	24	68	3	\$1,134	\$1,154
RE-G2Q4-2470-??	24	70	3	\$1,168	\$1,184
RE-G2Q4-2472-??	24	72	4	\$1,201	\$1,216
RE-G2Q4-2474-??	24	74	4	\$1,234	\$1,247
RE-G2Q4-2476-??	24	76	4	\$1,268	\$1,279
RE-G2Q4-2478-??	24	78	4	\$1,288	\$1,310
RE-G2Q4-2480-??	24	80	4	\$1,298	\$1,342
RE-G2Q4-2482-??	24	82	4	\$1,316	\$1,373
RE-G2Q4-2484-??	24	84	4	\$1,330	\$1,405
RE-G2Q4-2486-??	24	86	4	\$1,342	\$1,435

- Glass panels are 1/4" thick.
- Panels are cut exact to size.
- Edges are flat and polished. Not available with rounded corners.
- Clips and mounting hardware sold separately.

Glass Panels - Panel Only

3/8" Thick - Square Corners

6" High

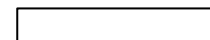

Model Number	Height	Length	Required Number of Clips	Clear Low Iron (LW)	Acid Etched (ET)
RE-GSQ4-0618-??	6	18	2	\$260	\$287
RE-GSQ4-0620-??	6	20	2	\$271	\$297
RE-GSQ4-0622-??	6	22	2	\$274	\$302
RE-GSQ4-0624-??	6	24	2	\$286	\$309
RE-GSQ4-0626-??	6	26	2	\$288	\$314
RE-GSQ4-0628-??	6	28	2	\$300	\$319
RE-GSQ4-0630-??	6	30	2	\$295	\$320
RE-GSQ4-0632-??	6	32	2	\$289	\$330
RE-GSQ4-0634-??	6	34	2	\$297	\$337
RE-GSQ4-0636-??	6	36	2	\$303	\$341
RE-GSQ4-0638-??	6	38	2	\$307	\$351
RE-GSQ4-0640-??	6	40	2	\$319	\$357
RE-GSQ4-0642-??	6	42	2	\$329	\$362
RE-GSQ4-0644-??	6	44	2	\$341	\$371
RE-GSQ4-0646-??	6	46	2	\$352	\$376
RE-GSQ4-0648-??	6	48	2	\$360	\$383
RE-GSQ4-0650-??	6	50	3	\$366	\$393
RE-GSQ4-0652-??	6	52	3	\$378	\$402
RE-GSQ4-0654-??	6	54	3	\$389	\$412
RE-GSQ4-0656-??	6	56	3	\$401	\$423
RE-GSQ4-0658-??	6	58	3	\$412	\$432
RE-GSQ4-0660-??	6	60	3	\$424	\$442
RE-GSQ4-0662-??	6	62	3	\$435	\$452
RE-GSQ4-0664-??	6	64	3	\$446	\$461
RE-GSQ4-0666-??	6	66	3	\$457	\$471
RE-GSQ4-0668-??	6	68	3	\$469	\$481
RE-GSQ4-0670-??	6	70	3	\$480	\$499
RE-GSQ4-0672-??	6	72	3	\$492	\$510
RE-GSQ4-0674-??	6	74	3	\$503	\$519
RE-GSQ4-0676-??	6	76	3	\$515	\$529
RE-GSQ4-0678-??	6	78	3	\$525	\$547
RE-GSQ4-0680-??	6	80	3	\$537	\$557
RE-GSQ4-0682-??	6	82	3	\$548	\$567
RE-GSQ4-0684-??	6	84	3	\$560	\$594
RE-GSQ4-0686-??	6	86	3	\$506	\$604

- Glass panels are 3/8" thick.
- Panels are cut exact to size.
- Edges are flat and polished.
- Not available with rounded corners.
- Clips and mounting hardware sold separately.

Glass Panels - Panel Only

3/8" Thick - Square Corners

8" High

Model Number	Height	Length	Required Number of Clips	Clear Low Iron (LW)	Acid Etched (ET)
RE-GSQ4-0818-??	8	18	2	\$275	\$291
RE-GSQ4-0820-??	8	20	2	\$271	\$296
RE-GSQ4-0822-??	8	22	2	\$286	\$300
RE-GSQ4-0824-??	8	24	2	\$282	\$305
RE-GSQ4-0826-??	8	26	2	\$295	\$309
RE-GSQ4-0828-??	8	28	2	\$300	\$312
RE-GSQ4-0830-??	8	30	2	\$305	\$318
RE-GSQ4-0832-??	8	32	2	\$318	\$321
RE-GSQ4-0834-??	8	34	2	\$323	\$327
RE-GSQ4-0836-??	8	36	2	\$328	\$339
RE-GSQ4-0838-??	8	38	2	\$332	\$352
RE-GSQ4-0840-??	8	40	2	\$344	\$366
RE-GSQ4-0842-??	8	42	2	\$359	\$379
RE-GSQ4-0844-??	8	44	2	\$371	\$392
RE-GSQ4-0846-??	8	46	2	\$384	\$405
RE-GSQ4-0848-??	8	48	2	\$397	\$426
RE-GSQ4-0850-??	8	50	3	\$411	\$440
RE-GSQ4-0852-??	8	52	3	\$424	\$453
RE-GSQ4-0854-??	8	54	3	\$462	\$475
RE-GSQ4-0856-??	8	56	3	\$475	\$488
RE-GSQ4-0858-??	8	58	3	\$488	\$510
RE-GSQ4-0860-??	8	60	3	\$501	\$522
RE-GSQ4-0862-??	8	62	3	\$513	\$535
RE-GSQ4-0864-??	8	64	3	\$528	\$549
RE-GSQ4-0866-??	8	66	3	\$540	\$571
RE-GSQ4-0868-??	8	68	3	\$553	\$584
RE-GSQ4-0870-??	8	70	3	\$566	\$606
RE-GSQ4-0872-??	8	72	3	\$580	\$627
RE-GSQ4-0874-??	8	74	3	\$593	\$640
RE-GSQ4-0876-??	8	76	3	\$606	\$662
RE-GSQ4-0878-??	8	78	3	\$627	\$675
RE-GSQ4-0880-??	8	80	3	\$640	\$688
RE-GSQ4-0882-??	8	82	3	\$653	\$702
RE-GSQ4-0884-??	8	84	3	\$675	\$723
RE-GSQ4-0886-??	8	86	3	\$697	\$736

- Glass panels are 3/8" thick.
- Panels are cut exact to size.
- Edges are flat and polished.
- Not available with rounded corners.
- Clips and mounting hardware sold separately.

Glass Panels - Panel Only

3/8" Thick - Square Corners

10" High

Model Number	Height	Length	Required Number of Clips	Clear Low Iron (LW)	Acid Etched (ET)
RE-GSQ4-1018-??	10	18	2	\$280	\$303
RE-GSQ4-1020-??	10	20	2	\$288	\$311
RE-GSQ4-1022-??	10	22	2	\$296	\$327
RE-GSQ4-1024-??	10	24	2	\$305	\$334
RE-GSQ4-1026-??	10	26	2	\$312	\$342
RE-GSQ4-1028-??	10	28	2	\$320	\$351
RE-GSQ4-1030-??	10	30	2	\$329	\$359
RE-GSQ4-1032-??	10	32	2	\$344	\$366
RE-GSQ4-1034-??	10	34	2	\$361	\$382
RE-GSQ4-1036-??	10	36	2	\$378	\$398
RE-GSQ4-1038-??	10	38	2	\$394	\$415
RE-GSQ4-1040-??	10	40	2	\$411	\$432
RE-GSQ4-1042-??	10	42	2	\$426	\$448
RE-GSQ4-1044-??	10	44	2	\$443	\$464
RE-GSQ4-1046-??	10	46	2	\$460	\$480
RE-GSQ4-1048-??	10	48	2	\$476	\$506
RE-GSQ4-1050-??	10	50	3	\$493	\$521
RE-GSQ4-1052-??	10	52	3	\$508	\$538
RE-GSQ4-1054-??	10	54	3	\$525	\$563
RE-GSQ4-1056-??	10	56	3	\$542	\$580
RE-GSQ4-1058-??	10	58	3	\$558	\$595
RE-GSQ4-1060-??	10	60	3	\$575	\$621
RE-GSQ4-1062-??	10	62	3	\$590	\$638
RE-GSQ4-1064-??	10	64	3	\$607	\$662
RE-GSQ4-1066-??	10	66	3	\$631	\$679
RE-GSQ4-1068-??	10	68	3	\$657	\$695
RE-GSQ4-1070-??	10	70	3	\$681	\$720
RE-GSQ4-1072-??	10	72	3	\$698	\$736
RE-GSQ4-1074-??	10	74	3	\$722	\$753
RE-GSQ4-1076-??	10	76	3	\$739	\$777
RE-GSQ4-1078-??	10	78	3	\$755	\$803
RE-GSQ4-1080-??	10	80	3	\$771	\$819
RE-GSQ4-1082-??	10	82	3	\$787	\$844
RE-GSQ4-1084-??	10	84	3	\$804	\$860
RE-GSQ4-1086-??	10	86	3	\$821	\$877

- Glass panels are 3/8" thick.
- Panels are cut exact to size.
- Edges are flat and polished.
- Not available with rounded corners.
- Clips and mounting hardware sold separately.

Glass Panels - Panel Only

3/8" Thick - Square Corners

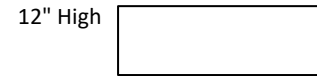

Model Number	Height	Length	Required Number of Clips	Clear Low Iron (LW)	Acid Etched (ET)
RE-GSQ4-1218-??	12	18	2	\$284	\$298
RE-GSQ4-1220-??	12	20	2	\$296	\$309
RE-GSQ4-1222-??	12	22	2	\$307	\$320
RE-GSQ4-1224-??	12	24	2	\$319	\$330
RE-GSQ4-1226-??	12	26	2	\$338	\$342
RE-GSQ4-1228-??	12	28	2	\$359	\$361
RE-GSQ4-1230-??	12	30	2	\$378	\$382
RE-GSQ4-1232-??	12	32	2	\$397	\$401
RE-GSQ4-1234-??	12	34	2	\$417	\$420
RE-GSQ4-1236-??	12	36	2	\$437	\$448
RE-GSQ4-1238-??	12	38	2	\$456	\$469
RE-GSQ4-1240-??	12	40	2	\$476	\$497
RE-GSQ4-1242-??	12	42	2	\$496	\$516
RE-GSQ4-1244-??	12	44	2	\$515	\$544
RE-GSQ4-1246-??	12	46	2	\$535	\$565
RE-GSQ4-1248-??	12	48	2	\$554	\$584
RE-GSQ4-1250-??	12	50	3	\$575	\$603
RE-GSQ4-1252-??	12	52	3	\$594	\$624
RE-GSQ4-1254-??	12	54	3	\$613	\$643
RE-GSQ4-1256-??	12	56	3	\$634	\$662
RE-GSQ4-1258-??	12	58	3	\$653	\$682
RE-GSQ4-1260-??	12	60	3	\$672	\$711
RE-GSQ4-1262-??	12	62	3	\$693	\$730
RE-GSQ4-1264-??	12	64	3	\$712	\$758
RE-GSQ4-1266-??	12	66	3	\$731	\$779
RE-GSQ4-1268-??	12	68	3	\$752	\$807
RE-GSQ4-1270-??	12	70	3	\$771	\$826
RE-GSQ4-1272-??	12	72	3	\$790	\$845
RE-GSQ4-1274-??	12	74	3	\$811	\$866
RE-GSQ4-1276-??	12	76	3	\$830	\$894
RE-GSQ4-1278-??	12	78	3	\$849	\$913
RE-GSQ4-1280-??	12	80	3	\$869	\$933
RE-GSQ4-1282-??	12	82	3	\$889	\$962
RE-GSQ4-1284-??	12	84	3	\$908	\$981
RE-GSQ4-1286-??	12	86	3	\$928	\$1,000

- Glass panels are 3/8" thick.
- Panels are cut exact to size.
- Edges are flat and polished.
- Not available with rounded corners.
- Clips and mounting hardware sold separately.

Glass Panels - Panel Only

3/8" Thick - Square Corners



Model Number	Height	Length	Required Number of Clips	Clear Low Iron (LW)	Acid Etched (ET)
RE-GSQ4-1518-??	15	18	2	\$318	\$321
RE-GSQ4-1520-??	15	20	2	\$329	\$332
RE-GSQ4-1522-??	15	22	2	\$353	\$356
RE-GSQ4-1524-??	15	24	2	\$378	\$389
RE-GSQ4-1526-??	15	26	2	\$402	\$415
RE-GSQ4-1528-??	15	28	2	\$426	\$448
RE-GSQ4-1530-??	15	30	2	\$452	\$472
RE-GSQ4-1532-??	15	32	2	\$476	\$506
RE-GSQ4-1534-??	15	34	2	\$501	\$530
RE-GSQ4-1536-??	15	36	2	\$525	\$563
RE-GSQ4-1538-??	15	38	2	\$549	\$588
RE-GSQ4-1540-??	15	40	2	\$575	\$621
RE-GSQ4-1542-??	15	42	2	\$599	\$645
RE-GSQ4-1544-??	15	44	2	\$624	\$679
RE-GSQ4-1546-??	15	46	2	\$657	\$703
RE-GSQ4-1548-??	15	48	2	\$689	\$727
RE-GSQ4-1550-??	15	50	3	\$713	\$761
RE-GSQ4-1552-??	15	52	3	\$739	\$785
RE-GSQ4-1554-??	15	54	3	\$763	\$818
RE-GSQ4-1556-??	15	56	3	\$787	\$844
RE-GSQ4-1558-??	15	58	3	\$812	\$868
RE-GSQ4-1560-??	15	60	3	\$845	\$901
RE-GSQ4-1562-??	15	62	3	\$869	\$926
RE-GSQ4-1564-??	15	64	3	\$894	\$959
RE-GSQ4-1566-??	15	66	3	\$918	\$983
RE-GSQ4-1568-??	15	68	3	\$944	\$1,008
RE-GSQ4-1570-??	15	70	3	\$968	\$1,041
RE-GSQ4-1572-??	15	72	3	\$992	\$1,065
RE-GSQ4-1574-??	15	74	3	\$1,017	\$1,090
RE-GSQ4-1576-??	15	76	3	\$1,041	\$1,123
RE-GSQ4-1578-??	15	78	3	\$1,067	\$1,149
RE-GSQ4-1580-??	15	80	3	\$1,091	\$1,182
RE-GSQ4-1582-??	15	82	3	\$1,115	\$1,214
RE-GSQ4-1584-??	15	84	3	\$1,140	\$1,239
RE-GSQ4-1586-??	15	86	3	\$1,164	\$1,264

- Glass panels are 3/8" thick.
- Panels are cut exact to size.
- Edges are flat and polished.
- Not available with rounded corners.
- Clips and mounting hardware sold separately.

Glass Panels - Panel Only

3/8" Thick - Square Corners
18" High



Model Number	Height	Length	Required Number of Clips	Clear Low Iron (LW)	Acid Etched (ET)
RE-GSQ4-1818-??	18	18	2	\$332	\$352
RE-GSQ4-1820-??	18	20	2	\$361	\$382
RE-GSQ4-1822-??	18	22	2	\$391	\$411
RE-GSQ4-1824-??	18	24	2	\$420	\$440
RE-GSQ4-1826-??	18	26	2	\$449	\$470
RE-GSQ4-1828-??	18	28	2	\$479	\$499
RE-GSQ4-1830-??	18	30	2	\$508	\$529
RE-GSQ4-1832-??	18	32	2	\$538	\$558
RE-GSQ4-1834-??	18	34	2	\$567	\$588
RE-GSQ4-1836-??	18	36	2	\$597	\$617
RE-GSQ4-1838-??	18	38	2	\$626	\$647
RE-GSQ4-1840-??	18	40	2	\$656	\$676
RE-GSQ4-1842-??	18	42	2	\$685	\$709
RE-GSQ4-1844-??	18	44	2	\$714	\$739
RE-GSQ4-1846-??	18	46	2	\$744	\$773
RE-GSQ4-1848-??	18	48	3	\$773	\$803
RE-GSQ4-1850-??	18	50	3	\$803	\$832
RE-GSQ4-1852-??	18	52	3	\$832	\$869
RE-GSQ4-1854-??	18	54	3	\$862	\$899
RE-GSQ4-1856-??	18	56	3	\$891	\$928
RE-GSQ4-1858-??	18	58	3	\$922	\$967
RE-GSQ4-1860-??	18	60	3	\$951	\$996
RE-GSQ4-1862-??	18	62	3	\$981	\$1,026
RE-GSQ4-1864-??	18	64	3	\$1,010	\$1,055
RE-GSQ4-1866-??	18	66	3	\$1,040	\$1,085
RE-GSQ4-1868-??	18	68	3	\$1,069	\$1,114
RE-GSQ4-1870-??	18	70	3	\$1,099	\$1,143
RE-GSQ4-1872-??	18	72	3	\$1,128	\$1,173
RE-GSQ4-1874-??	18	74	3	\$1,158	\$1,202
RE-GSQ4-1876-??	18	76	3	\$1,187	\$1,232
RE-GSQ4-1878-??	18	78	3	\$1,216	\$1,261
RE-GSQ4-1880-??	18	80	3	\$1,246	\$1,291
RE-GSQ4-1882-??	18	82	3	\$1,275	\$1,320
RE-GSQ4-1884-??	18	84	3	\$1,305	\$1,359
RE-GSQ4-1886-??	18	86	3	\$1,334	\$1,388

- Glass panels are 3/8" thick.
- Panels are cut exact to size.
- Edges are flat and polished.
- Not available with rounded corners.
- Clips and mounting hardware sold separately.

Glass Panels - Panel Only

3/8" Thick - Square Corners
24" High



Model Number	Height	Length	Required Number of Clips	Clear Low Iron (LW)	Acid Etched (ET)
RE-GSQ4-2418-??	24	18	2	\$407	\$440
RE-GSQ4-2420-??	24	20	2	\$447	\$479
RE-GSQ4-2422-??	24	22	2	\$487	\$519
RE-GSQ4-2424-??	24	24	2	\$525	\$558
RE-GSQ4-2426-??	24	26	2	\$565	\$597
RE-GSQ4-2428-??	24	28	2	\$604	\$636
RE-GSQ4-2430-??	24	30	2	\$644	\$676
RE-GSQ4-2432-??	24	32	2	\$682	\$716
RE-GSQ4-2434-??	24	34	2	\$722	\$754
RE-GSQ4-2436-??	24	36	2	\$762	\$794
RE-GSQ4-2438-??	24	38	2	\$800	\$834
RE-GSQ4-2440-??	24	40	2	\$840	\$872
RE-GSQ4-2442-??	24	42	2	\$880	\$912
RE-GSQ4-2444-??	24	44	2	\$918	\$951
RE-GSQ4-2446-??	24	46	2	\$958	\$990
RE-GSQ4-2448-??	24	48	3	\$997	\$1,029
RE-GSQ4-2450-??	24	50	3	\$1,037	\$1,069
RE-GSQ4-2452-??	24	52	3	\$1,076	\$1,108
RE-GSQ4-2454-??	24	54	3	\$1,115	\$1,147
RE-GSQ4-2456-??	24	56	3	\$1,155	\$1,187
RE-GSQ4-2458-??	24	58	3	\$1,193	\$1,227
RE-GSQ4-2460-??	24	60	3	\$1,233	\$1,265
RE-GSQ4-2462-??	24	62	3	\$1,273	\$1,305
RE-GSQ4-2464-??	24	64	3	\$1,311	\$1,344
RE-GSQ4-2466-??	24	66	3	\$1,351	\$1,383
RE-GSQ4-2468-??	24	68	3	\$1,391	\$1,423
RE-GSQ4-2470-??	24	70	3	\$1,430	\$1,462
RE-GSQ4-2472-??	24	72	4	\$1,469	\$1,501
RE-GSQ4-2474-??	24	74	4	\$1,508	\$1,540
RE-GSQ4-2476-??	24	76	4	\$1,548	\$1,580
RE-GSQ4-2478-??	24	78	4	\$1,586	\$1,618
RE-GSQ4-2480-??	24	80	4	\$1,626	\$1,658
RE-GSQ4-2482-??	24	82	4	\$1,666	\$1,698
RE-GSQ4-2484-??	24	84	4	\$1,704	\$1,754
RE-GSQ4-2486-??	24	86	4	\$1,744	\$1,794

- Glass panels are 3/8" thick.
- Panels are cut exact to size.
- Edges are flat and polished.
- Not available with rounded corners.
- Clips and mounting hardware sold separately.

Laminate Panels - Panel Only

3/4" Thick - Square Corners

6" High

Model Number	Height	Length	Required Number of Clips	TFL (T)	HPL (H)	Whiteboard (W)
RE-LSQ4-0618-?	6	18	2	\$230	\$364	\$430
RE-LSQ4-0620-?	6	20	2	\$236	\$372	\$442
RE-LSQ4-0622-?	6	22	2	\$237	\$375	\$447
RE-LSQ4-0624-?	6	24	2	\$238	\$376	\$453
RE-LSQ4-0626-?	6	26	2	\$247	\$391	\$472
RE-LSQ4-0628-?	6	28	2	\$248	\$392	\$476
RE-LSQ4-0630-?	6	30	2	\$250	\$395	\$484
RE-LSQ4-0632-?	6	32	2	\$251	\$396	\$488
RE-LSQ4-0634-?	6	34	2	\$259	\$408	\$504
RE-LSQ4-0636-?	6	36	2	\$260	\$411	\$509
RE-LSQ4-0638-?	6	38	2	\$269	\$425	\$528
RE-LSQ4-0640-?	6	40	2	\$270	\$427	\$534
RE-LSQ4-0642-?	6	42	2	\$271	\$429	\$539
RE-LSQ4-0644-?	6	44	2	\$274	\$433	\$547
RE-LSQ4-0646-?	6	46	2	\$275	\$435	\$553
RE-LSQ4-0648-?	6	48	2	\$277	\$437	\$558
RE-LSQ4-0650-?	6	50	3	\$315	\$497	\$627
RE-LSQ4-0652-?	6	52	3	\$318	\$501	\$635
RE-LSQ4-0654-?	6	54	3	\$319	\$504	\$642
RE-LSQ4-0656-?	6	56	3	\$320	\$505	\$647
RE-LSQ4-0658-?	6	58	3	\$323	\$509	\$654
RE-LSQ4-0660-?	6	60	3	\$324	\$512	\$660
RE-LSQ4-0662-?	6	62	3	\$325	\$514	\$664
RE-LSQ4-0664-?	6	64	3	\$327	\$516	\$670
RE-LSQ4-0666-?	6	66	3	\$329	\$520	\$679
RE-LSQ4-0668-?	6	68	3	\$330	\$522	\$683
RE-LSQ4-0670-?	6	70	3	\$332	\$524	\$690
RE-LSQ4-0672-?	6	72	3	\$333	\$526	\$694
RE-LSQ4-0674-?	6	74	3	\$335	\$530	\$701
RE-LSQ4-0676-?	6	76	3	\$337	\$532	\$708
RE-LSQ4-0678-?	6	78	3	\$338	\$534	\$713
RE-LSQ4-0680-?	6	80	3	\$339	\$536	\$720
RE-LSQ4-0682-?	6	82	3	\$342	\$540	\$726
RE-LSQ4-0684-?	6	84	3	\$343	\$542	\$731
RE-LSQ4-0686-?	6	86	3	\$344	\$545	\$737

- Laminate panels are 3/4" thick material with 2mm PVC edgebanding. Grain direction is horizontal.
 - Panels are cut exact to size.
 - Clips and mounting hardware sold separately.

Laminate Panels - Panel Only

3/4" Thick - Rounded Corners

6" High

Radius All Four Corners

Model Number	Height	Length	Required Number of Clips	TFL (T)	HPL (H)	Whiteboard (W)
RE-LRD4-0618-?	6	18	2	\$248	\$392	\$461
RE-LRD4-0620-?	6	20	2	\$255	\$403	\$476
RE-LRD4-0622-?	6	22	2	\$256	\$404	\$480
RE-LRD4-0624-?	6	24	2	\$257	\$407	\$487
RE-LRD4-0626-?	6	26	2	\$266	\$421	\$504
RE-LRD4-0628-?	6	28	2	\$269	\$425	\$512
RE-LRD4-0630-?	6	30	2	\$270	\$427	\$519
RE-LRD4-0632-?	6	32	2	\$271	\$429	\$523
RE-LRD4-0634-?	6	34	2	\$279	\$441	\$539
RE-LRD4-0636-?	6	36	2	\$280	\$443	\$546
RE-LRD4-0638-?	6	38	2	\$291	\$460	\$566
RE-LRD4-0640-?	6	40	2	\$292	\$461	\$571
RE-LRD4-0642-?	6	42	2	\$293	\$464	\$578
RE-LRD4-0644-?	6	44	2	\$296	\$468	\$586
RE-LRD4-0646-?	6	46	2	\$297	\$469	\$590
RE-LRD4-0648-?	6	48	2	\$298	\$472	\$596
RE-LRD4-0650-?	6	50	3	\$341	\$538	\$671
RE-LRD4-0652-?	6	52	3	\$343	\$542	\$679
RE-LRD4-0654-?	6	54	3	\$344	\$545	\$686
RE-LRD4-0656-?	6	56	3	\$346	\$546	\$691
RE-LRD4-0658-?	6	58	3	\$348	\$550	\$698
RE-LRD4-0660-?	6	60	3	\$350	\$553	\$705
RE-LRD4-0662-?	6	62	3	\$351	\$554	\$709
RE-LRD4-0664-?	6	64	3	\$352	\$557	\$714
RE-LRD4-0666-?	6	66	3	\$356	\$562	\$725
RE-LRD4-0668-?	6	68	3	\$357	\$565	\$731
RE-LRD4-0670-?	6	70	3	\$359	\$566	\$736
RE-LRD4-0672-?	6	72	3	\$360	\$569	\$741
RE-LRD4-0674-?	6	74	3	\$362	\$573	\$749
RE-LRD4-0676-?	6	76	3	\$364	\$574	\$753
RE-LRD4-0678-?	6	78	3	\$365	\$577	\$760
RE-LRD4-0680-?	6	80	3	\$366	\$578	\$766
RE-LRD4-0682-?	6	82	3	\$369	\$582	\$772
RE-LRD4-0684-?	6	84	3	\$370	\$585	\$779
RE-LRD4-0686-?	6	86	3	\$373	\$589	\$786

- Laminate panels are 3/4" thick material with 2mm PVC edgebanding. Grain direction is horizontal.
 - Panels are cut exact to size.
 - Rounded corners have a 2" radius.
 - Clips and mounting hardware sold separately.

Laminate Panels - Panel Only

3/4" Thick - Rounded Corners

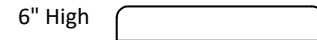

Radius Top Two Corners

Model Number	Height	Length	Required Number of Clips	TFL (T)	HPL (H)	Whiteboard (W)
RE-LRD2-0618-?	6	18	2	\$248	\$392	\$461
RE-LRD2-0620-?	6	20	2	\$255	\$403	\$476
RE-LRD2-0622-?	6	22	2	\$256	\$404	\$480
RE-LRD2-0624-?	6	24	2	\$257	\$407	\$487
RE-LRD2-0626-?	6	26	2	\$266	\$421	\$504
RE-LRD2-0628-?	6	28	2	\$269	\$425	\$512
RE-LRD2-0630-?	6	30	2	\$270	\$427	\$519
RE-LRD2-0632-?	6	32	2	\$271	\$429	\$523
RE-LRD2-0634-?	6	34	2	\$279	\$441	\$539
RE-LRD2-0636-?	6	36	2	\$280	\$443	\$546
RE-LRD2-0638-?	6	38	2	\$291	\$460	\$566
RE-LRD2-0640-?	6	40	2	\$292	\$461	\$571
RE-LRD2-0642-?	6	42	2	\$293	\$464	\$578
RE-LRD2-0644-?	6	44	2	\$296	\$468	\$586
RE-LRD2-0646-?	6	46	2	\$297	\$469	\$590
RE-LRD2-0648-?	6	48	2	\$298	\$472	\$596
RE-LRD2-0650-?	6	50	3	\$341	\$538	\$671
RE-LRD2-0652-?	6	52	3	\$343	\$542	\$679
RE-LRD2-0654-?	6	54	3	\$344	\$545	\$686
RE-LRD2-0656-?	6	56	3	\$346	\$546	\$691
RE-LRD2-0658-?	6	58	3	\$348	\$550	\$698
RE-LRD2-0660-?	6	60	3	\$350	\$553	\$705
RE-LRD2-0662-?	6	62	3	\$351	\$554	\$709
RE-LRD2-0664-?	6	64	3	\$352	\$557	\$714
RE-LRD2-0666-?	6	66	3	\$356	\$562	\$725
RE-LRD2-0668-?	6	68	3	\$357	\$565	\$731
RE-LRD2-0670-?	6	70	3	\$359	\$566	\$736
RE-LRD2-0672-?	6	72	3	\$360	\$569	\$741
RE-LRD2-0674-?	6	74	3	\$362	\$573	\$749
RE-LRD2-0676-?	6	76	3	\$364	\$574	\$753
RE-LRD2-0678-?	6	78	3	\$365	\$577	\$760
RE-LRD2-0680-?	6	80	3	\$366	\$578	\$766
RE-LRD2-0682-?	6	82	3	\$369	\$582	\$772
RE-LRD2-0684-?	6	84	3	\$370	\$585	\$779
RE-LRD2-0686-?	6	86	3	\$373	\$589	\$786

- Laminate panels are 3/4" thick material with 2mm PVC edgebanding. Grain direction is horizontal.
- Panels are cut exact to size.
- Rounded corners have a 2" radius.
- Clips and mounting hardware sold separately.

Laminate Panels - Panel Only

3/4" Thick - Square Corners

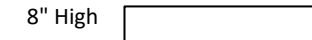

Model Number	Height	Length	Required Number of Clips	TFL (T)	HPL (H)	Whiteboard (W)
RE-LSQ4-0818-?	8	18	2	\$238	\$376	\$453
RE-LSQ4-0820-?	8	20	2	\$245	\$387	\$469
RE-LSQ4-0822-?	8	22	2	\$247	\$391	\$477
RE-LSQ4-0824-?	8	24	2	\$248	\$392	\$484
RE-LSQ4-0826-?	8	26	2	\$259	\$408	\$505
RE-LSQ4-0828-?	8	28	2	\$260	\$411	\$512
RE-LSQ4-0830-?	8	30	2	\$262	\$415	\$520
RE-LSQ4-0832-?	8	32	2	\$264	\$416	\$527
RE-LSQ4-0834-?	8	34	2	\$283	\$447	\$565
RE-LSQ4-0836-?	8	36	2	\$284	\$449	\$571
RE-LSQ4-0838-?	8	38	2	\$287	\$453	\$580
RE-LSQ4-0840-?	8	40	2	\$288	\$456	\$588
RE-LSQ4-0842-?	8	42	2	\$289	\$457	\$593
RE-LSQ4-0844-?	8	44	2	\$291	\$460	\$601
RE-LSQ4-0846-?	8	46	2	\$293	\$464	\$608
RE-LSQ4-0848-?	8	48	2	\$295	\$465	\$613
RE-LSQ4-0850-?	8	50	3	\$350	\$553	\$714
RE-LSQ4-0852-?	8	52	3	\$351	\$554	\$721
RE-LSQ4-0854-?	8	54	3	\$352	\$557	\$728
RE-LSQ4-0856-?	8	56	3	\$353	\$558	\$735
RE-LSQ4-0858-?	8	58	3	\$356	\$562	\$743
RE-LSQ4-0860-?	8	60	3	\$357	\$565	\$751
RE-LSQ4-0862-?	8	62	3	\$359	\$566	\$756
RE-LSQ4-0864-?	8	64	3	\$361	\$570	\$764
RE-LSQ4-0866-?	8	66	3	\$362	\$573	\$771
RE-LSQ4-0868-?	8	68	3	\$364	\$574	\$776
RE-LSQ4-0870-?	8	70	3	\$365	\$577	\$784
RE-LSQ4-0872-?	8	72	3	\$367	\$581	\$794
RE-LSQ4-0874-?	8	74	3	\$369	\$582	\$799
RE-LSQ4-0876-?	8	76	3	\$370	\$585	\$806
RE-LSQ4-0878-?	8	78	3	\$371	\$586	\$813
RE-LSQ4-0880-?	8	80	3	\$374	\$590	\$821
RE-LSQ4-0882-?	8	82	3	\$375	\$593	\$828
RE-LSQ4-0884-?	8	84	3	\$376	\$594	\$833
RE-LSQ4-0886-?	8	86	3	\$380	\$601	\$845

- Laminate panels are 3/4" thick material with 2mm PVC edgebanding. Grain direction is horizontal.
- Panels are cut exact to size.
- Clips and mounting hardware sold separately.

Laminate Panels - Panel Only

3/4" Thick - Rounded Corners

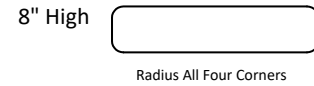

Model Number	Height	Length	Required Number of Clips	TFL (T)	HPL (H)	Whiteboard (W)
RE-LRD4-0818-?	8	18	2	\$257	\$407	\$487
RE-LRD4-0820-?	8	20	2	\$264	\$416	\$501
RE-LRD4-0822-?	8	22	2	\$266	\$421	\$509
RE-LRD4-0824-?	8	24	2	\$269	\$425	\$519
RE-LRD4-0826-?	8	26	2	\$279	\$441	\$542
RE-LRD4-0828-?	8	28	2	\$280	\$443	\$547
RE-LRD4-0830-?	8	30	2	\$283	\$447	\$557
RE-LRD4-0832-?	8	32	2	\$284	\$449	\$562
RE-LRD4-0834-?	8	34	2	\$306	\$484	\$605
RE-LRD4-0836-?	8	36	2	\$307	\$485	\$611
RE-LRD4-0838-?	8	38	2	\$310	\$489	\$620
RE-LRD4-0840-?	8	40	2	\$311	\$492	\$627
RE-LRD4-0842-?	8	42	2	\$312	\$493	\$633
RE-LRD4-0844-?	8	44	2	\$314	\$496	\$640
RE-LRD4-0846-?	8	46	2	\$316	\$500	\$648
RE-LRD4-0848-?	8	48	2	\$318	\$501	\$654
RE-LRD4-0850-?	8	50	3	\$378	\$597	\$764
RE-LRD4-0852-?	8	52	3	\$379	\$598	\$770
RE-LRD4-0854-?	8	54	3	\$380	\$601	\$776
RE-LRD4-0856-?	8	56	3	\$382	\$602	\$783
RE-LRD4-0858-?	8	58	3	\$384	\$607	\$791
RE-LRD4-0860-?	8	60	3	\$385	\$609	\$799
RE-LRD4-0862-?	8	62	3	\$387	\$611	\$805
RE-LRD4-0864-?	8	64	3	\$391	\$617	\$815
RE-LRD4-0866-?	8	66	3	\$392	\$619	\$821
RE-LRD4-0868-?	8	68	3	\$393	\$621	\$829
RE-LRD4-0870-?	8	70	3	\$394	\$623	\$834
RE-LRD4-0872-?	8	72	3	\$397	\$627	\$844
RE-LRD4-0874-?	8	74	3	\$398	\$629	\$850
RE-LRD4-0876-?	8	76	3	\$399	\$631	\$857
RE-LRD4-0878-?	8	78	3	\$401	\$633	\$864
RE-LRD4-0880-?	8	80	3	\$403	\$638	\$873
RE-LRD4-0882-?	8	82	3	\$405	\$639	\$877
RE-LRD4-0884-?	8	84	3	\$407	\$643	\$887
RE-LRD4-0886-?	8	86	3	\$411	\$650	\$899

- Laminate panels are 3/4" thick material with 2mm PVC edgebanding. Grain direction is horizontal.
- Panels are cut exact to size.
- Rounded corners have a 2" radius.
- Clips and mounting hardware sold separately.

Laminate Panels - Panel Only

3/4" Thick - Rounded Corners

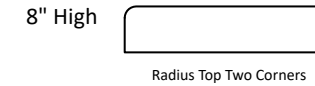

Model Number	Height	Length	Required Number of Clips	TFL (T)	HPL (H)	Whiteboard (W)
RE-LRD2-0818-?	8	18	2	\$257	\$407	\$487
RE-LRD2-0820-?	8	20	2	\$264	\$416	\$501
RE-LRD2-0822-?	8	22	2	\$266	\$421	\$509
RE-LRD2-0824-?	8	24	2	\$269	\$425	\$519
RE-LRD2-0826-?	8	26	2	\$279	\$441	\$542
RE-LRD2-0828-?	8	28	2	\$280	\$443	\$547
RE-LRD2-0830-?	8	30	2	\$283	\$447	\$557
RE-LRD2-0832-?	8	32	2	\$284	\$449	\$562
RE-LRD2-0834-?	8	34	2	\$306	\$484	\$605
RE-LRD2-0836-?	8	36	2	\$307	\$485	\$611
RE-LRD2-0838-?	8	38	2	\$310	\$489	\$620
RE-LRD2-0840-?	8	40	2	\$311	\$492	\$627
RE-LRD2-0842-?	8	42	2	\$312	\$493	\$633
RE-LRD2-0844-?	8	44	2	\$314	\$496	\$640
RE-LRD2-0846-?	8	46	2	\$316	\$500	\$648
RE-LRD2-0848-?	8	48	2	\$318	\$501	\$654
RE-LRD2-0850-?	8	50	3	\$378	\$597	\$764
RE-LRD2-0852-?	8	52	3	\$379	\$598	\$770
RE-LRD2-0854-?	8	54	3	\$380	\$601	\$776
RE-LRD2-0856-?	8	56	3	\$382	\$602	\$783
RE-LRD2-0858-?	8	58	3	\$384	\$607	\$791
RE-LRD2-0860-?	8	60	3	\$385	\$609	\$799
RE-LRD2-0862-?	8	62	3	\$387	\$611	\$805
RE-LRD2-0864-?	8	64	3	\$391	\$617	\$815
RE-LRD2-0866-?	8	66	3	\$392	\$619	\$821
RE-LRD2-0868-?	8	68	3	\$393	\$621	\$829
RE-LRD2-0870-?	8	70	3	\$394	\$623	\$834
RE-LRD2-0872-?	8	72	3	\$397	\$627	\$844
RE-LRD2-0874-?	8	74	3	\$398	\$629	\$850
RE-LRD2-0876-?	8	76	3	\$399	\$631	\$857
RE-LRD2-0878-?	8	78	3	\$401	\$633	\$864
RE-LRD2-0880-?	8	80	3	\$403	\$638	\$873
RE-LRD2-0882-?	8	82	3	\$405	\$639	\$877
RE-LRD2-0884-?	8	84	3	\$407	\$643	\$887
RE-LRD2-0886-?	8	86	3	\$411	\$650	\$899

- Laminate panels are 3/4" thick material with 2mm PVC edgebanding. Grain direction is horizontal.
- Panels are cut exact to size.
- Rounded corners have a 2" radius.
- Clips and mounting hardware sold separately.

Laminate Panels - Panel Only

3/4" Thick - Square Corners

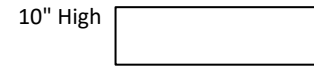

Model Number	Height	Length	Required Number of Clips	TFL (T)	HPL (H)	Whiteboard (W)
RE-LSQ4-1018-?	10	18	2	\$257	\$407	\$497
RE-LSQ4-1020-?	10	20	2	\$261	\$412	\$507
RE-LSQ4-1022-?	10	22	2	\$264	\$416	\$518
RE-LSQ4-1024-?	10	24	2	\$268	\$423	\$530
RE-LSQ4-1026-?	10	26	2	\$270	\$427	\$539
RE-LSQ4-1028-?	10	28	2	\$274	\$433	\$551
RE-LSQ4-1030-?	10	30	2	\$277	\$437	\$561
RE-LSQ4-1032-?	10	32	2	\$279	\$441	\$571
RE-LSQ4-1034-?	10	34	2	\$293	\$464	\$601
RE-LSQ4-1036-?	10	36	2	\$295	\$465	\$608
RE-LSQ4-1038-?	10	38	2	\$297	\$469	\$619
RE-LSQ4-1040-?	10	40	2	\$298	\$472	\$625
RE-LSQ4-1042-?	10	42	2	\$300	\$473	\$633
RE-LSQ4-1044-?	10	44	2	\$302	\$477	\$642
RE-LSQ4-1046-?	10	46	2	\$303	\$480	\$651
RE-LSQ4-1048-?	10	48	2	\$305	\$481	\$658
RE-LSQ4-1050-?	10	50	3	\$369	\$582	\$774
RE-LSQ4-1052-?	10	52	3	\$370	\$585	\$783
RE-LSQ4-1054-?	10	54	3	\$371	\$586	\$790
RE-LSQ4-1056-?	10	56	3	\$374	\$590	\$799
RE-LSQ4-1058-?	10	58	3	\$376	\$594	\$810
RE-LSQ4-1060-?	10	60	3	\$379	\$598	\$818
RE-LSQ4-1062-?	10	62	3	\$382	\$602	\$829
RE-LSQ4-1064-?	10	64	3	\$385	\$609	\$842
RE-LSQ4-1066-?	10	66	3	\$388	\$613	\$850
RE-LSQ4-1068-?	10	68	3	\$391	\$617	\$861
RE-LSQ4-1070-?	10	70	3	\$393	\$621	\$871
RE-LSQ4-1072-?	10	72	3	\$398	\$629	\$886
RE-LSQ4-1074-?	10	74	3	\$401	\$633	\$895
RE-LSQ4-1076-?	10	76	3	\$405	\$639	\$906
RE-LSQ4-1078-?	10	78	3	\$408	\$646	\$919
RE-LSQ4-1080-?	10	80	3	\$411	\$650	\$929
RE-LSQ4-1082-?	10	82	3	\$414	\$654	\$938
RE-LSQ4-1084-?	10	84	3	\$416	\$658	\$949
RE-LSQ4-1086-?	10	86	3	\$423	\$667	\$964

- Laminate panels are 3/4" thick material with 2mm PVC edgebanding. Grain direction is horizontal.
- Panels are cut exact to size.
- Clips and mounting hardware sold separately.

Laminate Panels - Panel Only

3/4" Thick - Rounded Corners

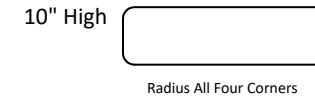

Model Number	Height	Length	Required Number of Clips	TFL (T)	HPL (H)	Whiteboard (W)
RE-LRD4-1018-?	10	18	2	\$278	\$439	\$532
RE-LRD4-1020-?	10	20	2	\$282	\$445	\$543
RE-LRD4-1022-?	10	22	2	\$284	\$449	\$553
RE-LRD4-1024-?	10	24	2	\$289	\$457	\$566
RE-LRD4-1026-?	10	26	2	\$292	\$461	\$577
RE-LRD4-1028-?	10	28	2	\$296	\$468	\$590
RE-LRD4-1030-?	10	30	2	\$298	\$472	\$598
RE-LRD4-1032-?	10	32	2	\$301	\$476	\$609
RE-LRD4-1034-?	10	34	2	\$316	\$500	\$640
RE-LRD4-1036-?	10	36	2	\$318	\$501	\$648
RE-LRD4-1038-?	10	38	2	\$321	\$508	\$662
RE-LRD4-1040-?	10	40	2	\$323	\$509	\$667
RE-LRD4-1042-?	10	42	2	\$324	\$512	\$677
RE-LRD4-1044-?	10	44	2	\$327	\$516	\$685
RE-LRD4-1046-?	10	46	2	\$328	\$518	\$693
RE-LRD4-1048-?	10	48	2	\$329	\$520	\$701
RE-LRD4-1050-?	10	50	3	\$398	\$629	\$826
RE-LRD4-1052-?	10	52	3	\$399	\$631	\$833
RE-LRD4-1054-?	10	54	3	\$401	\$633	\$842
RE-LRD4-1056-?	10	56	3	\$403	\$638	\$850
RE-LRD4-1058-?	10	58	3	\$407	\$643	\$863
RE-LRD4-1060-?	10	60	3	\$410	\$647	\$872
RE-LRD4-1062-?	10	62	3	\$412	\$651	\$883
RE-LRD4-1064-?	10	64	3	\$416	\$658	\$895
RE-LRD4-1066-?	10	66	3	\$419	\$662	\$904
RE-LRD4-1068-?	10	68	3	\$421	\$666	\$915
RE-LRD4-1070-?	10	70	3	\$425	\$671	\$925
RE-LRD4-1072-?	10	72	3	\$430	\$679	\$939
RE-LRD4-1074-?	10	74	3	\$433	\$683	\$950
RE-LRD4-1076-?	10	76	3	\$437	\$690	\$962
RE-LRD4-1078-?	10	78	3	\$442	\$698	\$977
RE-LRD4-1080-?	10	80	3	\$444	\$702	\$987
RE-LRD4-1082-?	10	82	3	\$447	\$706	\$996
RE-LRD4-1084-?	10	84	3	\$449	\$710	\$1,007
RE-LRD4-1086-?	10	86	3	\$456	\$720	\$1,022

- Laminate panels are 3/4" thick material with 2mm PVC edgebanding. Grain direction is horizontal.
- Panels are cut exact to size.
- Rounded corners have a 2" radius.
- Clips and mounting hardware sold separately.

Laminate Panels - Panel Only

3/4" Thick - Rounded Corners

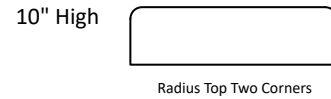

Model Number	Height	Length	Required Number of Clips	TFL (T)	HPL (H)	Whiteboard (W)
RE-LRD2-1018-?	10	18	2	\$278	\$439	\$532
RE-LRD2-1020-?	10	20	2	\$282	\$445	\$543
RE-LRD2-1022-?	10	22	2	\$284	\$449	\$553
RE-LRD2-1024-?	10	24	2	\$289	\$457	\$566
RE-LRD2-1026-?	10	26	2	\$292	\$461	\$577
RE-LRD2-1028-?	10	28	2	\$296	\$468	\$590
RE-LRD2-1030-?	10	30	2	\$298	\$472	\$598
RE-LRD2-1032-?	10	32	2	\$301	\$476	\$609
RE-LRD2-1034-?	10	34	2	\$316	\$500	\$640
RE-LRD2-1036-?	10	36	2	\$318	\$501	\$648
RE-LRD2-1038-?	10	38	2	\$321	\$508	\$662
RE-LRD2-1040-?	10	40	2	\$323	\$509	\$667
RE-LRD2-1042-?	10	42	2	\$324	\$512	\$677
RE-LRD2-1044-?	10	44	2	\$327	\$516	\$685
RE-LRD2-1046-?	10	46	2	\$328	\$518	\$693
RE-LRD2-1048-?	10	48	2	\$329	\$520	\$701
RE-LRD2-1050-?	10	50	3	\$398	\$629	\$826
RE-LRD2-1052-?	10	52	3	\$399	\$631	\$833
RE-LRD2-1054-?	10	54	3	\$401	\$633	\$842
RE-LRD2-1056-?	10	56	3	\$403	\$638	\$850
RE-LRD2-1058-?	10	58	3	\$407	\$643	\$863
RE-LRD2-1060-?	10	60	3	\$410	\$647	\$872
RE-LRD2-1062-?	10	62	3	\$412	\$651	\$883
RE-LRD2-1064-?	10	64	3	\$416	\$658	\$895
RE-LRD2-1066-?	10	66	3	\$419	\$662	\$904
RE-LRD2-1068-?	10	68	3	\$421	\$666	\$915
RE-LRD2-1070-?	10	70	3	\$425	\$671	\$925
RE-LRD2-1072-?	10	72	3	\$430	\$679	\$939
RE-LRD2-1074-?	10	74	3	\$433	\$683	\$950
RE-LRD2-1076-?	10	76	3	\$437	\$690	\$962
RE-LRD2-1078-?	10	78	3	\$442	\$698	\$977
RE-LRD2-1080-?	10	80	3	\$444	\$702	\$987
RE-LRD2-1082-?	10	82	3	\$447	\$706	\$996
RE-LRD2-1084-?	10	84	3	\$449	\$710	\$1,007
RE-LRD2-1086-?	10	86	3	\$456	\$720	\$1,022

- Laminate panels are 3/4" thick material with 2mm PVC edgebanding. Grain direction is horizontal.
- Panels are cut exact to size.
- Rounded corners have a 2" radius.
- Clips and mounting hardware sold separately.

Laminate Panels - Panel Only

3/4" Thick - Square Corners



Model Number	Height	Length	Required Number of Clips	TFL (T)	HPL (H)	Whiteboard (W)
RE-LSQ4-1218-?	12	18	2	\$287	\$453	\$557
RE-LSQ4-1220-?	12	20	2	\$292	\$461	\$571
RE-LSQ4-1222-?	12	22	2	\$295	\$465	\$582
RE-LSQ4-1224-?	12	24	2	\$297	\$469	\$593
RE-LSQ4-1226-?	12	26	2	\$301	\$476	\$607
RE-LSQ4-1228-?	12	28	2	\$293	\$464	\$601
RE-LSQ4-1230-?	12	30	2	\$307	\$485	\$631
RE-LSQ4-1232-?	12	32	2	\$310	\$489	\$640
RE-LSQ4-1234-?	12	34	2	\$324	\$512	\$673
RE-LSQ4-1236-?	12	36	2	\$325	\$514	\$681
RE-LSQ4-1238-?	12	38	2	\$328	\$518	\$691
RE-LSQ4-1240-?	12	40	2	\$329	\$520	\$701
RE-LSQ4-1242-?	12	42	2	\$330	\$522	\$709
RE-LSQ4-1244-?	12	44	2	\$333	\$526	\$720
RE-LSQ4-1246-?	12	46	2	\$334	\$528	\$729
RE-LSQ4-1248-?	12	48	2	\$337	\$532	\$740
RE-LSQ4-1250-?	12	50	3	\$416	\$658	\$884
RE-LSQ4-1252-?	12	52	3	\$417	\$659	\$892
RE-LSQ4-1254-?	12	54	3	\$420	\$663	\$903
RE-LSQ4-1256-?	12	56	3	\$421	\$666	\$912
RE-LSQ4-1258-?	12	58	3	\$423	\$667	\$921
RE-LSQ4-1260-?	12	60	3	\$425	\$671	\$931
RE-LSQ4-1262-?	12	62	3	\$426	\$674	\$939
RE-LSQ4-1264-?	12	64	3	\$428	\$675	\$949
RE-LSQ4-1266-?	12	66	3	\$430	\$679	\$960
RE-LSQ4-1268-?	12	68	3	\$434	\$686	\$973
RE-LSQ4-1270-?	12	70	3	\$437	\$690	\$984
RE-LSQ4-1272-?	12	72	3	\$440	\$695	\$996
RE-LSQ4-1274-?	12	74	3	\$443	\$700	\$1,007
RE-LSQ4-1276-?	12	76	3	\$447	\$706	\$1,022
RE-LSQ4-1278-?	12	78	3	\$452	\$714	\$1,036
RE-LSQ4-1280-?	12	80	3	\$455	\$718	\$1,047
RE-LSQ4-1282-?	12	82	3	\$458	\$724	\$1,061
RE-LSQ4-1284-?	12	84	3	\$461	\$728	\$1,070
RE-LSQ4-1286-?	12	86	3	\$465	\$735	\$1,084

- Laminate panels are 3/4" thick material with 2mm PVC edgebanding. Grain direction is horizontal.
- Panels are cut exact to size.
- Clips and mounting hardware sold separately.

Laminate Panels - Panel Only

3/4" Thick - Rounded Corners

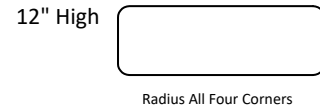

Model Number	Height	Length	Required Number of Clips	TFL (T)	HPL (H)	Whiteboard (W)
RE-LRD4-1218-?	12	18	2	\$310	\$489	\$596
RE-LRD4-1220-?	12	20	2	\$315	\$497	\$611
RE-LRD4-1222-?	12	22	2	\$318	\$501	\$623
RE-LRD4-1224-?	12	24	2	\$321	\$508	\$636
RE-LRD4-1226-?	12	26	2	\$325	\$514	\$648
RE-LRD4-1228-?	12	28	2	\$316	\$500	\$640
RE-LRD4-1230-?	12	30	2	\$332	\$524	\$673
RE-LRD4-1232-?	12	32	2	\$334	\$528	\$683
RE-LRD4-1234-?	12	34	2	\$350	\$553	\$717
RE-LRD4-1236-?	12	36	2	\$351	\$554	\$725
RE-LRD4-1238-?	12	38	2	\$353	\$558	\$736
RE-LRD4-1240-?	12	40	2	\$356	\$562	\$747
RE-LRD4-1242-?	12	42	2	\$357	\$565	\$756
RE-LRD4-1244-?	12	44	2	\$360	\$569	\$767
RE-LRD4-1246-?	12	46	2	\$361	\$570	\$775
RE-LRD4-1248-?	12	48	2	\$364	\$574	\$786
RE-LRD4-1250-?	12	50	3	\$449	\$710	\$942
RE-LRD4-1252-?	12	52	3	\$451	\$712	\$950
RE-LRD4-1254-?	12	54	3	\$453	\$716	\$961
RE-LRD4-1256-?	12	56	3	\$455	\$718	\$969
RE-LRD4-1258-?	12	58	3	\$456	\$720	\$979
RE-LRD4-1260-?	12	60	3	\$460	\$726	\$992
RE-LRD4-1262-?	12	62	3	\$461	\$728	\$999
RE-LRD4-1264-?	12	64	3	\$462	\$731	\$1,010
RE-LRD4-1266-?	12	66	3	\$465	\$735	\$1,020
RE-LRD4-1268-?	12	68	3	\$469	\$740	\$1,032
RE-LRD4-1270-?	12	70	3	\$471	\$744	\$1,043
RE-LRD4-1272-?	12	72	3	\$476	\$752	\$1,058
RE-LRD4-1274-?	12	74	3	\$479	\$756	\$1,069
RE-LRD4-1276-?	12	76	3	\$483	\$763	\$1,084
RE-LRD4-1278-?	12	78	3	\$488	\$771	\$1,098
RE-LRD4-1280-?	12	80	3	\$490	\$775	\$1,109
RE-LRD4-1282-?	12	82	3	\$496	\$783	\$1,125
RE-LRD4-1284-?	12	84	3	\$498	\$787	\$1,136
RE-LRD4-1286-?	12	86	3	\$502	\$793	\$1,147

- Laminate panels are 3/4" thick material with 2mm PVC edgebanding. Grain direction is horizontal.
- Panels are cut exact to size.
- Rounded corners have a 2" radius.
- Clips and mounting hardware sold separately.

Laminate Panels - Panel Only

3/4" Thick - Rounded Corners

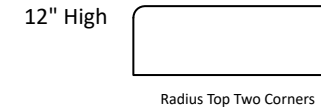

Model Number	Height	Length	Required Number of Clips	TFL (T)	HPL (H)	Whiteboard (W)
RE-LRD2-1218-?	12	18	2	\$310	\$489	\$596
RE-LRD2-1220-?	12	20	2	\$315	\$497	\$611
RE-LRD2-1222-?	12	22	2	\$318	\$501	\$623
RE-LRD2-1224-?	12	24	2	\$321	\$508	\$636
RE-LRD2-1226-?	12	26	2	\$325	\$514	\$648
RE-LRD2-1228-?	12	28	2	\$316	\$500	\$640
RE-LRD2-1230-?	12	30	2	\$332	\$524	\$673
RE-LRD2-1232-?	12	32	2	\$334	\$528	\$683
RE-LRD2-1234-?	12	34	2	\$350	\$553	\$717
RE-LRD2-1236-?	12	36	2	\$351	\$554	\$725
RE-LRD2-1238-?	12	38	2	\$353	\$558	\$736
RE-LRD2-1240-?	12	40	2	\$356	\$562	\$747
RE-LRD2-1242-?	12	42	2	\$357	\$565	\$756
RE-LRD2-1244-?	12	44	2	\$360	\$569	\$767
RE-LRD2-1246-?	12	46	2	\$361	\$570	\$775
RE-LRD2-1248-?	12	48	2	\$364	\$574	\$786
RE-LRD2-1250-?	12	50	3	\$449	\$710	\$942
RE-LRD2-1252-?	12	52	3	\$451	\$712	\$950
RE-LRD2-1254-?	12	54	3	\$453	\$716	\$961
RE-LRD2-1256-?	12	56	3	\$455	\$718	\$969
RE-LRD2-1258-?	12	58	3	\$456	\$720	\$979
RE-LRD2-1260-?	12	60	3	\$460	\$726	\$992
RE-LRD2-1262-?	12	62	3	\$461	\$728	\$999
RE-LRD2-1264-?	12	64	3	\$462	\$731	\$1,010
RE-LRD2-1266-?	12	66	3	\$465	\$735	\$1,020
RE-LRD2-1268-?	12	68	3	\$469	\$740	\$1,032
RE-LRD2-1270-?	12	70	3	\$471	\$744	\$1,043
RE-LRD2-1272-?	12	72	3	\$476	\$752	\$1,058
RE-LRD2-1274-?	12	74	3	\$479	\$756	\$1,069
RE-LRD2-1276-?	12	76	3	\$483	\$763	\$1,084
RE-LRD2-1278-?	12	78	3	\$488	\$771	\$1,098
RE-LRD2-1280-?	12	80	3	\$490	\$775	\$1,109
RE-LRD2-1282-?	12	82	3	\$496	\$783	\$1,125
RE-LRD2-1284-?	12	84	3	\$498	\$787	\$1,136
RE-LRD2-1286-?	12	86	3	\$502	\$793	\$1,147

- Laminate panels are 3/4" thick material with 2mm PVC edgebanding. Grain direction is horizontal.
- Panels are cut exact to size.
- Rounded corners have a 2" radius.
- Clips and mounting hardware sold separately.

Laminate Panels - Panel Only

3/4" Thick - Square Corners

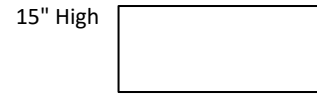

Model Number	Height	Length	Required Number of Clips	TFL (T)	HPL (H)	Whiteboard (W)
RE-LSQ4-1518-?	15	18	2	\$348	\$550	\$678
RE-LSQ4-1520-?	15	20	2	\$355	\$561	\$697
RE-LSQ4-1522-?	15	22	2	\$357	\$565	\$710
RE-LSQ4-1524-?	15	24	2	\$360	\$569	\$722
RE-LSQ4-1526-?	15	26	2	\$364	\$574	\$736
RE-LSQ4-1528-?	15	28	2	\$367	\$581	\$752
RE-LSQ4-1530-?	15	30	2	\$373	\$589	\$768
RE-LSQ4-1532-?	15	32	2	\$375	\$593	\$782
RE-LSQ4-1534-?	15	34	2	\$408	\$646	\$846
RE-LSQ4-1536-?	15	36	2	\$411	\$650	\$860
RE-LSQ4-1538-?	15	38	2	\$412	\$651	\$869
RE-LSQ4-1540-?	15	40	2	\$415	\$655	\$880
RE-LSQ4-1542-?	15	42	2	\$416	\$658	\$892
RE-LSQ4-1544-?	15	44	2	\$419	\$662	\$904
RE-LSQ4-1546-?	15	46	2	\$420	\$663	\$915
RE-LSQ4-1548-?	15	48	2	\$423	\$667	\$927
RE-LSQ4-1550-?	15	50	3	\$517	\$817	\$1,098
RE-LSQ4-1552-?	15	52	3	\$519	\$819	\$1,111
RE-LSQ4-1554-?	15	54	3	\$521	\$824	\$1,123
RE-LSQ4-1556-?	15	56	3	\$522	\$825	\$1,132
RE-LSQ4-1558-?	15	58	3	\$525	\$829	\$1,144
RE-LSQ4-1560-?	15	60	3	\$526	\$832	\$1,156
RE-LSQ4-1562-?	15	62	3	\$529	\$836	\$1,169
RE-LSQ4-1564-?	15	64	3	\$530	\$837	\$1,177
RE-LSQ4-1566-?	15	66	3	\$533	\$841	\$1,190
RE-LSQ4-1568-?	15	68	3	\$534	\$844	\$1,201
RE-LSQ4-1570-?	15	70	3	\$537	\$848	\$1,214
RE-LSQ4-1572-?	15	72	3	\$538	\$849	\$1,224
RE-LSQ4-1574-?	15	74	3	\$540	\$853	\$1,235
RE-LSQ4-1576-?	15	76	3	\$544	\$860	\$1,251
RE-LSQ4-1578-?	15	78	3	\$547	\$864	\$1,263
RE-LSQ4-1580-?	15	80	3	\$549	\$868	\$1,276
RE-LSQ4-1582-?	15	82	3	\$554	\$876	\$1,293
RE-LSQ4-1584-?	15	84	3	\$558	\$881	\$1,307
RE-LSQ4-1586-?	15	86	3	\$561	\$886	\$1,320

- Laminate panels are 3/4" thick material with 2mm PVC edgebanding. Grain direction is horizontal.
- Panels are cut exact to size.
- Clips and mounting hardware sold separately.

Laminate Panels - Panel Only

3/4" Thick - Rounded Corners

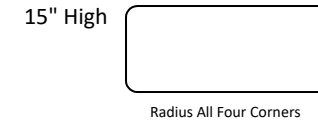

Model Number	Height	Length	Required Number of Clips	TFL (T)	HPL (H)	Whiteboard (W)
RE-LRD4-1518-?	15	18	2	\$376	\$594	\$726
RE-LRD4-1520-?	15	20	2	\$383	\$605	\$745
RE-LRD4-1522-?	15	22	2	\$385	\$609	\$759
RE-LRD4-1524-?	15	24	2	\$388	\$613	\$771
RE-LRD4-1526-?	15	26	2	\$393	\$621	\$787
RE-LRD4-1528-?	15	28	2	\$397	\$627	\$802
RE-LRD4-1530-?	15	30	2	\$402	\$635	\$818
RE-LRD4-1532-?	15	32	2	\$405	\$639	\$832
RE-LRD4-1534-?	15	34	2	\$442	\$698	\$904
RE-LRD4-1536-?	15	36	2	\$444	\$702	\$918
RE-LRD4-1538-?	15	38	2	\$446	\$704	\$927
RE-LRD4-1540-?	15	40	2	\$448	\$708	\$938
RE-LRD4-1542-?	15	42	2	\$449	\$710	\$950
RE-LRD4-1544-?	15	44	2	\$452	\$714	\$962
RE-LRD4-1546-?	15	46	2	\$453	\$716	\$973
RE-LRD4-1548-?	15	48	2	\$456	\$720	\$984
RE-LRD4-1550-?	15	50	3	\$558	\$881	\$1,170
RE-LRD4-1552-?	15	52	3	\$560	\$884	\$1,182
RE-LRD4-1554-?	15	54	3	\$563	\$890	\$1,196
RE-LRD4-1556-?	15	56	3	\$565	\$892	\$1,206
RE-LRD4-1558-?	15	58	3	\$567	\$896	\$1,218
RE-LRD4-1560-?	15	60	3	\$569	\$898	\$1,229
RE-LRD4-1562-?	15	62	3	\$571	\$902	\$1,241
RE-LRD4-1564-?	15	64	3	\$572	\$904	\$1,251
RE-LRD4-1566-?	15	66	3	\$575	\$908	\$1,264
RE-LRD4-1568-?	15	68	3	\$576	\$910	\$1,274
RE-LRD4-1570-?	15	70	3	\$580	\$917	\$1,290
RE-LRD4-1572-?	15	72	3	\$581	\$918	\$1,299
RE-LRD4-1574-?	15	74	3	\$584	\$922	\$1,310
RE-LRD4-1576-?	15	76	3	\$588	\$929	\$1,328
RE-LRD4-1578-?	15	78	3	\$590	\$933	\$1,338
RE-LRD4-1580-?	15	80	3	\$593	\$937	\$1,352
RE-LRD4-1582-?	15	82	3	\$599	\$946	\$1,369
RE-LRD4-1584-?	15	84	3	\$603	\$953	\$1,387
RE-LRD4-1586-?	15	86	3	\$606	\$957	\$1,398

- Laminate panels are 3/4" thick material with 2mm PVC edgebanding. Grain direction is horizontal.
- Panels are cut exact to size.
- Rounded corners have a 2" radius.
- Clips and mounting hardware sold separately.

Laminate Panels - Panel Only

3/4" Thick - Rounded Corners

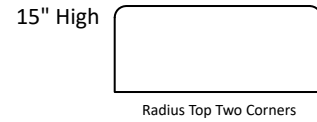

Model Number	Height	Length	Required Number of Clips	TFL (T)	HPL (H)	Whiteboard (W)
RE-LRD2-1518-?	15	18	2	\$376	\$594	\$726
RE-LRD2-1520-?	15	20	2	\$383	\$605	\$745
RE-LRD2-1522-?	15	22	2	\$385	\$609	\$759
RE-LRD2-1524-?	15	24	2	\$388	\$613	\$771
RE-LRD2-1526-?	15	26	2	\$393	\$621	\$787
RE-LRD2-1528-?	15	28	2	\$397	\$627	\$802
RE-LRD2-1530-?	15	30	2	\$402	\$635	\$818
RE-LRD2-1532-?	15	32	2	\$405	\$639	\$832
RE-LRD2-1534-?	15	34	2	\$442	\$698	\$904
RE-LRD2-1536-?	15	36	2	\$444	\$702	\$918
RE-LRD2-1538-?	15	38	2	\$446	\$704	\$927
RE-LRD2-1540-?	15	40	2	\$448	\$708	\$938
RE-LRD2-1542-?	15	42	2	\$449	\$710	\$950
RE-LRD2-1544-?	15	44	2	\$452	\$714	\$962
RE-LRD2-1546-?	15	46	2	\$453	\$716	\$973
RE-LRD2-1548-?	15	48	2	\$456	\$720	\$984
RE-LRD2-1550-?	15	50	3	\$558	\$881	\$1,170
RE-LRD2-1552-?	15	52	3	\$560	\$884	\$1,182
RE-LRD2-1554-?	15	54	3	\$563	\$890	\$1,196
RE-LRD2-1556-?	15	56	3	\$565	\$892	\$1,206
RE-LRD2-1558-?	15	58	3	\$567	\$896	\$1,218
RE-LRD2-1560-?	15	60	3	\$569	\$898	\$1,229
RE-LRD2-1562-?	15	62	3	\$571	\$902	\$1,241
RE-LRD2-1564-?	15	64	3	\$572	\$904	\$1,251
RE-LRD2-1566-?	15	66	3	\$575	\$908	\$1,264
RE-LRD2-1568-?	15	68	3	\$576	\$910	\$1,274
RE-LRD2-1570-?	15	70	3	\$580	\$917	\$1,290
RE-LRD2-1572-?	15	72	3	\$581	\$918	\$1,299
RE-LRD2-1574-?	15	74	3	\$584	\$922	\$1,310
RE-LRD2-1576-?	15	76	3	\$588	\$929	\$1,328
RE-LRD2-1578-?	15	78	3	\$590	\$933	\$1,338
RE-LRD2-1580-?	15	80	3	\$593	\$937	\$1,352
RE-LRD2-1582-?	15	82	3	\$599	\$946	\$1,369
RE-LRD2-1584-?	15	84	3	\$603	\$953	\$1,387
RE-LRD2-1586-?	15	86	3	\$606	\$957	\$1,398

- Laminate panels are 3/4" thick material with 2mm PVC edgebanding. Grain direction is horizontal.
- Panels are cut exact to size.
- Rounded corners have a 2" radius.
- Clips and mounting hardware sold separately.

Laminate Panels - Panel Only

3/4" Thick - Square Corners

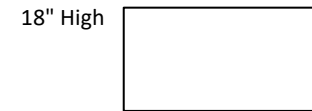

Model Number	Height	Length	Required Number of Clips	TFL (T)	HPL (H)	Whiteboard (W)
RE-LSQ4-1818-?	18	18	2	\$367	\$581	\$726
RE-LSQ4-1820-?	18	20	2	\$374	\$590	\$745
RE-LSQ4-1822-?	18	22	2	\$378	\$597	\$764
RE-LSQ4-1824-?	18	24	2	\$380	\$601	\$776
RE-LSQ4-1826-?	18	26	2	\$385	\$609	\$797
RE-LSQ4-1828-?	18	28	2	\$391	\$617	\$814
RE-LSQ4-1830-?	18	30	2	\$401	\$633	\$842
RE-LSQ4-1832-?	18	32	2	\$410	\$647	\$865
RE-LSQ4-1834-?	18	34	2	\$426	\$674	\$906
RE-LSQ4-1836-?	18	36	2	\$430	\$679	\$921
RE-LSQ4-1838-?	18	38	2	\$433	\$683	\$935
RE-LSQ4-1840-?	18	40	2	\$438	\$691	\$953
RE-LSQ4-1842-?	18	42	2	\$443	\$700	\$973
RE-LSQ4-1844-?	18	44	2	\$447	\$706	\$989
RE-LSQ4-1846-?	18	46	2	\$451	\$712	\$1,005
RE-LSQ4-1848-?	18	48	3	\$453	\$716	\$1,019
RE-LSQ4-1850-?	18	50	3	\$540	\$853	\$1,181
RE-LSQ4-1852-?	18	52	3	\$552	\$872	\$1,210
RE-LSQ4-1854-?	18	54	3	\$553	\$873	\$1,221
RE-LSQ4-1856-?	18	56	3	\$556	\$877	\$1,235
RE-LSQ4-1858-?	18	58	3	\$557	\$880	\$1,248
RE-LSQ4-1860-?	18	60	3	\$560	\$884	\$1,262
RE-LSQ4-1862-?	18	62	3	\$563	\$890	\$1,278
RE-LSQ4-1864-?	18	64	3	\$566	\$894	\$1,291
RE-LSQ4-1866-?	18	66	3	\$574	\$906	\$1,315
RE-LSQ4-1868-?	18	68	3	\$579	\$914	\$1,333
RE-LSQ4-1870-?	18	70	3	\$581	\$918	\$1,348
RE-LSQ4-1872-?	18	72	3	\$585	\$925	\$1,364
RE-LSQ4-1874-?	18	74	3	\$588	\$929	\$1,379
RE-LSQ4-1876-?	18	76	3	\$593	\$937	\$1,396
RE-LSQ4-1878-?	18	78	3	\$597	\$942	\$1,413
RE-LSQ4-1880-?	18	80	3	\$599	\$946	\$1,426
RE-LSQ4-1882-?	18	82	3	\$604	\$954	\$1,446
RE-LSQ4-1884-?	18	84	3	\$607	\$958	\$1,458
RE-LSQ4-1886-?	18	86	3	\$612	\$966	\$1,479

- Laminate panels are 3/4" thick material with 2mm PVC edgebanding. Grain direction is horizontal.
- Panels are cut exact to size.
- Clips and mounting hardware sold separately.

Laminate Panels - Panel Only

3/4" Thick - Rounded Corners

18" High



Radius All Four Corners

Model Number	Height	Length	Required Number of Clips	TFL (T)	HPL (H)	Whiteboard (W)
RE-LRD4-1818-?	18	18	2	\$397	\$627	\$776
RE-LRD4-1820-?	18	20	2	\$403	\$638	\$798
RE-LRD4-1822-?	18	22	2	\$408	\$646	\$817
RE-LRD4-1824-?	18	24	2	\$411	\$650	\$830
RE-LRD4-1826-?	18	26	2	\$416	\$658	\$849
RE-LRD4-1828-?	18	28	2	\$421	\$666	\$868
RE-LRD4-1830-?	18	30	2	\$433	\$683	\$898
RE-LRD4-1832-?	18	32	2	\$443	\$700	\$923
RE-LRD4-1834-?	18	34	2	\$461	\$728	\$965
RE-LRD4-1836-?	18	36	2	\$465	\$735	\$981
RE-LRD4-1838-?	18	38	2	\$467	\$739	\$996
RE-LRD4-1840-?	18	40	2	\$472	\$747	\$1,014
RE-LRD4-1842-?	18	42	2	\$479	\$756	\$1,035
RE-LRD4-1844-?	18	44	2	\$483	\$763	\$1,051
RE-LRD4-1846-?	18	46	2	\$487	\$768	\$1,067
RE-LRD4-1848-?	18	48	3	\$489	\$772	\$1,081
RE-LRD4-1850-?	18	50	3	\$584	\$922	\$1,256
RE-LRD4-1852-?	18	52	3	\$595	\$941	\$1,286
RE-LRD4-1854-?	18	54	3	\$598	\$945	\$1,301
RE-LRD4-1856-?	18	56	3	\$601	\$949	\$1,314
RE-LRD4-1858-?	18	58	3	\$602	\$950	\$1,325
RE-LRD4-1860-?	18	60	3	\$604	\$954	\$1,338
RE-LRD4-1862-?	18	62	3	\$608	\$961	\$1,357
RE-LRD4-1864-?	18	64	3	\$611	\$965	\$1,369
RE-LRD4-1866-?	18	66	3	\$620	\$979	\$1,395
RE-LRD4-1868-?	18	68	3	\$625	\$987	\$1,413
RE-LRD4-1870-?	18	70	3	\$627	\$991	\$1,427
RE-LRD4-1872-?	18	72	3	\$633	\$999	\$1,446
RE-LRD4-1874-?	18	74	3	\$635	\$1,003	\$1,461
RE-LRD4-1876-?	18	76	3	\$640	\$1,011	\$1,479
RE-LRD4-1878-?	18	78	3	\$644	\$1,018	\$1,496
RE-LRD4-1880-?	18	80	3	\$647	\$1,022	\$1,510
RE-LRD4-1882-?	18	82	3	\$653	\$1,031	\$1,530
RE-LRD4-1884-?	18	84	3	\$656	\$1,035	\$1,543
RE-LRD4-1886-?	18	86	3	\$661	\$1,043	\$1,562

- Laminate panels are 3/4" thick material with 2mm PVC edgebanding. Grain direction is horizontal.
- Panels are cut exact to size.
- Rounded corners have a 2" radius.
- Clips and mounting hardware sold separately.

Laminate Panels - Panel Only

3/4" Thick - Rounded Corners

18" High



Radius Top Two Corners

Model Number	Height	Length	Required Number of Clips	TFL (T)	HPL (H)	Whiteboard (W)
RE-LRD2-1818-?	18	18	2	\$397	\$627	\$776
RE-LRD2-1820-?	18	20	2	\$403	\$638	\$798
RE-LRD2-1822-?	18	22	2	\$408	\$646	\$817
RE-LRD2-1824-?	18	24	2	\$411	\$650	\$830
RE-LRD2-1826-?	18	26	2	\$416	\$658	\$849
RE-LRD2-1828-?	18	28	2	\$421	\$666	\$868
RE-LRD2-1830-?	18	30	2	\$433	\$683	\$898
RE-LRD2-1832-?	18	32	2	\$443	\$700	\$923
RE-LRD2-1834-?	18	34	2	\$461	\$728	\$965
RE-LRD2-1836-?	18	36	2	\$465	\$735	\$981
RE-LRD2-1838-?	18	38	2	\$467	\$739	\$996
RE-LRD2-1840-?	18	40	2	\$472	\$747	\$1,014
RE-LRD2-1842-?	18	42	2	\$479	\$756	\$1,035
RE-LRD2-1844-?	18	44	2	\$483	\$763	\$1,051
RE-LRD2-1846-?	18	46	2	\$487	\$768	\$1,067
RE-LRD2-1848-?	18	48	3	\$489	\$772	\$1,081
RE-LRD2-1850-?	18	50	3	\$584	\$922	\$1,256
RE-LRD2-1852-?	18	52	3	\$595	\$941	\$1,286
RE-LRD2-1854-?	18	54	3	\$598	\$945	\$1,301
RE-LRD2-1856-?	18	56	3	\$601	\$949	\$1,314
RE-LRD2-1858-?	18	58	3	\$602	\$950	\$1,325
RE-LRD2-1860-?	18	60	3	\$604	\$954	\$1,338
RE-LRD2-1862-?	18	62	3	\$608	\$961	\$1,357
RE-LRD2-1864-?	18	64	3	\$611	\$965	\$1,369
RE-LRD2-1866-?	18	66	3	\$620	\$979	\$1,395
RE-LRD2-1868-?	18	68	3	\$625	\$987	\$1,413
RE-LRD2-1870-?	18	70	3	\$627	\$991	\$1,427
RE-LRD2-1872-?	18	72	3	\$633	\$999	\$1,446
RE-LRD2-1874-?	18	74	3	\$635	\$1,003	\$1,461
RE-LRD2-1876-?	18	76	3	\$640	\$1,011	\$1,479
RE-LRD2-1878-?	18	78	3	\$644	\$1,018	\$1,496
RE-LRD2-1880-?	18	80	3	\$647	\$1,022	\$1,510
RE-LRD2-1882-?	18	82	3	\$653	\$1,031	\$1,530
RE-LRD2-1884-?	18	84	3	\$656	\$1,035	\$1,543
RE-LRD2-1886-?	18	86	3	\$661	\$1,043	\$1,562

- Laminate panels are 3/4" thick material with 2mm PVC edgebanding. Grain direction is horizontal.
- Panels are cut exact to size.
- Rounded corners have a 2" radius.
- Clips and mounting hardware sold separately.

Laminate Panels - Panel Only

3/4" Thick - Square Corners

24" High



Model Number	Height	Length	Required Number of Clips	TFL (T)	HPL (H)	Whiteboard (W)
RE-LSQ4-2418-?	24	18	2	\$378	\$712	\$899
RE-LSQ4-2420-?	24	20	2	\$403	\$721	\$922
RE-LSQ4-2422-?	24	22	2	\$406	\$729	\$943
RE-LSQ4-2424-?	24	24	2	\$407	\$733	\$961
RE-LSQ4-2426-?	24	26	2	\$448	\$739	\$980
RE-LSQ4-2428-?	24	28	2	\$451	\$743	\$996
RE-LSQ4-2430-?	24	30	2	\$452	\$752	\$1,020
RE-LSQ4-2432-?	24	32	2	\$455	\$760	\$1,042
RE-LSQ4-2434-?	24	34	2	\$534	\$764	\$1,058
RE-LSQ4-2436-?	24	36	2	\$535	\$770	\$1,078
RE-LSQ4-2438-?	24	38	2	\$538	\$774	\$1,096
RE-LSQ4-2440-?	24	40	2	\$539	\$784	\$1,120
RE-LSQ4-2442-?	24	42	2	\$542	\$793	\$1,142
RE-LSQ4-2444-?	24	44	2	\$543	\$797	\$1,159
RE-LSQ4-2446-?	24	46	2	\$545	\$802	\$1,177
RE-LSQ4-2448-?	24	48	3	\$548	\$806	\$1,196
RE-LSQ4-2450-?	24	50	3	\$713	\$969	\$1,388
RE-LSQ4-2452-?	24	52	3	\$714	\$977	\$1,408
RE-LSQ4-2454-?	24	54	3	\$717	\$981	\$1,426
RE-LSQ4-2456-?	24	56	3	\$718	\$989	\$1,449
RE-LSQ4-2458-?	24	58	3	\$721	\$995	\$1,466
RE-LSQ4-2460-?	24	60	3	\$722	\$1,000	\$1,485
RE-LSQ4-2462-?	24	62	3	\$725	\$1,008	\$1,508
RE-LSQ4-2464-?	24	64	3	\$726	\$1,012	\$1,524
RE-LSQ4-2466-?	24	66	3	\$727	\$1,020	\$1,546
RE-LSQ4-2468-?	24	68	3	\$730	\$1,027	\$1,568
RE-LSQ4-2470-?	24	70	3	\$731	\$1,031	\$1,584
RE-LSQ4-2472-?	24	72	4	\$734	\$1,041	\$1,607
RE-LSQ4-2474-?	24	74	4	\$735	\$1,045	\$1,625
RE-LSQ4-2476-?	24	76	4	\$738	\$1,053	\$1,646
RE-LSQ4-2478-?	24	78	4	\$739	\$1,058	\$1,665
RE-LSQ4-2480-?	24	80	4	\$740	\$1,062	\$1,683
RE-LSQ4-2482-?	24	82	4	\$743	\$1,070	\$1,704
RE-LSQ4-2484-?	24	84	4	\$744	\$1,074	\$1,721
RE-LSQ4-2486-?	24	86	4	\$747	\$1,082	\$1,744

- Laminate panels are 3/4" thick material with 2mm PVC edgebanding. Grain direction is horizontal.
- Panels are cut exact to size.
- Clips and mounting hardware sold separately.

Laminate Panels - Panel Only

3/4" Thick - Rounded Corners

24" High



Radius All Four Corners

Model Number	Height	Length	Required Number of Clips	TFL (T)	HPL (H)	Whiteboard (W)
RE-LRD4-2418-?	24	18	2	\$408	\$646	\$826
RE-LRD4-2420-?	24	20	2	\$435	\$687	\$886
RE-LRD4-2422-?	24	22	2	\$438	\$691	\$902
RE-LRD4-2424-?	24	24	2	\$439	\$694	\$918
RE-LRD4-2426-?	24	26	2	\$484	\$764	\$1,008
RE-LRD4-2428-?	24	28	2	\$487	\$768	\$1,024
RE-LRD4-2430-?	24	30	2	\$488	\$771	\$1,041
RE-LRD4-2432-?	24	32	2	\$490	\$775	\$1,058
RE-LRD4-2434-?	24	34	2	\$576	\$910	\$1,218
RE-LRD4-2436-?	24	36	2	\$577	\$912	\$1,235
RE-LRD4-2438-?	24	38	2	\$581	\$918	\$1,255
RE-LRD4-2440-?	24	40	2	\$583	\$921	\$1,270
RE-LRD4-2442-?	24	42	2	\$585	\$925	\$1,287
RE-LRD4-2444-?	24	44	2	\$586	\$926	\$1,302
RE-LRD4-2446-?	24	46	2	\$589	\$930	\$1,318
RE-LRD4-2448-?	24	48	3	\$592	\$934	\$1,336
RE-LRD4-2450-?	24	50	3	\$771	\$1,217	\$1,661
RE-LRD4-2452-?	24	52	3	\$772	\$1,220	\$1,675
RE-LRD4-2454-?	24	54	3	\$775	\$1,224	\$1,693
RE-LRD4-2456-?	24	56	3	\$776	\$1,225	\$1,708
RE-LRD4-2458-?	24	58	3	\$779	\$1,229	\$1,724
RE-LRD4-2460-?	24	60	3	\$780	\$1,232	\$1,740
RE-LRD4-2462-?	24	62	3	\$782	\$1,236	\$1,759
RE-LRD4-2464-?	24	64	3	\$784	\$1,237	\$1,772
RE-LRD4-2466-?	24	66	3	\$785	\$1,240	\$1,789
RE-LRD4-2468-?	24	68	3	\$789	\$1,245	\$1,807
RE-LRD4-2470-?	24	70	3	\$790	\$1,248	\$1,822
RE-LRD4-2472-?	24	72	4	\$793	\$1,252	\$1,840
RE-LRD4-2474-?	24	74	4	\$794	\$1,253	\$1,855
RE-LRD4-2476-?	24	76	4	\$796	\$1,258	\$1,871
RE-LRD4-2478-?	24	78	4	\$798	\$1,260	\$1,887
RE-LRD4-2480-?	24	80	4	\$799	\$1,262	\$1,902
RE-LRD4-2482-?	24	82	4	\$802	\$1,266	\$1,918
RE-LRD4-2484-?	24	84	4	\$803	\$1,268	\$1,935
RE-LRD4-2486-?	24	86	4	\$807	\$1,274	\$1,954

- Laminate panels are 3/4" thick material with 2mm PVC edgebanding. Grain direction is horizontal.
- Panels are cut exact to size.
- Rounded corners have a 2" radius.
- Clips and mounting hardware sold separately.

Laminate Panels - Panel Only

3/4" Thick - Rounded Corners

24" High



Radius Top Two Corners

Model Number	Height	Length	Required Number of Clips	TFL (T)	HPL (H)	Whiteboard (W)
RE-LRD2-2418-?	24	18	2	\$408	\$646	\$826
RE-LRD2-2420-?	24	20	2	\$435	\$687	\$886
RE-LRD2-2422-?	24	22	2	\$438	\$691	\$902
RE-LRD2-2424-?	24	24	2	\$439	\$694	\$918
RE-LRD2-2426-?	24	26	2	\$484	\$764	\$1,008
RE-LRD2-2428-?	24	28	2	\$487	\$768	\$1,024
RE-LRD2-2430-?	24	30	2	\$488	\$771	\$1,041
RE-LRD2-2432-?	24	32	2	\$490	\$775	\$1,058
RE-LRD2-2434-?	24	34	2	\$576	\$910	\$1,218
RE-LRD2-2436-?	24	36	2	\$577	\$912	\$1,235
RE-LRD2-2438-?	24	38	2	\$581	\$918	\$1,255
RE-LRD2-2440-?	24	40	2	\$583	\$921	\$1,270
RE-LRD2-2442-?	24	42	2	\$585	\$925	\$1,287
RE-LRD2-2444-?	24	44	2	\$586	\$926	\$1,302
RE-LRD2-2446-?	24	46	2	\$589	\$930	\$1,318
RE-LRD2-2448-?	24	48	3	\$592	\$934	\$1,336
RE-LRD2-2450-?	24	50	3	\$771	\$1,217	\$1,661
RE-LRD2-2452-?	24	52	3	\$772	\$1,220	\$1,675
RE-LRD2-2454-?	24	54	3	\$775	\$1,224	\$1,693
RE-LRD2-2456-?	24	56	3	\$776	\$1,225	\$1,708
RE-LRD2-2458-?	24	58	3	\$779	\$1,229	\$1,724
RE-LRD2-2460-?	24	60	3	\$780	\$1,232	\$1,740
RE-LRD2-2462-?	24	62	3	\$782	\$1,236	\$1,759
RE-LRD2-2464-?	24	64	3	\$784	\$1,237	\$1,772
RE-LRD2-2466-?	24	66	3	\$785	\$1,240	\$1,789
RE-LRD2-2468-?	24	68	3	\$789	\$1,245	\$1,807
RE-LRD2-2470-?	24	70	3	\$790	\$1,248	\$1,822
RE-LRD2-2472-?	24	72	4	\$793	\$1,252	\$1,840
RE-LRD2-2474-?	24	74	4	\$794	\$1,253	\$1,855
RE-LRD2-2476-?	24	76	4	\$796	\$1,258	\$1,871
RE-LRD2-2478-?	24	78	4	\$798	\$1,260	\$1,887
RE-LRD2-2480-?	24	80	4	\$799	\$1,262	\$1,902
RE-LRD2-2482-?	24	82	4	\$802	\$1,266	\$1,918
RE-LRD2-2484-?	24	84	4	\$803	\$1,268	\$1,935
RE-LRD2-2486-?	24	86	4	\$807	\$1,274	\$1,954

- Laminate panels are 3/4" thick material with 2mm PVC edgebanding. Grain direction is horizontal.
- Panels are cut exact to size.
- Rounded corners have a 2" radius.
- Clips and mounting hardware sold separately.



Please visit [Deskmakers.com](https://deskmakers.com) to view our current **Terms and Conditions**.

Please visit [Deskmakers.com](https://deskmakers.com) to view our current **Warranty**.

Showroom Locations

Los Angeles

DeskMakers Headquarters
6525 Flotilla Street
Commerce, CA 90040

DeskMakers

Phone: 323.264.2260 | Fax: 323.725.6960
www.deskmakers.com